



Bermondsey Square, SE1

£450,000

A highly attractive third floor apartment, with fantastic skyline views, a spacious open plan living space and kitchen, a private balcony, a generous double bedroom and ample storage. Benefitting from a 24 hour concierge and sold chain free. OIEO £450,000

Bermondsey Square is enviably located 0.5 miles from London Bridge station and 0.6 miles to Bermondsey station. Bermondsey Street, Maltby Street and a wide range of shops, cafés and restaurants are moments away.

Features

- Attractive Views
- Private Balcony
- Open Plan Living Space
- 24 hour Concierge
- Bicycle Storage
- Chain Free Sale
- Valid EWS1 Form
- OIEO £450,000

Bermondsey Square, London, SE1

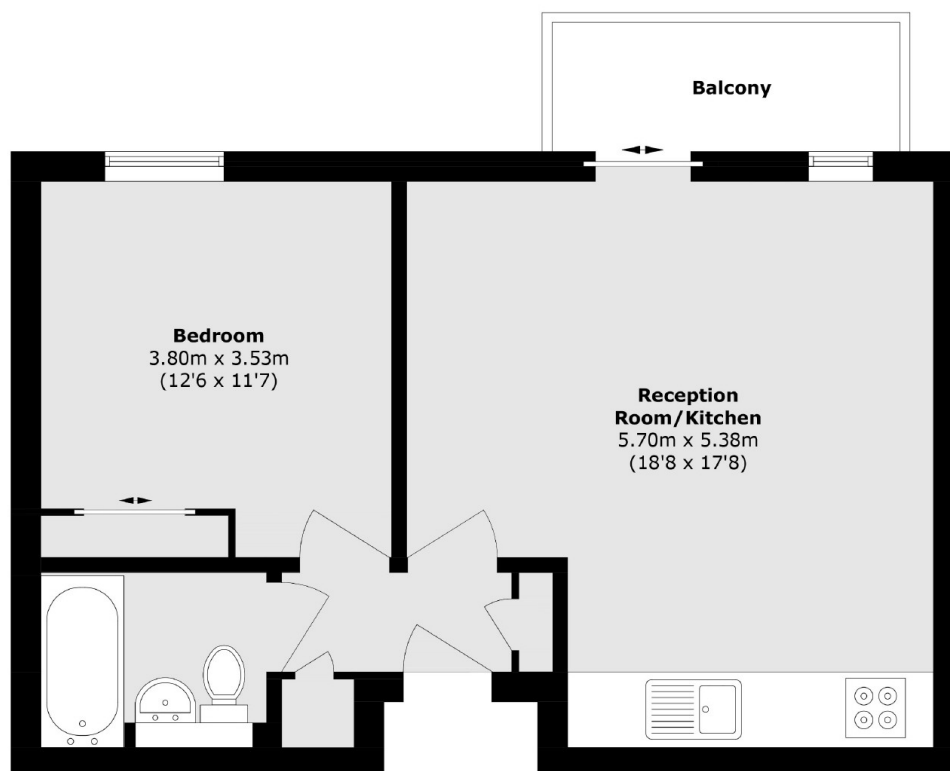

Total area (approx.): 49.5 sq. m (532.8 sq. ft)

Balcony area (approx.): 4.5 sq. m (48.4 sq. ft)