



Bath Terrace, SE1

£385,000

A highly desirable Victorian Mansion flat, with attractive views over the neighbouring park, a separate kitchen & living room, a generous double bedroom and three piece bathroom, high ceilings & sash windows. Offers in excess of £385,000.

Bath Terrace is under 0.5 miles from Borough underground & Borough High Street & 0.25 miles from Elephant & Castle, next to Newington Gardens. Mercato Metropolitano is just around the corner, with many other amenities nearby.

Features

- Victorian Mansion Block
- Private Freeholder
- Separate Kitchen & Living Room
- Park-side location
- Attractive Outlook
- Very Long Lease
- OIEO £385,000

Bath Terrace, London, SE1

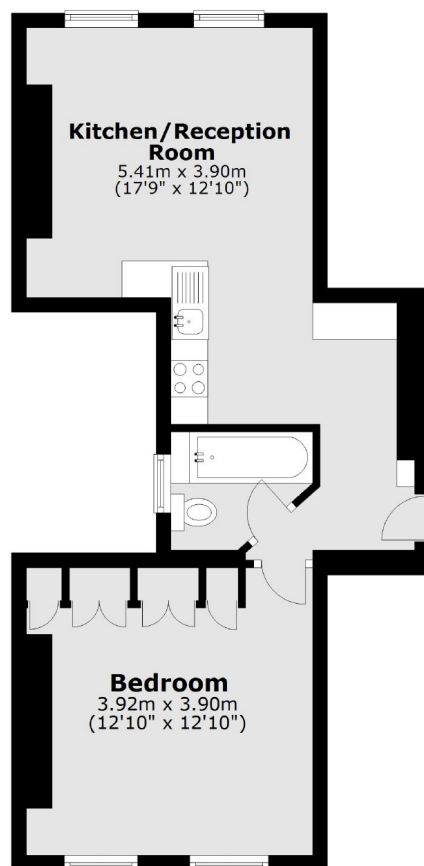

Total area: approx. 41.6 sq. metres (447.9 sq. feet)