



Staple Street, SE1

£350,000

An attractive ground floor flat, requiring refurbishment, with a separate kitchen and a spacious living room, two generous double bedrooms, bathroom and WC. This is a chain free sale with permit parking available.

Staple Street a very quiet side street, enviably located in the heart of SE1, beside Tabard Gardens. There are numerous amenities in the vicinity within easy reach of Borough Market & the South Bank, via Borough High Street. Both London Bridge & Borough stations are close by.

Features

- Two Double Bedrooms
- Quiet Side Street
- Original Floor Boards
- Permit Parking
- Chain Free Sale
- Offers in excess of £350,000

Staple Street,
London, SE1

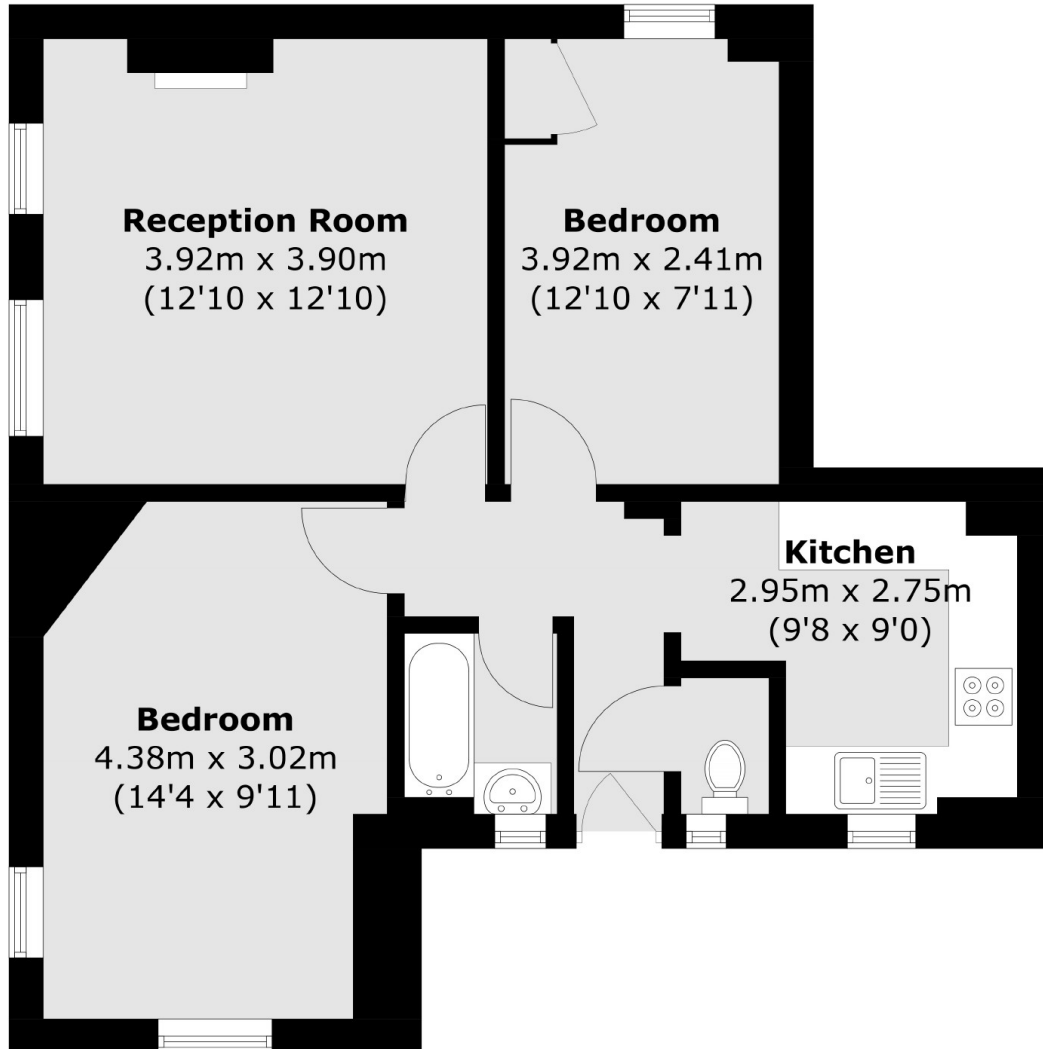

Total area (approx.): 55.3 sq. m (595.2 sq. ft)

Dexters

London Bridge
54 Borough High Street
London
SE1 1XL
Sales
020 7650 5 100

Energy Rating: . We aim to make our particulars both accurate and reliable. However they are not guaranteed; nor do they form part of an offer or contract. If you require clarification on any points then please contact us, especially if you're traveling some distance to view. Please note that appliances and heating systems have not been tested and therefore no warranties can be given as to their good working order.

 **RICS** | Regulated
Estate Agent
and Letting Agent

[dexters.co.uk](https://www.dexters.co.uk)