



Manor Estate, SE16

£450,000

Situated on a quiet leafy street, this four bedroom split level flat is immaculately presented and boasts a large living space, modern kitchen and bathroom, ample storage, parking and private garden.

Holford House is located 0.3 miles from South Bermondsey station and 0.7 miles from Bermondsey station offering excellent transport links to all of London. A wide range of shops, cafés and restaurants are close by.

Features

- Four Bedrooms
- Private Garden
- Split Level
- Excellent Condition
- Parking
- No Chain

Manor Estate, London, SE16

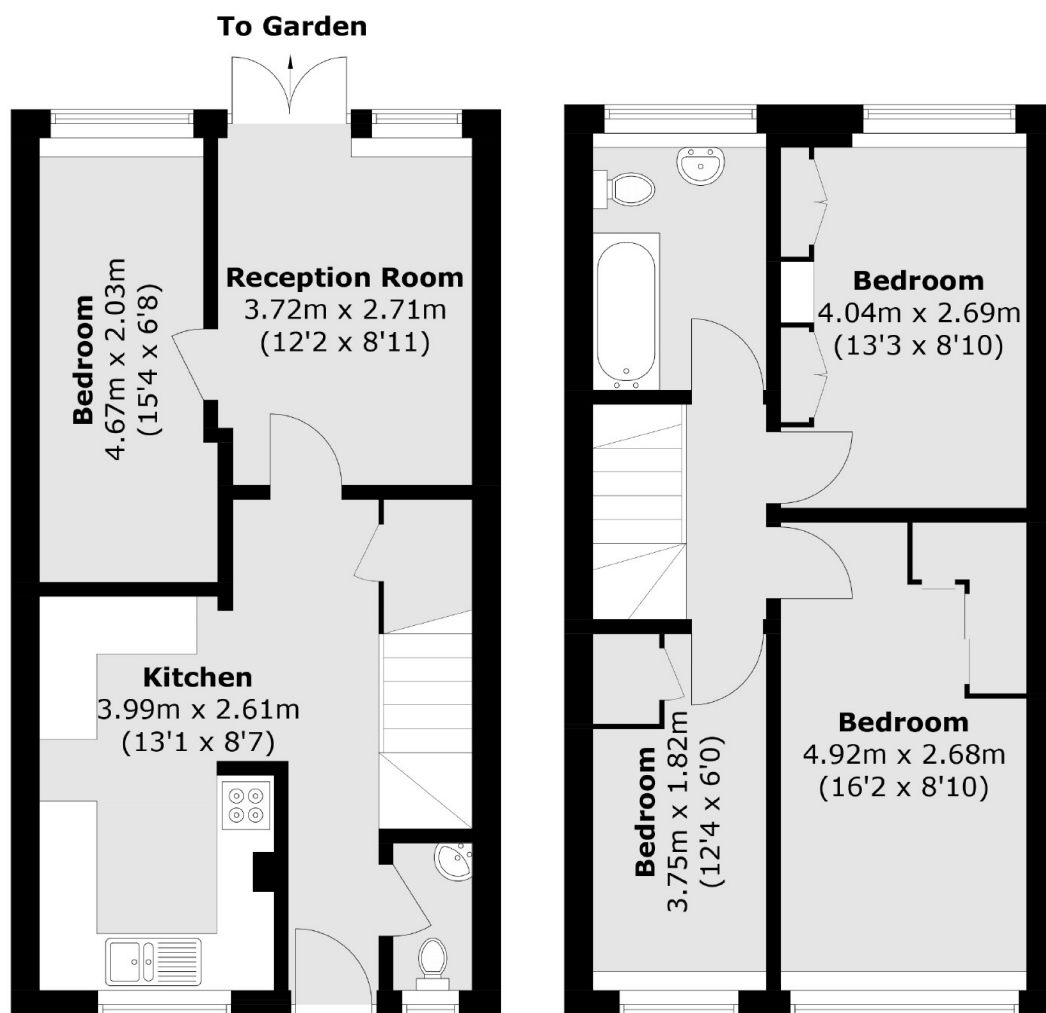

Ground Floor

First Floor

Total area (approx.): 82.0 sq. m (882.6 sq. ft)