



## Shad Thames, SE1

£625,000

Located in the heart of Shad Thames, this immaculately presented two double bedroom warehouse apartment boasts stunning period features, exposed brick work, ample living space, lots of storage, two private balconies overlooking the historic St. Saviours Dock.

Dockhead Wharf is enviably located, with a plethora of riverside restaurants, independent cafés, and artisan delis on your doorstep, along with Tower Bridge, the City, Borough Market, Bermondsey Street, and Maltby Street Market.

### Features

- Views Of The River
- Two Private Balconies
- Secure Allocated Parking
- Day Concierge Facilities
- Chain Free
- Porter Facilities

Shad Thames,  
London, SE1

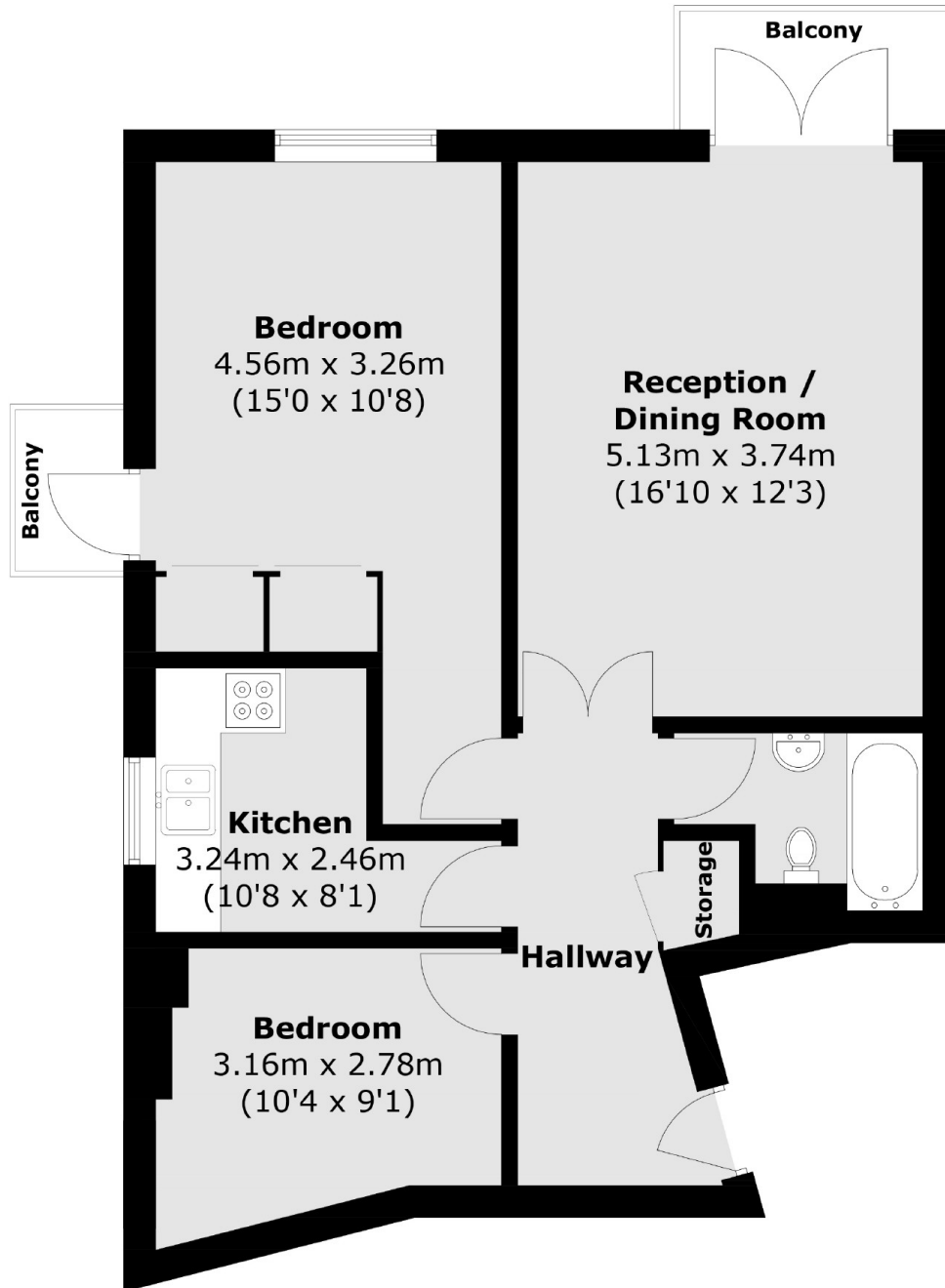

Total area (approx.): 63.4 sq. m (682.4 sq. ft)  
Balcony: 4.2 sq. m (45.2 sq. ft)