



Blackwall Way, E14

£450 Per week

A large one bedroom apartment on the nineteenth floor of this popular development. This bright apartment has wooden flooring, a private balcony with river views and a residents gym.

Elektron Tower is a modern development within walking distance of the shops, bars and restaurants of Canning Town and Canary Wharf.

Features

- One Bedroom
- One Bathroom
- Nineteenth Floor
- Floor To Ceiling Windows
- River Views
- Concierge

Blackwall Way, London, E14

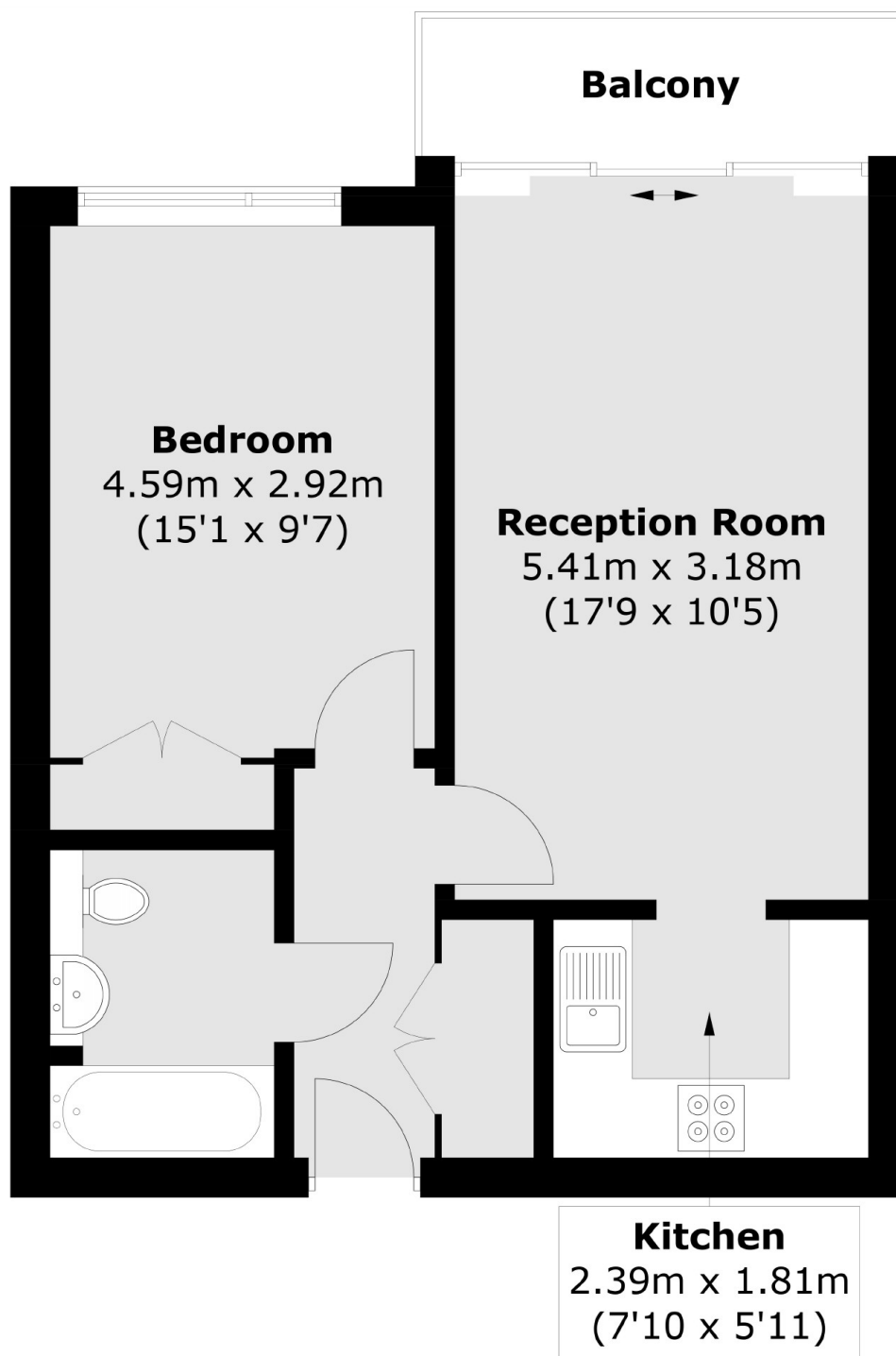

Total area (approx.): 45.1 sq. m (485.4 sq. ft)
Balcony: 3.8 sq. m (40.9 sq. ft)