



Fairmont Avenue, E14

£519 Per week

One bedroom apartment in Ontario Tower, with direct river and city views. Floor to ceiling windows throughout. 24 hour concierge and onsite gym and spa facilities.

Ontario Tower is conveniently located with easy access to Blackwall DLR station meaning excellent transport links to Canary Wharf and the City.

Features

- 6th Floor
- River Views
- Wooden floors throughout
- Fully Furnished
- Gym And Spa
- 24 Concierge

Fairmont Avenue, London, E14

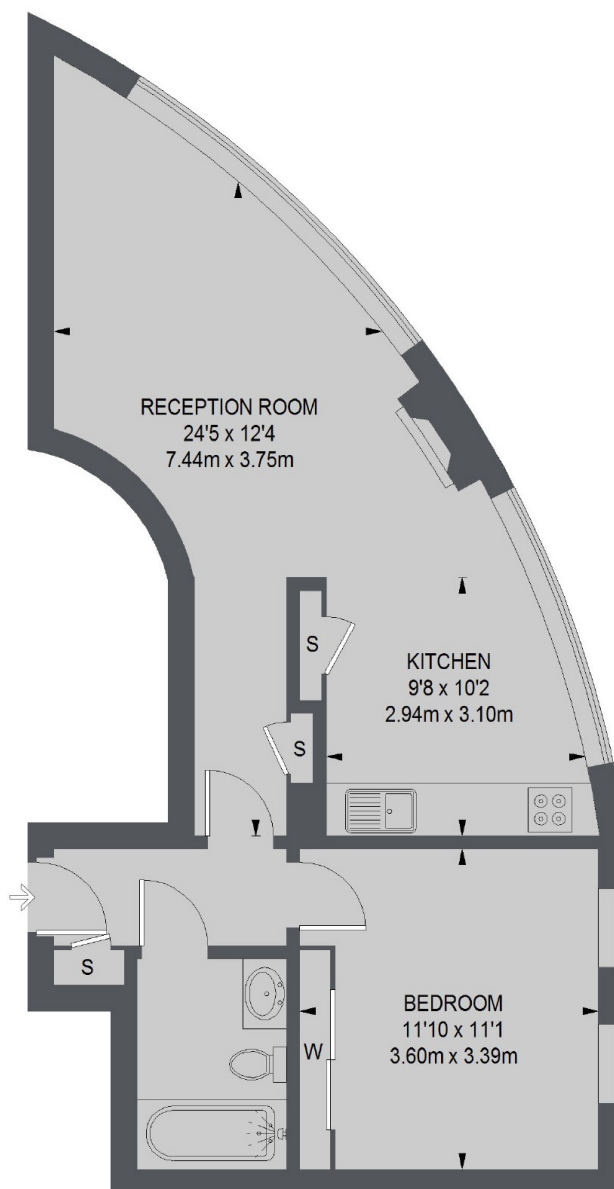

TOTAL APPROX. FLOOR AREA 560 SQ. FT. (52.01 SQ. M.)

Dexters

Canary Wharf
39 Westferry Road
London
E14 8JH
Lettings
0207 517 1190

Energy Rating: B. We aim to make our particulars both accurate and reliable. However they are not guaranteed; nor do they form part of an offer or contract. If you require clarification on any points then please contact us, especially if you're traveling some distance to view. Please note that appliances and heating systems have not been tested and therefore no warranties can be given as to their good working order.

 **RICS** | Regulated
Estate Agent
and Letting Agent

dexters.co.uk