



Taeping Street, E14

£623 Per week

Located in a quiet cul-de-sac, this mid-terrace house has three bedrooms, a separate kitchen and a private garden.

Taeping Street is within easy reach of Mudchute DLR and walking distance to the Greenwich foot tunnel.

Features

- Three Bedrooms
- One Single Bedroom
- Separate Kitchen
- Guest W/C
- Private Garden
- Parking

Taeping Street,
London, E14

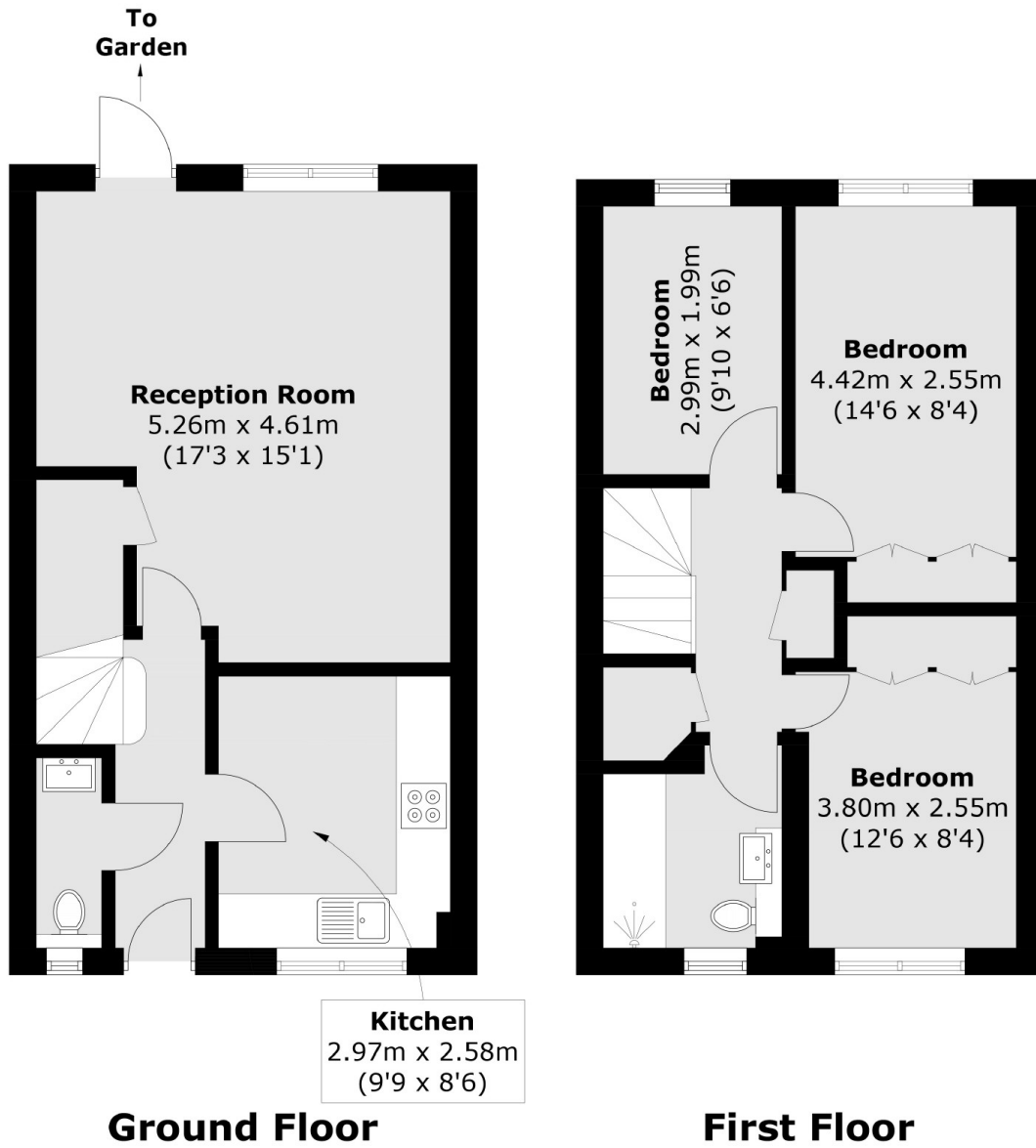

Total area (approx.): 77.2 sq. m (830.9 sq. ft)