



Tennis Street, SE1

£550,000

A highly attractive top floor flat with a very spacious open plan living space, leading out onto a private south west-facing balcony, with ample room for a dining table and a separate seating area, two double bedrooms and a family bathroom. Permit parking is available.

Tennis Street is enviably located in the heart of SE1, moments from Borough High Street, Borough Market and the South Bank, as well as Bermondsey Street and London Bridge Station.

Features

- Top Floor Flat
- Two Double Bedrooms
- Open Plan Living Space
- Private Balcony
- Permit Parking
- Chain Free Sale

Tennis Street,
London, SE1

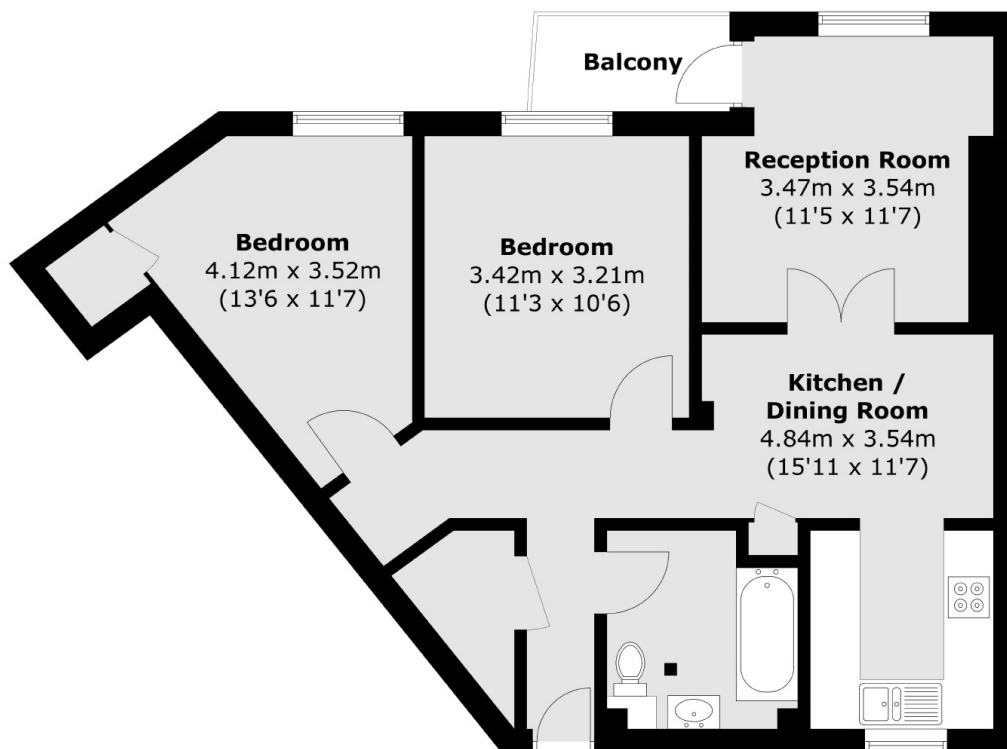

Total area (approx.): 66.0 sq. m (710.4 sq. ft)
Balcony (approx.): 2.7 sq. m (29.1 sq. ft)