



St. Davids Square, E14

£530 Per week

A two bedroom apartment on the ground floor of this popular residential development. This bright apartment has a open plan living room, wooden flooring and a large private terrace.

St. Davids Square is a private development moments from the The Docklands Sailing Centre and the amenities of Canary Wharf.

Features

- Two Bedrooms
- Two Bathrooms
- Large Terrace
- Parking
- Concierge
- Swimming Pool & Gym

St. Davids Square, London, E14

First Floor

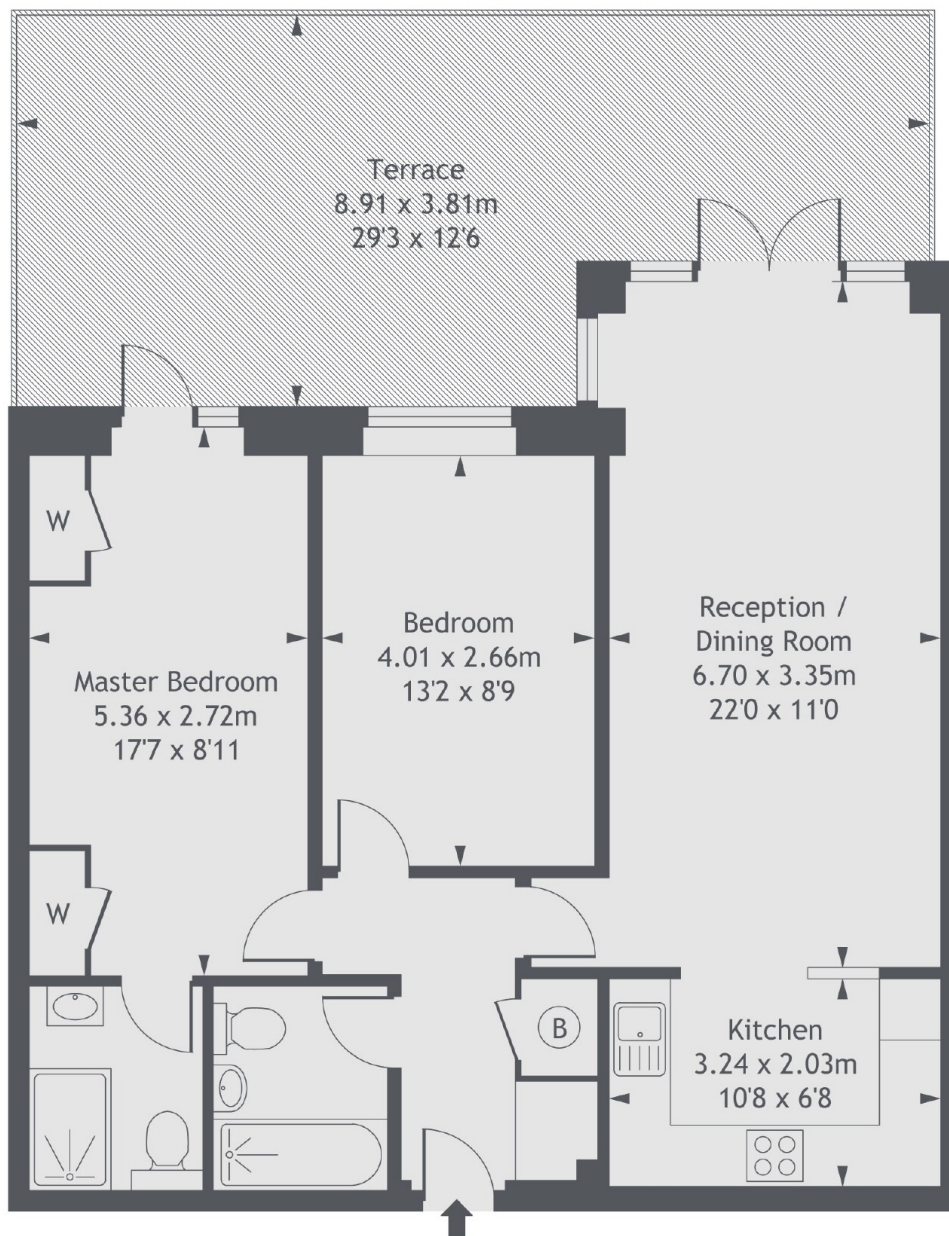

Gross Internal Area 747 sq ft (69.41 sq m)
Terrace Area 314 sq ft (29.15 sq m)