



Milton Close, SE1

£300,000

An attractive ground floor flat with a separate fully fitted kitchen, a spacious living room, ample storage, a three piece bathroom and a generous double bedroom, plus off-street parking. This is a chain free sale.

Milton Close is a quiet residential close, tucked back off Lynton Road, with numerous local amenities nearby. Bermondsey Underground and South Bermondsey Station are both less than a mile away, with excellent bus links too.

Features

- One Bedroom
- Ground Floor
- Separate Kitchen & Living Room
- Ample Storage
- Off-Street Parking
- Chain Free

Milton Close, London, SE1

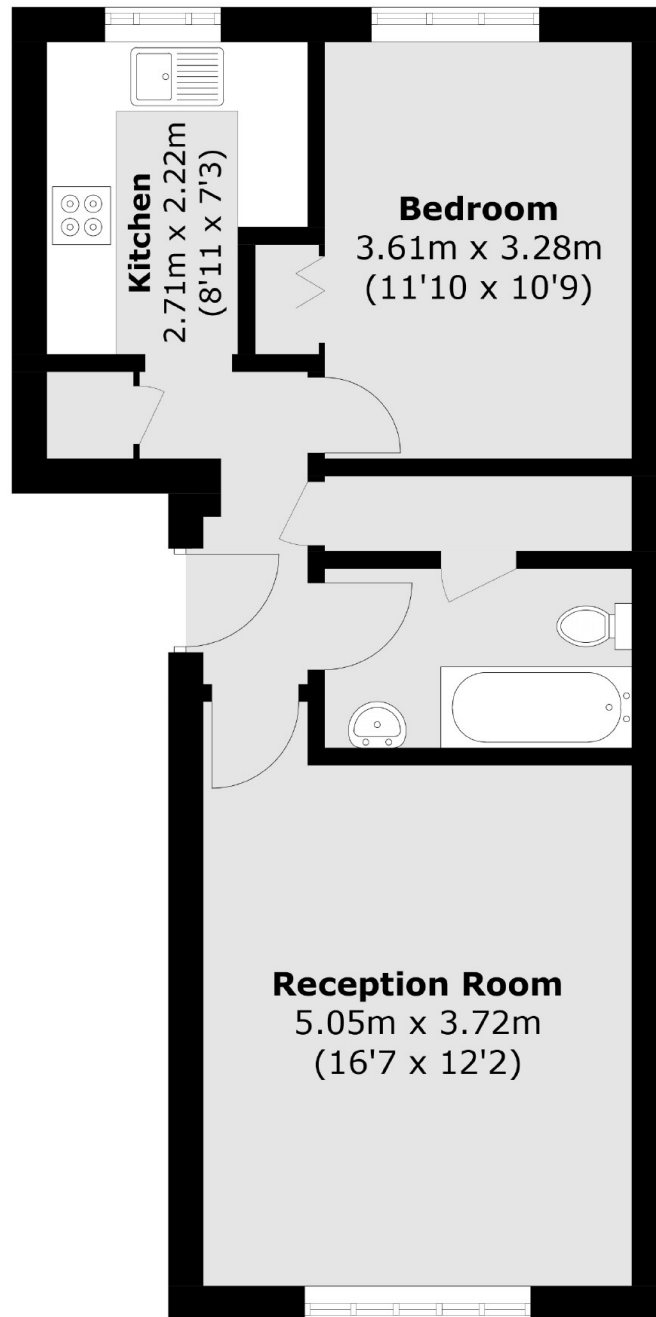

Total area (approx.): 44.8 sq. m (482.2 sq. ft)