

## Violet Road, E3

£392 Per week

A large one bedroom apartment on the ground floor of this purpose built development. This apartment has an open plan reception area, ample storage and private garden.

Violet Road is within easy reach of Devons Road DLR. The shops, bars and restaurants of Canary Wharf are also close by.

### Features

- One Bedroom
- Ground Floor
- Wooden Flooring
- Ample Storage
- Private Garden
- Secure Entry

# Violet Road, London, E3

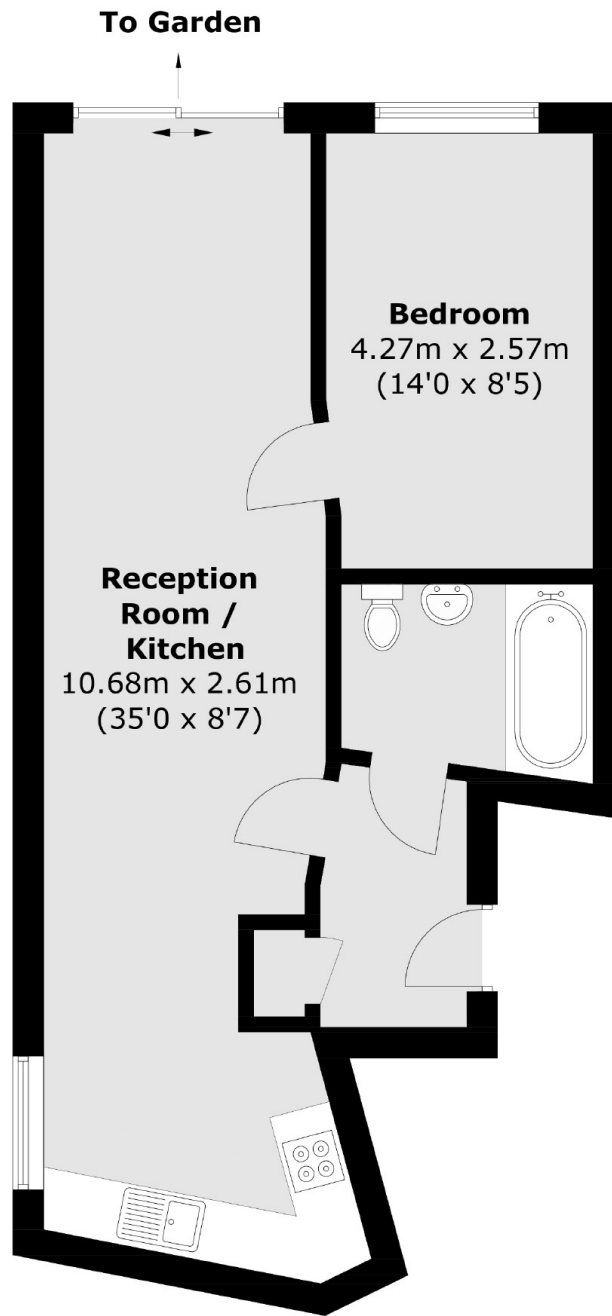

## Ground Floor

Total area (approx.): 50.6 sq. m (544.6 sq. ft)