



## Freda Street, SE16

£600,000

An immaculately presented fourth floor apartment, with incredible skyline views, large open plan kitchen living room, two bedrooms, two bathrooms & a private balcony, plus secure allocated parking.

Parker Building is only 0.2 miles from Bermondsey station. Shad Thames, the Riverside, London Bridge, Bermondsey Street and Maltby Street Market all also within easy reach.

### Features

- Fantastic Views
- Two Double Bedrooms
- Two Bathrooms
- Private Balcony
- Excellent Condition
- Allocated Parking

Freda Street,  
London, SE16

## Fourth Floor

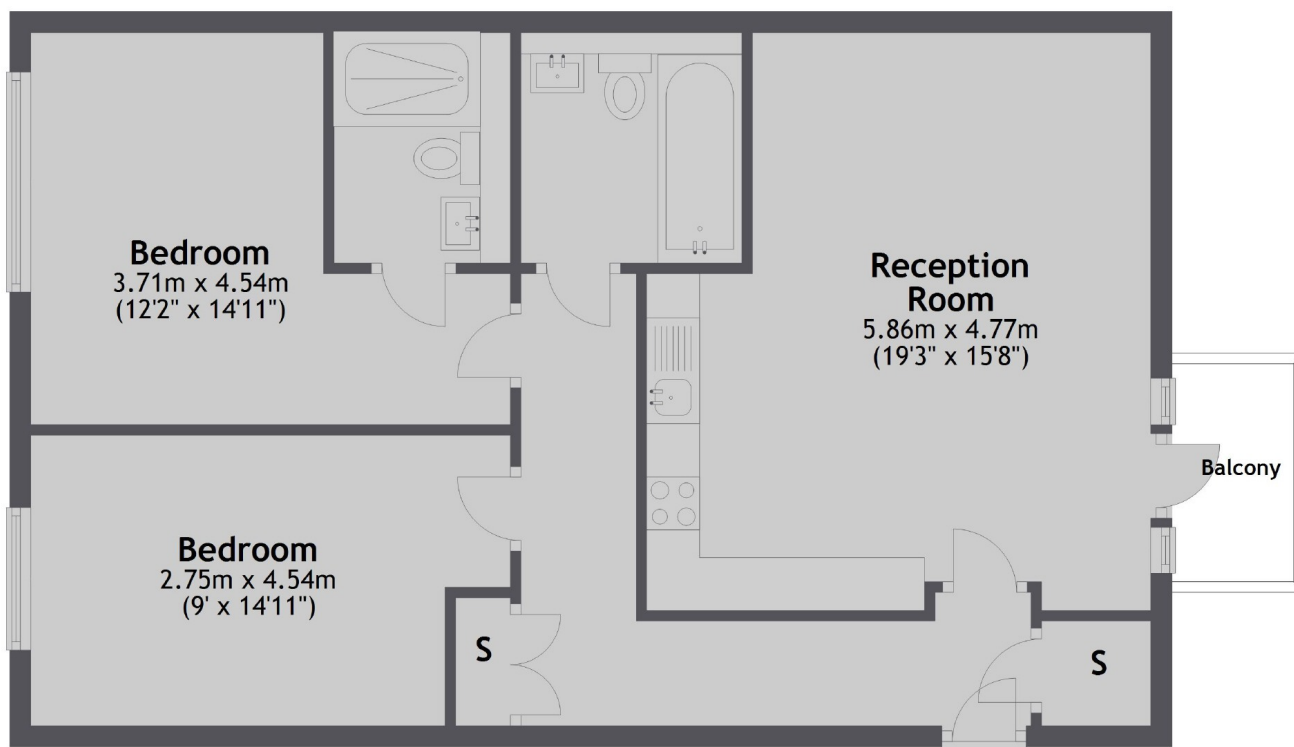

Main area: Approx. 69.5 sq. metres (748.3 sq. feet)  
Plus balconies, approx. 2.9 sq. metres (30.7 sq. feet)