

CARDIFF'S HOME FOR
STYLISH SALES
& LETTINGS

JeffreyRoss



WOODSIDE COURT
LLANISHEN

WOODSIDE COURT

LLANISHEN, CF14 0RY - £895 PCM PCM

2 bedroom(s) 1 bathroom(s) 658.00 sq ft

Jeffrey Ross are pleased to offer this 2 bedroom apartment in the sought after area of Llanishen. Within easy walking distance of Llanishen village and a short commute to Llanishen retail park as well as being a short stroll from Llanishen Train Station. The apartment consists of a bright and airy lounge with a door leading too a fitted kitchen with appliances, family bathroom and 2 good sized double bedrooms. The property also benefits from off-road parking and communal garden areas. Unfurnished.

Council band - D
EPC - C

A holding fee of one weeks' rent will be payable to secure the dwelling. This will be deducted from the final balance payable upon moving into the dwelling, subject to a successful application. Jeffrey Ross Limited reserves the right to retain this payment should the applicant have provided false or misleading information at the time of applying for the dwelling or failed to take reasonable steps to enter into the Standard Occupation Contract.



Energy Efficiency Rating		Current	Potential
Very energy efficient - lower running costs			
(92 plus) A			
(81-91) B			
(69-80) C		76	79
(55-68) D			
(39-54) E			
(21-38) F			
(1-20) G			
Not energy efficient - higher running costs			
England & Wales	EU Directive 2002/91/EC		

Woodside Court, Llanishen

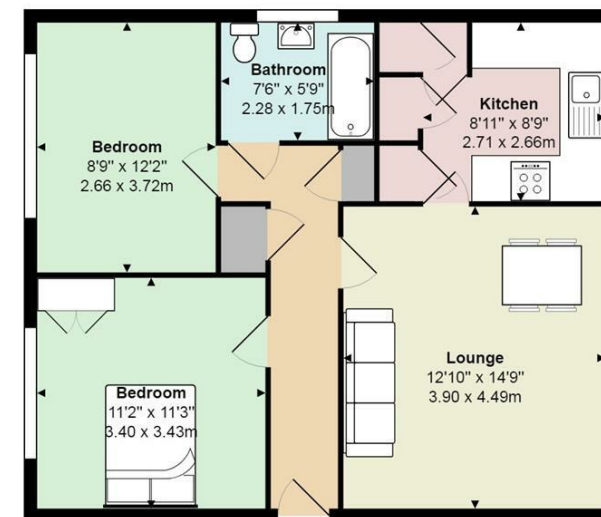

Total Area: 658 ft² ... 61.2 m²

All measurements are approximate and for display purposes only

PROPERTY SPECIALIST

Ms Jodie Price

jodie.price@jeffreycross.co.uk