



FIDLAS ROAD

LLANISHEN





FIDLAS ROAD

LLANISHEN, CF14 ONE - £1,995 PCM



4 bedroom(s)



2 bathroom(s)



sq ft

We are delighted to bring this large 4 bedroom unfurnished property to the market on the ever popular Fidas Road. The ground floor comprises of a long entrance hallway leading to a downstairs W/C and stairs to the first floor. To the left of the hallway you will see a large open plan living room diner area further leading to a large modern kitchen with an island in the centre. Further to the extension at the rear of the house there is an additional dining area which has sliding doors leading to a large garden benefiting with rear access. The first floor of the property benefits from a large master bedroom at the front of the house with en-suite and 2 other large double bedrooms. Also benefits from a very well designed bathroom with separate bath and shower and a small bedroom/study perfect for a home office. This property has a driveway at the front suitable for 1 car comfortably with plenty of street parking nearby. This property makes for the perfect family home.

Council Tax Band: F

EPC Rating: D

A holding fee of one weeks' rent will be payable to secure the dwelling. This will be deducted from the final balance payable upon moving into the dwelling, subject to a successful application. Jeffrey Ross Limited reserves the right to retain this payment should the applicant have provided false or misleading information at the time of applying for the dwelling or failed to take reasonable steps to enter into the Standard Occupation Contract.

PROPERTY SPECIALIST

Miss Sian Griffiths

sian@jeffreypass.co.uk

Lettings





Energy Efficiency Rating		
	Current	Potential
Very energy efficient - lower running costs		
(92 plus) A		
(81-91) B		
(69-80) C		
(55-68) D		
(39-54) E		
(21-38) F		
(1-20) G		
Not energy efficient - higher running costs		
England & Wales	EU Directive 2002/91/EC 	















”

Comments by Miss Sian Griffiths

”

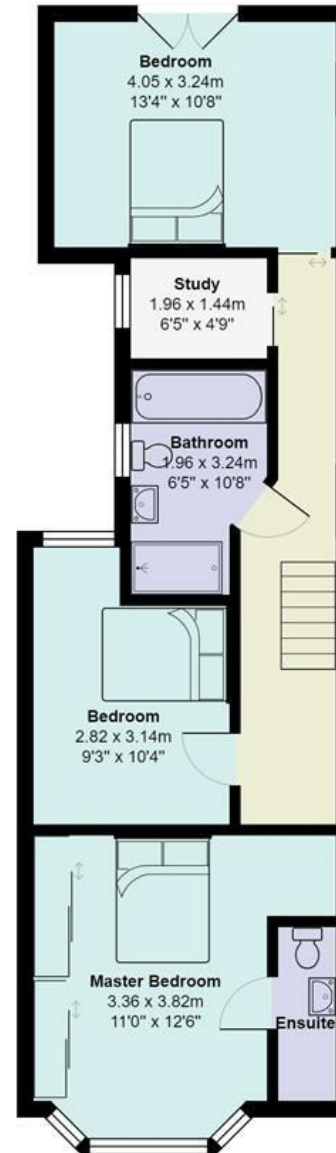

Fidas Road

Total Area: 139.1 m² ... 1497 ft²

All measurements are approximate and for display purposes only

www.jeffreyross.co.uk

Jeffrey Ross