



Churchgate Street, Soham, CB7 5DS

CHEFFINS

Churchgate Street

Soham,
CB7 5DS

Ground floor flat close to the Town centre. Accommodation comprises kitchen/living area, bedroom and a shower room. Electric heating & double glazing. Available 1st July 2025 Minimum 6 month term. Security deposit: £692. Holding deposit £138. Council Tax Band: A. EPC: E

LOCATION

Soham is situated almost equidistant between Ely and Newmarket (6 miles) and is approximately 15 miles from Cambridge. The A.14 trunk road is available at Newmarket and this in turn leads into the M.11 and the main motorway system. Soham has excellent primary and secondary schools and a good selection of shops, together with sporting and social facilities



£600 PCM





Kitchen

with tiled flooring, cooker, extractor hood, plumbing for washing machine, space for under counter fridge

Living Area

Bedroom

with window to front aspect

Shower Room

with WC, basin and cubicle with electric shower. Frosted window to rear aspect.



LETTING AGENTS NOTES

For more information on this property please refer to the Material Information brochure on our Website.

OUTSIDE

Outside there is a communal area with refuse bins allocated to each property. There is access to a communal stairway next door, which houses the pre-payment electricity meter.



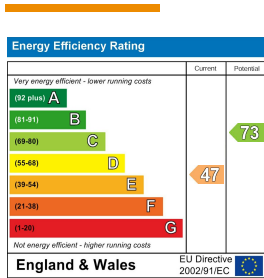

£600 PCM

Council Tax Band - A

Local Authority - East Cambridgeshire District Council

Ground Floor

Approx. 47.3 sq. metres (508.7 sq. feet)

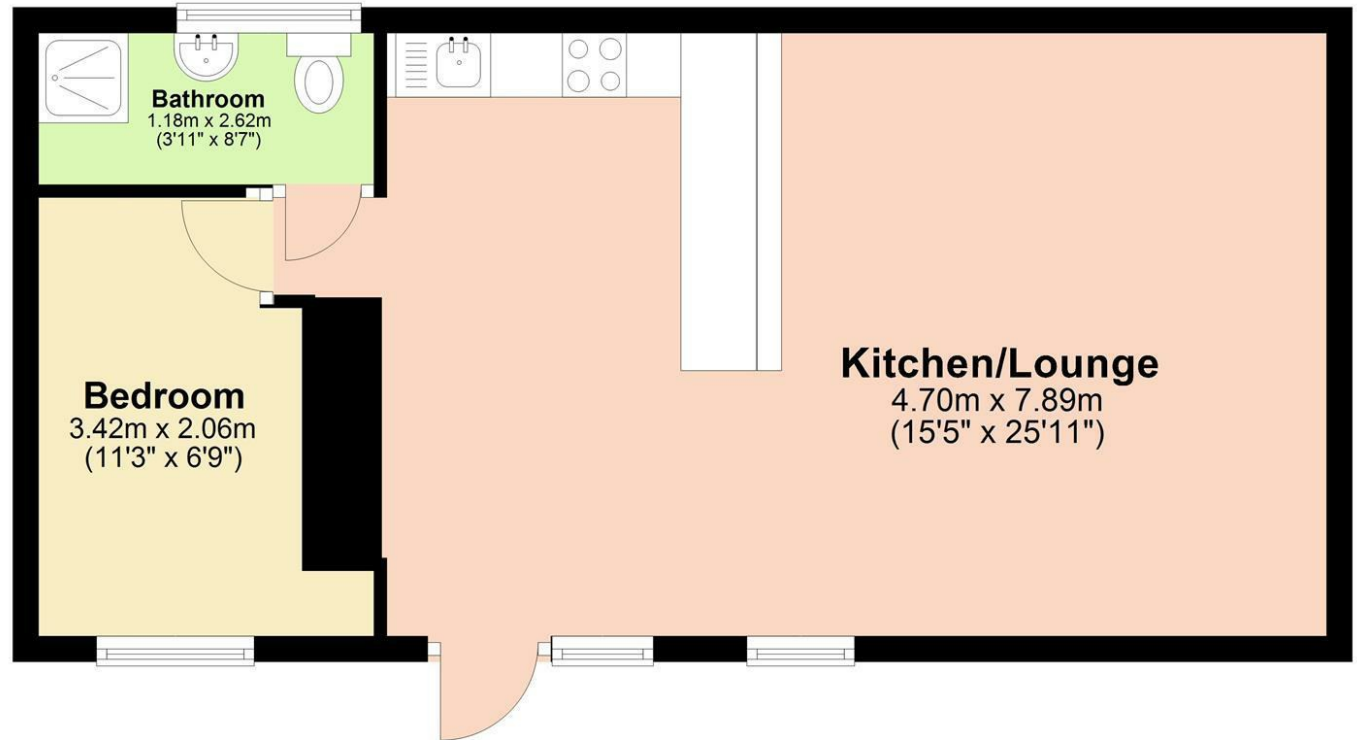

Total area: approx. 47.3 sq. metres (508.7 sq. feet)

Agents note:

[For more information on this property please refer to the Material Information Brochure on our website.](#)

25 Market Place, Ely, Cambridgeshire, CB7 4NP | 01353 663144 | cheffins.co.uk

IMPORTANT: we would like to inform prospective purchasers that these sales particulars have been prepared as a general guide only. A detailed survey has not been carried out, nor the services, appliances and fittings tested. Room sizes should not be relied upon for furnishing purposes and are approximate. If floor plans are included, they are for guidance only and illustration purposes only and may not be to scale. If there are any important matters likely to affect your decision to buy, please contact us before viewing the property.



CHEFFINS