

Ground Floor

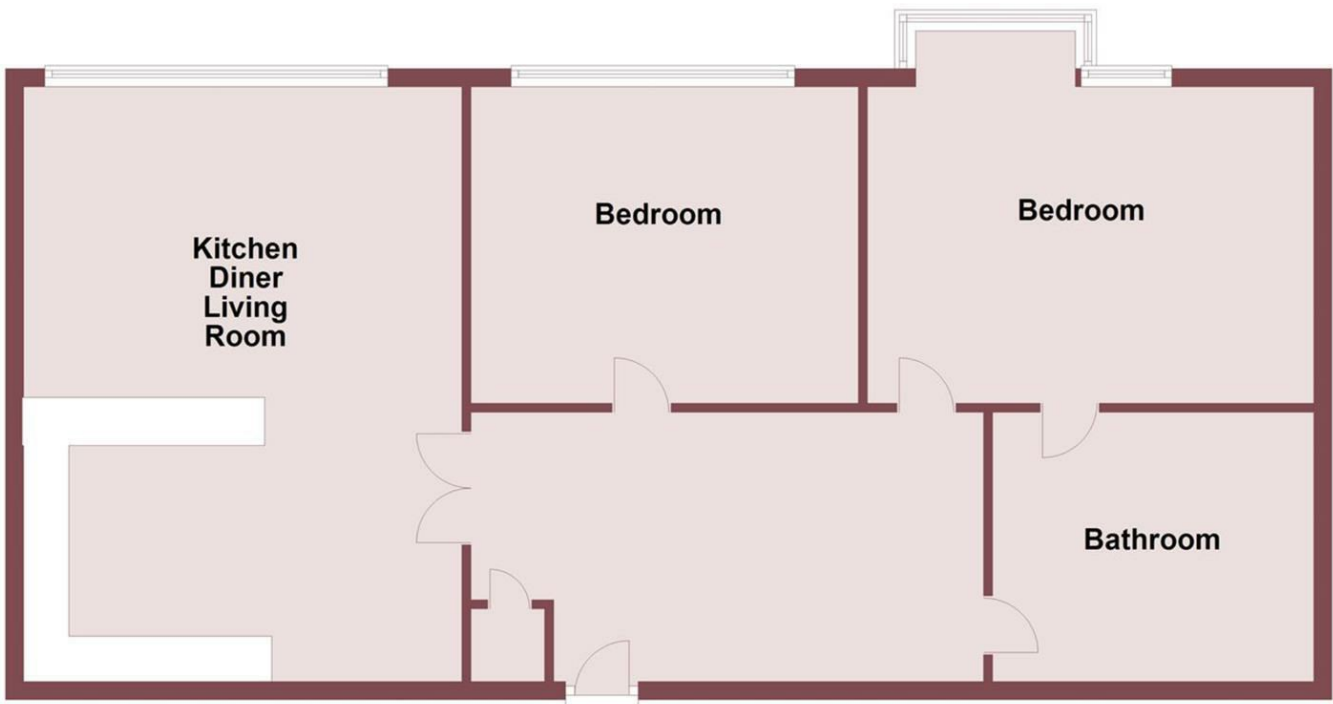

Whilst every attempt has been made to ensure the accuracy of this floor plan, measurements of doors, windows, rooms and any other items are approximate and no responsibility is taken for any error, omission or mis-statement. The plan is for illustrative purposes only and should be used as such by any prospective purchaser. The services, systems and appliances shown here have not been tested and no guarantee to their operability or efficiency can be given. Plan produced using PlanUp.



Pensby Road, Wirral, CH60 7RE
£115,000

2 Bedroom 1 Reception 1 Bathroom C

Two Bedroom Flat - Centre Of Heswall - Perfect Investment - Option To Buy THREE!

Hewitt Adams is pleased to offer to the market this TWO BEDROOM flat located in the CENTRE OF HESWALL.

The flat is very SPACIOUS and the location in the heart of Heswall is second to none!

The property is currently tenanted and is a fantastic INVESTMENT OPPORTUNITY.

In brief the accommodation affords; entrance hall, large open plan kitchen dining living room, two large bedrooms and a bathroom.

Call Hewitt Adams to view now.

