

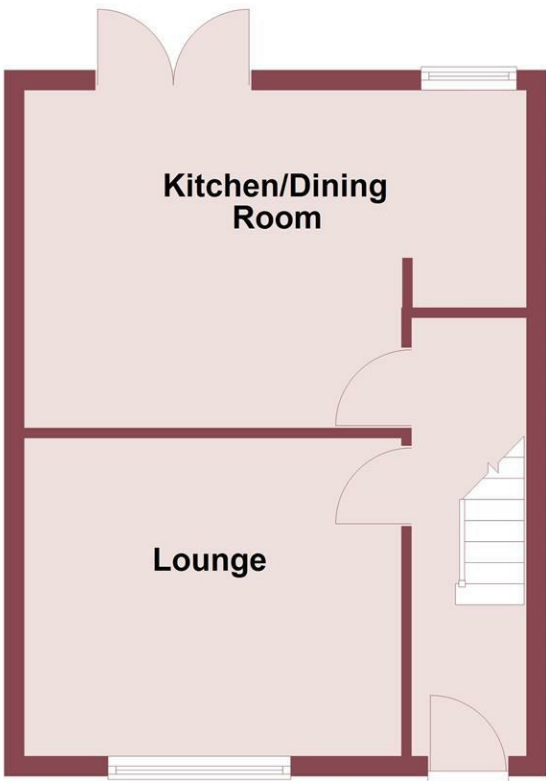

Ground Floor

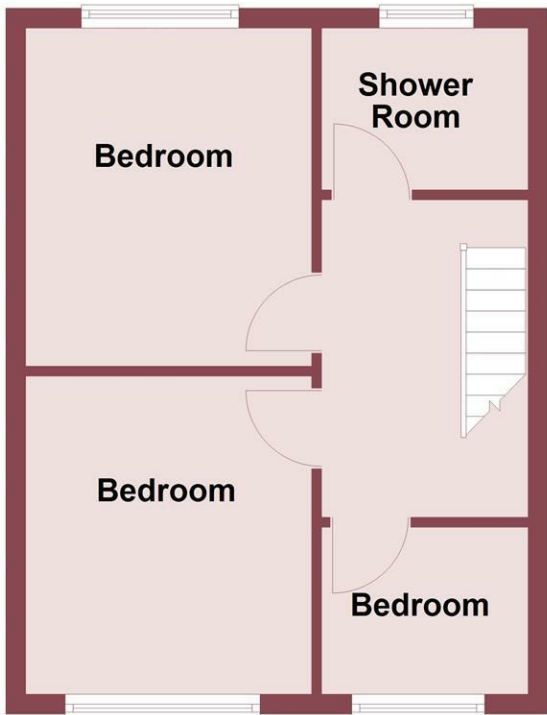

First Floor



Ashlea Road, Pensby, Wirral CH61 5UN
£230,000

3 Bedroom 2 Reception 1 Bathroom D

****Three Bedroom Semi - Sold With No Chain - Ideal First Time Buy****

Hewitt Adams offers to the market with the benefit of NO ONWARD CHAIN this three bedroom semi located on Ashlea Road in Pensby. A popular residential road in Pensby.

A short distance from the local shops, local schools and with Heswall's town centre being only a minute or two drive away.

The property also has the notable selling feature of a large rear garden that offers a wealth of possibilities! Perfect for gardening enthusiasts or outdoor entertainers.

In brief the accommodation affords: entrance hall, lounge, dining room and kitchen. Upstairs there are three bedrooms and the main bathroom.

With off-road driveway parking and a large rear garden. With gas central heating and double glazing.

Call Hewitt Adams on 0151 342 8200 to view.

Front Entrance

Into:

Hall

Staircase to first floor, radiator

Lounge

10'5" x 12'5" (3.2 x 3.8)

Double glazed window, radiator, power points, fireplace

Kitchen Dining (Open Plan)

16'7" x 11'1" (5.06 x 3.4)

Wall and base units, inset sink, integrated oven and hob, double glazed window, double glazed patio doors to the garden, radiator, power points

UPSTAIRS

Bedroom One

10'4" x 13'1" (3.17 x 4.00)

Double glazed window, radiator, power points

Bedroom Two

10'5" x 11'1" (3.2 x 3.4)

Double glazed window, radiator, power points

Bedroom Three

6'9" x 5'6" (2.06 x 1.68)

Double glazed window, radiator, power points

Bathroom

Comprising bath, low level W.C, wash hand basin, double glazed window

EXTERNALLY

The property also has the notable selling feature of a large rear garden, that offers a wealth of possibilities! Perfect for gardening enthusiasts or outdoor entertainers.

