

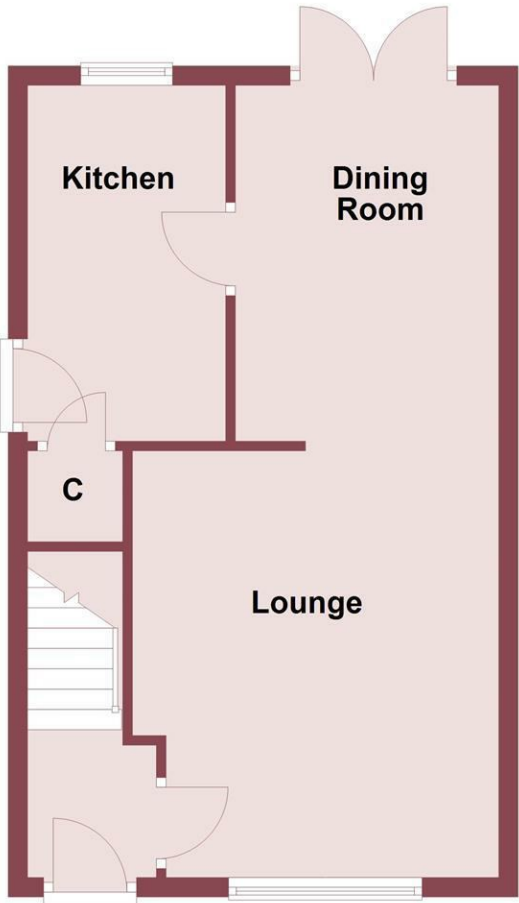

Ground Floor

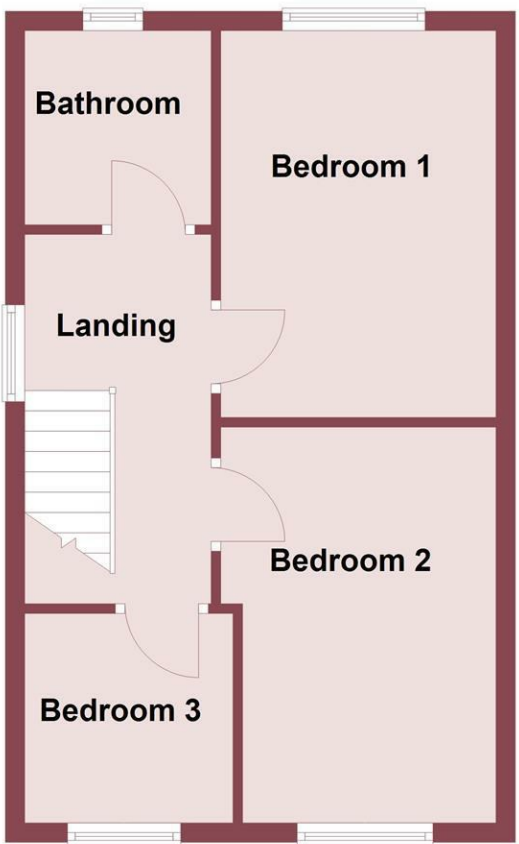

First Floor



Christleton Close, Prenton, Wirral CH43 0XF

£179,950

3 Bedroom 1 Reception 1 Bathroom

****Ideal First Time Buy - Three Bedroom Semi - Sold With No Onward Chain****

Hewitt Adams is delighted to offer to the market with NO ONWARD CHAIN this modern THREE BEDROOM semi-detached home located on the POPULAR Christleton Close in Prenton.

The property is ideally suited for FIRST TIME BUYERS.

In brief the accommodation affords; entrance hall, lounge and dining room, kitchen. Upstairs there are three bedrooms and a bathroom.

With off-road driveway parking and a private enclosed rear garden.

With gas central heating and double glazed windows.

Call Hewitt Adams on 0151 342 8200 to view.

Front Entrance

Into;

Hall

Staircase to first floor

Lounge & Dining Room

26'10" x 11'9" (8.2 x 3.6)

Double glazed window to front aspect, double glazed patio doors to the garden, radiator, power points

Kitchen

12'7" x 6'3" (3.86 x 1.91)

Wall and base units, inset sink, double glazed window, side door, cupboard, space for white goods

UPSTAIRS

Bedroom One

14'4" x 8'8" (4.38 x 2.66)

Double glazed window, radiator, power points

Bedroom Two

13'1" x 8'8" (3.99 x 2.65)

Double glazed window, radiator, power points

Bedroom Three

6'5" x 5'4" (1.97 x 1.65)

Double glazed window, radiator, power points

Bathroom

Comprising bath with shower above, low level W.C, wash hand basin

EXTERNALLY

Front Aspect - Driveway and small front garden

Rear Aspect - Laid to patio and lawn.

