

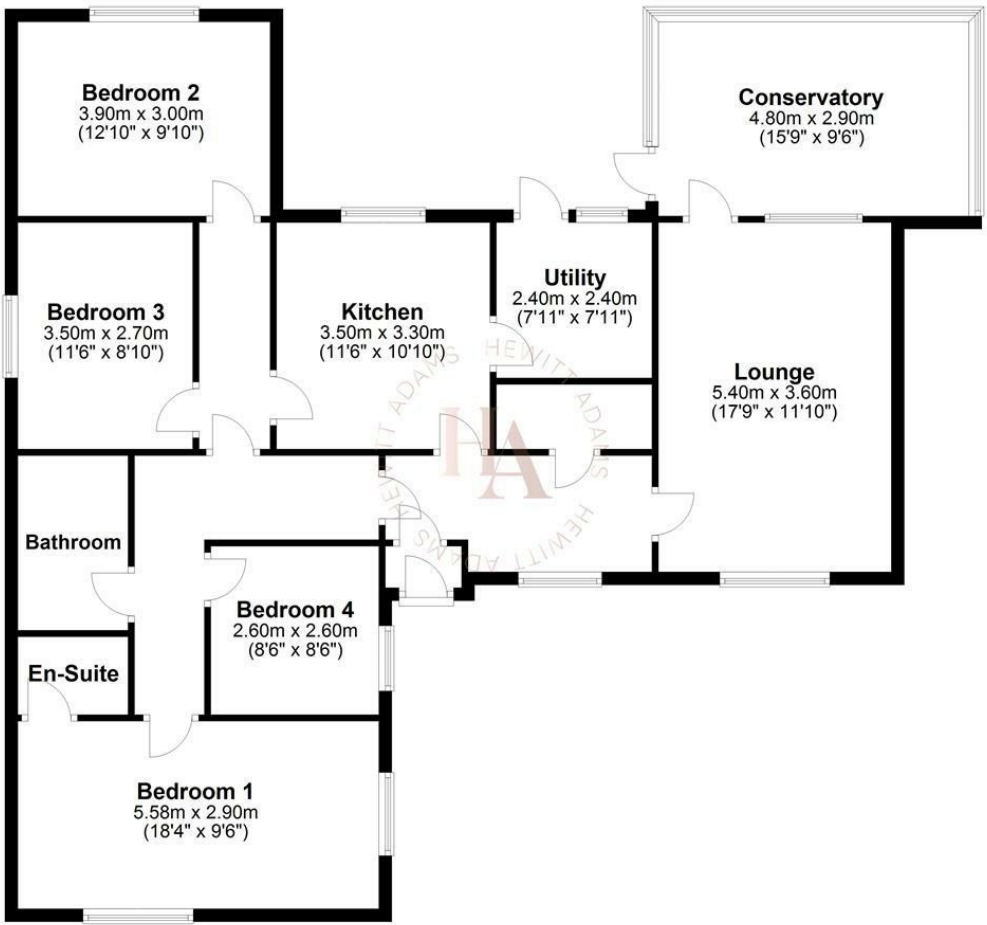

Ground Floor

Approx. 128.6 sq. metres (1384.7 sq. feet)



Total area: approx. 128.6 sq. metres (1384.7 sq. feet)
For illustration purposes only - not to scale



Rowan Tree Close, Greasby, Wirral CH49 3AW
Offers Over £360,000

4 Bedroom 2 Reception 2 Bathroom D

Detached Bungalow - Popular Greasby Location - Four Bedrooms - Large Corner Plot - Sold With No Chain!

Hewitt Adams is delighted to offer to the market this DETACHED FOUR BEDROOM bungalow located on the POPULAR Rowan Tree Close in Greasby.

Occupying a GENEROUS CORNER PLOT at the head of this QUIET CUL-DE-SAC - this is an unusually SPACIOUS bungalow, and one that offers fabulous VERSATILE living accommodation that will suit both DOWN-SIZERS and FAMILIES alike.

In brief the accommodation affords; entrance porch, hall, lounge, conservatory, kitchen, utility, bathroom, FOUR double bedrooms - the master having a small en-suite w.c.

Externally there is a LARGE DRIVEWAY and a DETACHED GARAGE. With a good sized garden comprising of patios, lawned area and summerhouse.

Sold with NO ONWARD CHAIN - Call Hewitt Adams on 0151 342 8200 to view.

Front Entrance

Into;

Porch

Door into;

Hall

Cupboards, radiator, power points, double glazed window

Lounge

17'8" x 11'9" (5.4 x 3.6)

Double glazed window, radiator, power points, TV point, sliding door into;

Conservatory

9'6" x 15'8" (2.9 x 4.8)

Double glazed. Overlooking the garden

Kitchen

11'5" x 10'9" (3.5 x 3.3)

Fitted wall and base units, central island, inset sink, double glazed window, spaces for white goods, door into

Utility

7'10" x 7'10" (2.4 x 2.4)

Double glazed window, rear door, space for fridge freezer, space and plumbing for washing machine and dryer

Bedroom One

9'6" x 18'4" (2.9 x 5.6)

Double glazed windows, radiator, power points, door into;

En-Suite W.C

W.C, wash hand basin

Bedroom Two

9'10" x 12'9" (3.00 x 3.9)

Double glazed windows, radiator, power points

Bedroom Three

8'10" x 11'5" (2.7 x 3.5)

Double glazed windows, radiator, power points

Bedroom Four

8'6" x 8'6" (2.6 x 2.6)

Double glazed windows, radiator, power points

Shower-Room

Comprising wet-room style shower, bath, low level W.C, wash hand basin, double glazed windows

EXTERNALLY

Externally there is a LARGE DRIVEWAY and a DETACHED GARAGE. With a good sized garden comprising of patios, lawned area and summerhouse.

Detached Garage

With power and lighting. Up & Over door.

