

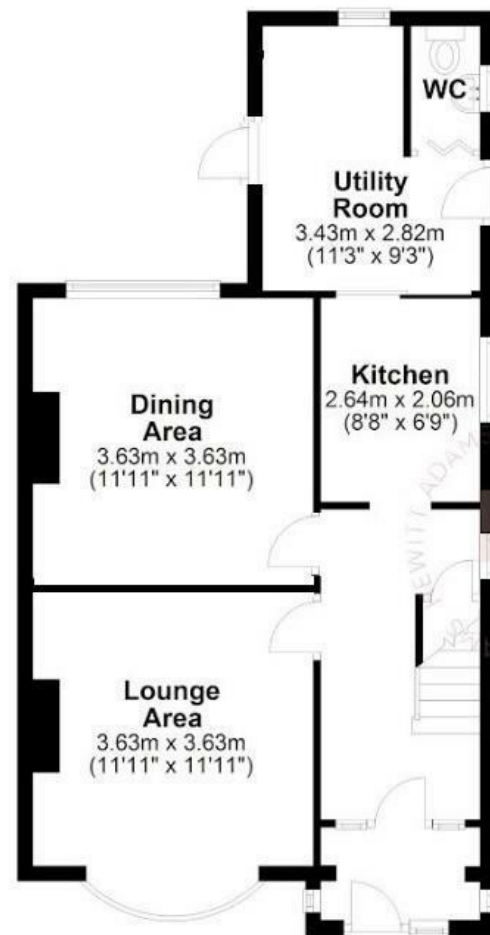

Ground Floor
Approx. 54.5 sq. metres (586.4 sq. feet)

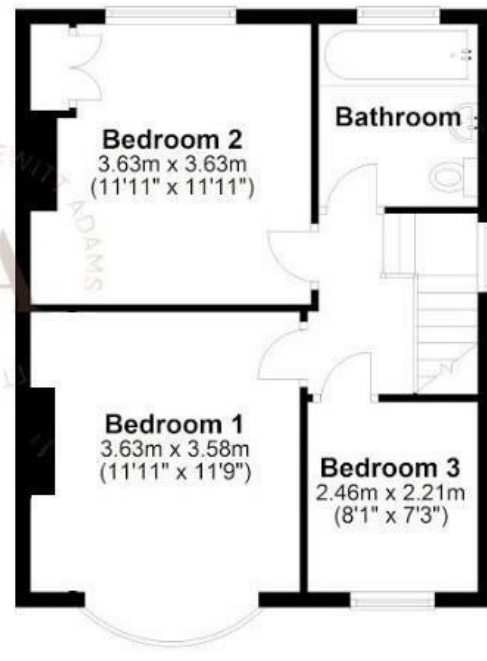

First Floor
Approx. 43.0 sq. metres (462.8 sq. feet)



Total area: approx. 97.5 sq. metres (1049.2 sq. feet)
For illustration purposes only - not to scale

Broadway, Greasby, Wirral CH49 2NG

£290,000

3 Bedroom 2 Reception 1 Bathroom

****Huge Corner Plot - Three Bedroom Semi - Potential To Extend - New Roof & New Boiler - Sought After Greasby Location****

Hewitt Adams is delighted to showcase this large THREE BEDROOM semi-detached home on the ever POPULAR Broadway in Greasby. Occupying a GENEROUS CORNER PLOT the house enjoys a very large garden and this provides SCOPE TO EXTEND - subject to regs.

The property has been well maintained and has had a NEW ROOF and NEW top of the range BOILER in recent years. An ideal home for FISRT TIME BUYERS or as a STARTER FAMILY HOME.

With the huge plot and space to the side of the property - this is a home that could grow with you alongside your family if you did need to extend to create more space.

In brief the accommodation affords: entrance porch, hall, lounge, dining room, kitchen, utility and W.C. Upstairs there are three bedrooms and a NEW bathroom.

With GENEROUS GARDENS to the the front and side, with a rear driveway and garage.

Call Hewitt Adams on 0151 342 8200 to view.

Front Entrance

Into:

Porch

Door into:

Hall

Staircase, radiator

Lounge

11'9" x 11'9" (3.6 x 3.6)

Double glazed window, radiator, power points

Dining Room

11'9" x 11'9" (3.6 x 3.6)

Double glazed window, radiator, power points

Kitchen

8'6" x 6'9" (2.6 x 2.06)

Wall and base units, inset sink, double glazed window, integrated oven and hob, space for dishwasher, leads to:

Utility

11'6" x 12'5" (3.4 x 3.8)

Double glazed windows, radiator, power points, space and plumbing for washing machine, space for large free-standing fridge freezer, doors to the garden, door into:

W.C.

W.C, wash hand basin

UPSTAIRS

Bedroom One

11'9" x 11'9" (3.6 x 3.6)

Double glazed window, radiator, power points

Bedroom Two

11'9" x 11'9" (3.6 x 3.6)

Double glazed window, radiator, power points

Bedroom Three

7'10" x 7'2" (2.4 x 2.2)

Double glazed window, radiator, power points

Bathroom

NEW modern stylish bathroom with bath with shower above, low level W.C, wash hand basin vanity unit, fully tiled walls, radiator, double glazed window

Loft

Boarded, with loft ladder

EXTERNALLY

With GENEROUS GARDENS to the the front and side, with a rear driveway and garage. With external power points.

