

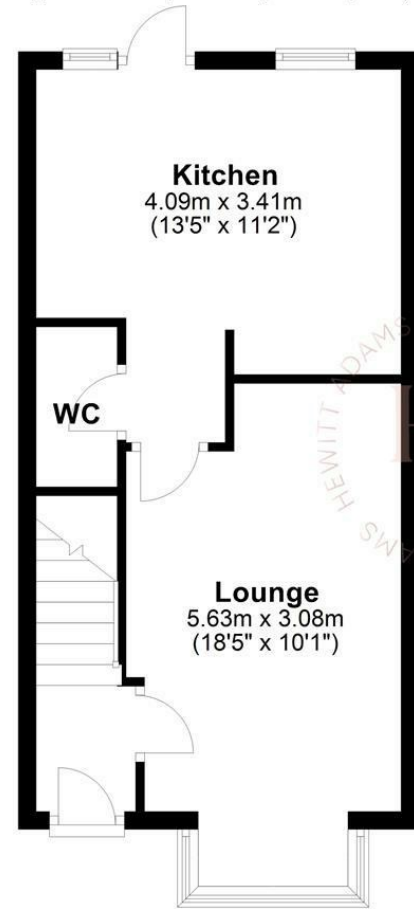

Ground Floor
Approx. 35.4 sq. metres (380.6 sq. feet)

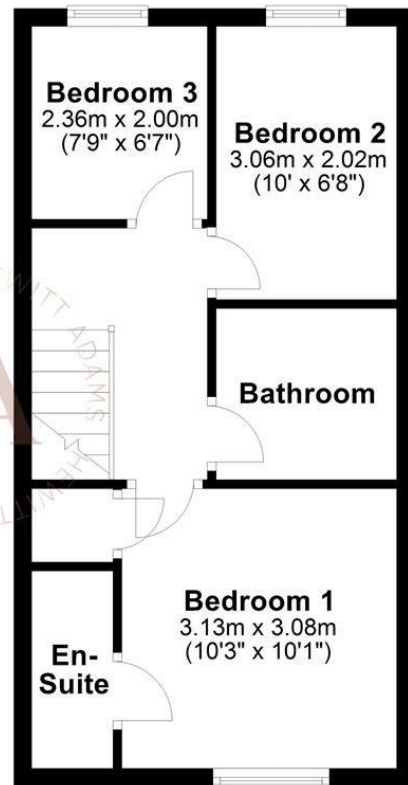

First Floor
Approx. 34.0 sq. metres (365.5 sq. feet)



Total area: approx. 69.3 sq. metres (746.1 sq. feet)
For illustration purposes only - not to scale

Tapestry Gardens, Birkenhead, CH41 7BQ

£127,500

3 Bedroom 1 Reception 2 Bathroom C

Three Bedroom Mid Terrace - En Suite - Ideal First Time Buy Or Investment - No Chain

Hewitt Adams is delighted to bring to market this THREE BEDROOM mid terrace property on Tapestry Gardens, a quiet cul-de-sac off Hoylake Road, Birkenhead. Situated close to LOCAL AMENITIES and TRANSPORT LINKS to Liverpool.

An ideal FIRST TIME BUY or INVESTMENT, this property would achieve circa £750pcm on the rental market.

The property has been newly decorated and NEW CARPETS have been fitted throughout.

In brief the property affords: hall, lounge, kitchen and downstairs wc. Upstairs there are three bedroom, the main with an en suite, and a bathroom.

This NO CHAIN property also comes with an allocated parking space to the front.

Call Hewitt Adams today to book your viewing.

Front Entrance

Into:

Hall

Stairs to first floor

Lounge

10'1" x 18'5" (3.08 x 5.63)

Double glazed bay window, radiator, power point

Kitchen

13'5" x 11'2" (4.09 x 3.41)

Wall and base units, inset sink, integral oven and gas burners, space for white goods, double glazed window and door to rear

WC

3'1" x 4'11" (0.94 x 1.52)

WC, wash hand basin, radiator

First Floor

Bedroom One

10'1" x 10'3" (3.08 x 3.13)

Double glazed window, radiator, power point, storage cupboard, door to

En Suite

3'2" x 7'2" (0.97 x 2.20)

Walk in shower, WC, wash hand basin, towel rail

Bedroom Two

6'7" x 10'0" (2.02 x 3.06)

Double glazed window, radiator, power point

Bedroom Three

6'6" x 7'8" (2.00 x 2.36)

Double glazed window, radiator, power point

Bathroom

6'6" x 6'3" (2.00 x 1.92)

Shower over bath, WC, wash hand basin, towel rail

Externally

Front - allocated parking for one car

Rear - mainly laid to lawn with gate access to rear

