

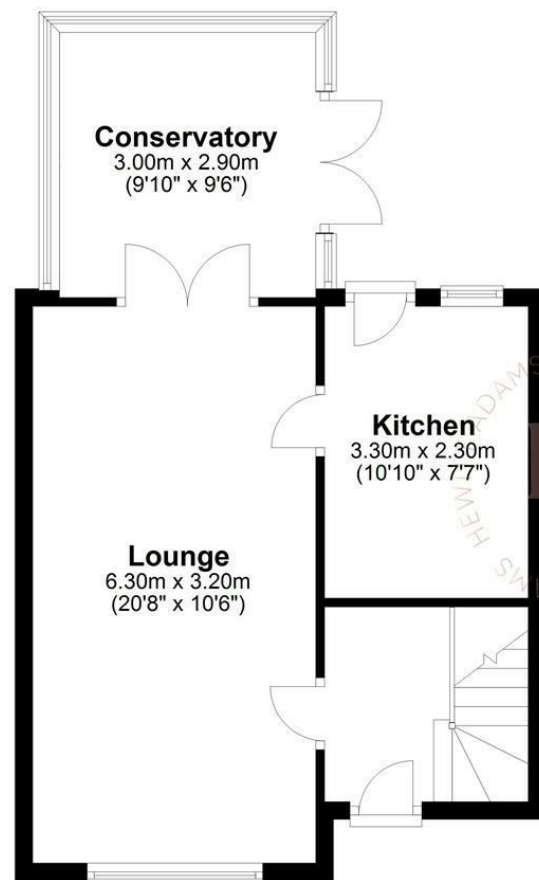

Ground Floor

Approx. 42.6 sq. metres (459.0 sq. feet)



First Floor

Approx. 34.3 sq. metres (369.1 sq. feet)

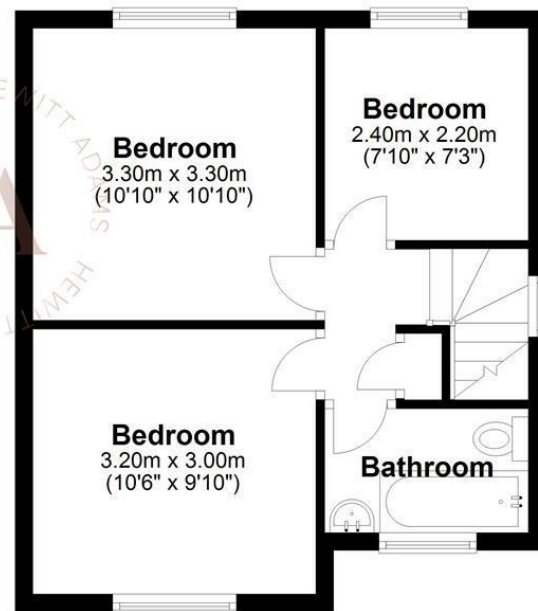

Total area: approx. 76.9 sq. metres (828.1 sq. feet)
For illustration purposes only - not to scale

Crossways, Bromborough, Wirral CH62 3NF

£185,000

3 Bedroom 2 Reception 1 Bathroom

****Three Bedroom Semi - Popular Bromborough Location - A Perfect First Time Buy****

Hewitt Adams is delighted to offer to the market this IMMACULATE three bedroom semi on Crossways in Bromborough - a short distance from the centre of the village, and within walking distance of a wide range of local amenities.

The property has been improved and MODERNISED by the current owners and comes to the market in EXCELLENT CONDITION.

In the agents opinion this is a perfect property for anyone looking to get onto the property ladder.

In brief the accommodation affords: entrance hall, lounge dining room, kitchen, conservatory. Upstairs there are three good sized bedrooms and the family bathroom.

With off-road driveway parking and a stunning rear garden laid to patio and lawn that gets a lot of sunshine!

Call Hewitt Adams on 0151 342 8200 to view.

Front Entrance

Into:

Hall

Staircase to first floor, radiator, power points

Kitchen

10'9" x 7'6" (3.3 x 2.30)

Modern kitchen with fitted wall and base units, inset sink, double glazed window, space for white goods, radiator

Lounge

20'8" x 10'5" (6.3 x 3.20)

Double glazed window, radiator, power points, TV point, fireplace, doors into:

Conservatory

9'10" x 9'6" (3.00 x 2.90)

Double glazed windows and doors. Overlooking the garden

UPSTAIRS

Bedroom One

10'5" x 9'10" (3.20 x 3.00)

Double glazed window, radiator, power points

Bedroom Two

10'9" x 10'5" (3.30 x 3.20)

Double glazed window, radiator, power points

Bedroom Three

7'10" x 7'2" (2.4 x 2.20)

Double glazed window, radiator, power points

Bathroom

Comprising bath with shower above, low level w.c, wash hand basin, towel rail, double glazed window

EXTERNALLY

Front Aspect - Driveway offering off-road parking

Rear Aspect - A stunning rear garden laid to patio and lawn that gets a lot of sunshine!

