

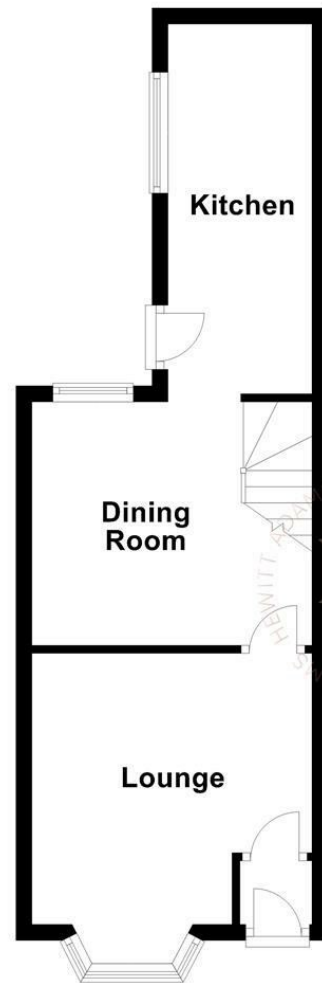

Ground Floor

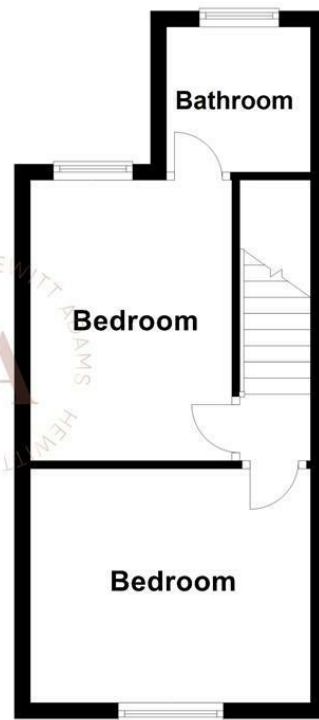

First Floor



For illustration purposes only - not to scale

Yelverton Road, Birkenhead, CH42 6PF  
Offers Over £90,000

🛏️ 2 Bedroom   🛋️ 2 Reception   🚿 1 Bathroom   📊

**\*\*Wow Factor - Renovated End Terrace - A Perfect First Time Buy - Exceptional Condition - No Chain!\*\***

Hewitt Adams is excited to offer to the market with NO ONWARD CHAIN this FULLY RENOVATED two bedroom end terraced home on Yelverton Road.

The property comes to the market in SHOW-HOME condition having been PROFESSIONALLY renovated to a very HIGH STANDARD with a STYLISH MODERN KITCHEN & BATHROOM.

In IMMACULATE CONDITION throughout - this truly is an IDEAL FIRST TIME BUY or INVESTMENT OPPORTUNITY as it is completely TURN-KEY.

In brief the accommodation affords: entrance hall, lounge, dining room, kitchen. Upstairs there are two DOUBLE bedrooms and a bathroom.

With double glazed windows and gas central heating.

With a private rear yard.

Sold with NO ONWARD CHAIN - Call Hewitt Adams on 0151 342 8200 to view.

**Front Entrance**

Into:

**Lounge**

Double glazed bay window, radiator, power points

**Dining Room**

Double glazed window, radiator, power points

**Kitchen**

Modern stylish fitted kitchen with wall and base units, inset sink, integrated appliances, double glazed window, door to rear yard

**UPSTAIRS**

**Bedroom One**

Double glazed window, radiator, power points

**Bedroom Two**

Double glazed window, radiator, power points

**Bathroom**

Comprising bath with shower above, low level W.C, wash hand basin, towel rail, double glazed window

**EXTERNALLY**

With a small private rear yard.

