

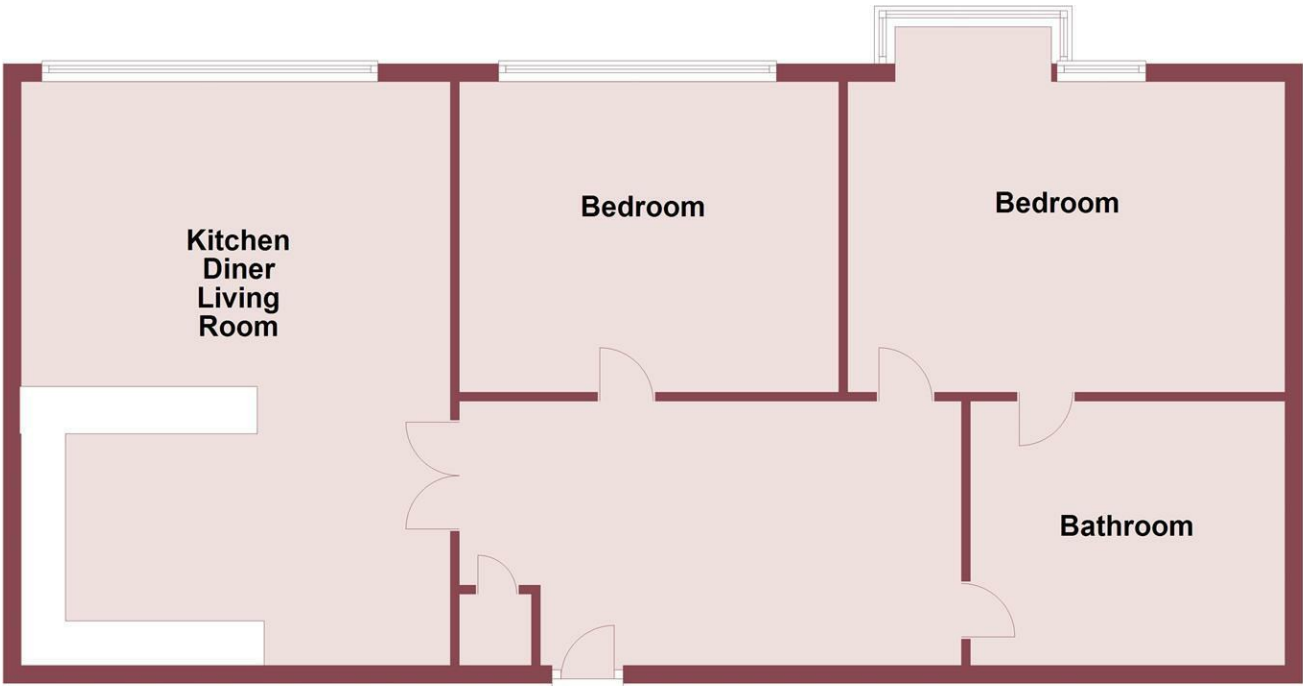

Ground Floor



Whilst every attempt has been made to ensure the accuracy of this floor plan, measurements of doors, windows, rooms and any other items are approximate and no responsibility is taken for any error, omission or mis-statement. The plan is for illustrative purposes only and should be used as such by any prospective purchaser. The services, systems and appliances shown here have not been tested and no guarantee to their operability or efficiency can be given.
Plan produced using PlanUp.



52 - 60 Pensby Road, Heswall, CH60 7RE
Auction Guide £110,000

2 Bedroom 1 Reception 1 Bathroom C

Being Sold via Secure Sale online bidding. Terms & Conditions apply. Starting Bid £110,000

We are delighted to offer For Sale this Two Bedroom First Floor Apartment that is to be sold with a tenant in situ.

At this stage, the landlords would like to offer the property to investors due to a long standing tenant, paying £700 PCM.

In brief the property affords: hall, kitchen diner living space, two bedrooms and a bathroom.

AUCTIONEERS COMMENTS:

The property is being sold via a transparent online auction.
In order to submit a bid upon any property being marketed by The Auctioneer, all bidders/buyers will be required to adhere to a verification of identity process in accordance with Anti Money Laundering procedures. Bids can be submitted at any time and from anywhere.

Front Entrance

Into:

Hall

Radiator, power point, storage cupboard

Kitchen Diner Living Room

15'10" x 21'6" (4.83 x 6.56)

Wall and base units with breakfast bar, inset sink, integral oven and hob, integral dishwasher, integral fridge, space for washing machine, double glazed window, radiator, power points. Ample space for a dining table.

Bedroom

14'0" x 11'5" (4.27 x 3.49)

Double glazed window, radiator, power point

Bedroom

16'1" x 11'4" (4.92 x 3.47)

Double glazed window, radiator, power point

Bathroom

11'7" x 6'5" (3.54 x 1.98)

Comprising shower over bath, wash hand basin, wc, towel rail, tiled walls and floor

Additional Information

Tenure: Leasehold

Management Company: Propeller Lettings

Service Charge: £2340.80

Ground Rent: £200

Lease Length: 108 years remaining

