

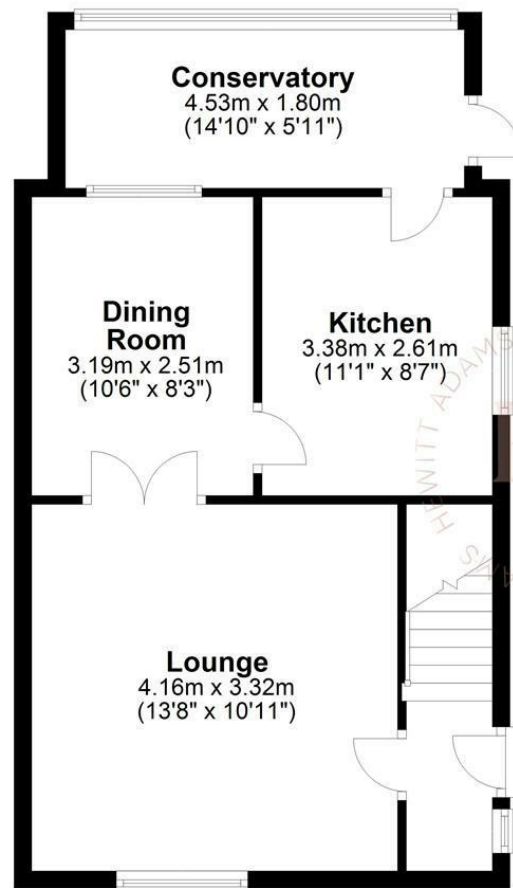

Ground Floor

Approx. 48.0 sq. metres (517.0 sq. feet)



First Floor

Approx. 39.9 sq. metres (429.4 sq. feet)



Total area: approx. 87.9 sq. metres (946.3 sq. feet)
For illustration purposes only - not to scale

Exmoor Close, Wirral, Wirral CH61 9QN
Offers Over £190,000

3 Bedroom 2 Reception 1 Bathroom

****Three Bedroom Semi - Large Corner Plot - Sold With No Chain - Huge Potential - Perfect First Time Buy!****

Hewitt Adams is pleased to offer to the market with NO ONWARD CHAIN this three bedroom semi-detached home on the popular Exmoor Close in Pensby.

The property comes to the market requiring a scheme of modernisation BUT has been competitively priced with this in mind. Offering a new owner the chance to CREATE THEIR DREAM HOME.

Occupying a corner plot - the property is afforded lots of space and natural light and offers a driveway, car-port, garage and a rear garden.

In brief the accommodation affords: entrance hall, lounge, dining room, kitchen and a conservatory. Upstairs there are three bedrooms and a bathroom.

With a driveway, car-port and a private rear garden.

Call Hewitt Adams on 0151 342 8200 to view this NO CHAIN property.

Front Entrance

Into;

Hall

Staircase to first floor, double glazed window, door into;

Lounge

Double glazed window, radiator, power points, doors into;

Dining Room

Double glazed window, radiator, power points, door into;

Kitchen

Wall and base units, inset sink, double glazed window, spaces for appliances, worktop surfaces, door to;

Conservatory

Double glazed windows, door to outside

UPSTAIRS

Bedroom One

Double glazed window, radiator, power points

Bedroom Two

Double glazed window, radiator, power points, wardrobes

Bedroom Three

Double glazed window, radiator, power points, cupboard

Bathroom

Comprising bath with shower above, low level W.C, wash hand basin, radiator, double glazed window

EXTERNALLY

Front Aspect - Driveway parking for several cars. Car port. Access to rear garden and the Garage.

Rear Aspect - Laid to lawn.

