

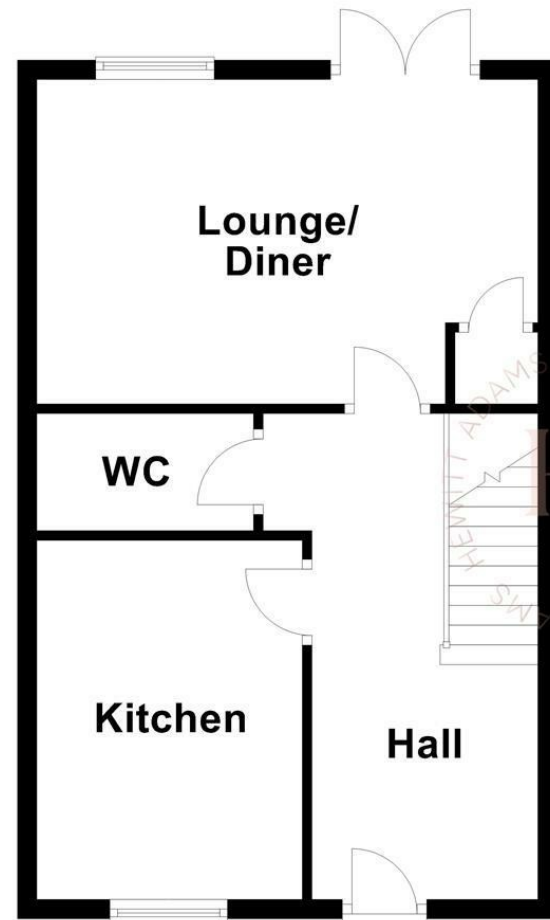

**Ground Floor**



**First Floor**



For illustration purposes only - not to scale

**Fairview Place, Pensby, Wirral CH61 6AA**  
**£215,000**

2 Bedroom 1 Reception 1 Bathroom

**\*\*Modern Build - Two Bedroom Semi - Show-Home Condition - Perfect First Time Buy - No Chain!\*\***

Hewitt Adams is delighted to offer to the market this **STYLISH, MODERN** semi-detached home located on Fairview Place in Pensby - a quiet residential cul-de-sac.

This modern, **ENERGY EFFICIENT** home is incredibly well presented and in the agents opinion, is the perfect **FIRST TIME BUY**.

In brief the accommodation affords: entrance hall, kitchen, W.C, lounge diner. Upstairs there are **TWO DOUBLE BEDROOMS** and a modern bathroom.

Positioned in a generous **CORNER PLOT** with a landscaped rear garden and **OFF-ROAD DRIVEWAY PARKING** for two cars.

**SOLD WITH NO ONWARD CHAIN** - Call Hewitt Adams on 0151 342 8200 to view.

**Front Entrance**

Into:

**Hall**

Staircase to first floor with glazed balustrade, radiator, power points, tiled floor

**Lounge**

16'9" x 10'4" (5.13 x 3.16)

Double glazed patio doors to garden, double glazed window, radiator, power points, TV point, cupboard

**Kitchen**

9'6" x 9'7" (2.90 x 2.94)

Modern kitchen with fitted wall and base units, inset sink, spaces for white goods, double glazed window

**W.C**

W.C, wash hand basin

**UPSTAIRS**

**Bedroom One**

10'6" x 13'1", 183'8" (3.21 x 4.56)

Double glazed windows, radiator, power points, wardrobes

**Bedroom Two**

8'11" x 14'11" (2.73 x 4.55)

Double glazed windows, radiator, power points, wardrobes

**Bathroom**

Comprising bath, low level w.c, wash hand basin, towel rail, double glazed window

**EXTERNALLY**

Front Aspect - Off-road driveway parking, side gate to rear garden

Rear Aspect - Generous sized rear garden with patio and lawn. Garden shed. Landscaped very nicely. A perfect put door space for entertaining.

