



Jackson & Co



Fairfield Road

Saxmundham, IP17

Offers In Excess Of £425,000

Hug potential with this Victorian Villa in the Heart of Saxmundham – A Rare Opportunity



Property Features

- Large plot
- Potential for a second dwelling stp
- No chain
- Double garage
- Four reception rooms
- Walking distance to the town
- Original features
- Renovation project

Full Description

DESCRIPTION

A Stunning Victorian Villa in the Heart of Saxmundham – A Rare Opportunity

Nestled just a short stroll from the vibrant heart of Saxmundham, this grand detached Victorian villa is a true gem. Offering a wealth of light-filled, spacious accommodation, this home is bursting with original character and charm. Retaining many period features such as exposed floorboards, original fireplaces, and soaring high ceilings, it exudes timeless elegance.

Boasting four generously sized double bedrooms and four impressive reception rooms, this property provides plenty of space for both family living and entertaining. The property also comes with the added benefit of a detached self-

contained annexe, perfect for guests or multi-generational living, alongside a double detached garage.

Outside, the pretty secluded rear garden offers a peaceful retreat, and the large side plot presents further potential for expansion or development, subject to planning. While the property would benefit from some modernization, it presents an exciting opportunity to make it your own and truly put your personal stamp on it.

A Prime Location in Saxmundham

Saxmundham, a charming market town on the picturesque Suffolk Coast, offers a perfect blend of rural tranquillity and easy access to some of the region's most sought-after attractions. The town is well-served by excellent rail and road links, making it an ideal base for exploring the stunning coastline and beyond. The bustling high street is home to a range of cafés, pubs, and restaurants, along with an eclectic mix of independent shops, creating a vibrant and welcoming community atmosphere.

This is a rare chance to own a piece of history and create your dream home in a coveted location.

**Approximate Gross Internal Area
1880 sq ft - 174 sq m**

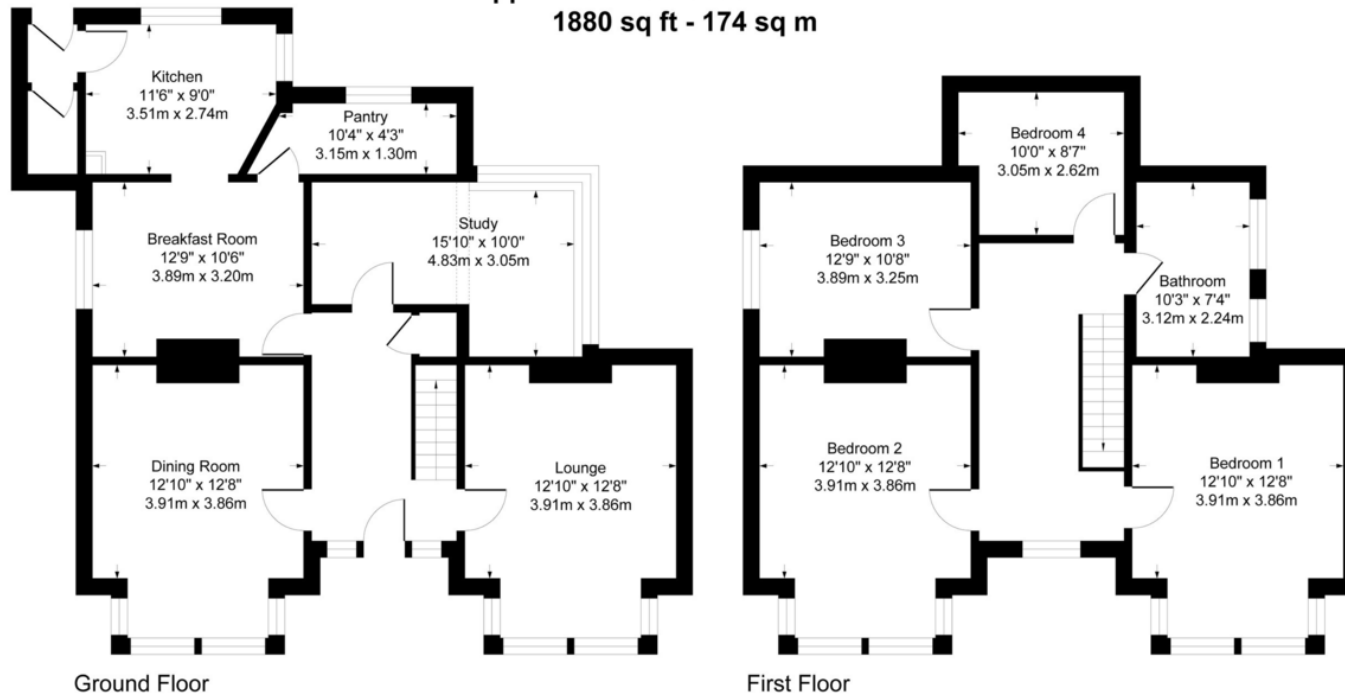

Although every attempt has been made to ensure accuracy, all measurements are approximate.
This floorplan is for illustrative purposes only and not to scale.
Measured in accordance with RICS Standards.

%epcGraph_c_1_263%

Jackson & Co
43 Basepoint
70-72 The Havens
Ransomes Euro Park
IP3 9BF

www.jackson-ps.co.uk
contact@jackson-ps.co.uk
01473 722981

Agents Note: Whilst every care has been taken to prepare these particulars, they are for guidance purposes only. All measurements are approximate are for general guidance purposes only and whilst every care has been taken to ensure their accuracy, they should not be relied upon and potential buyers/tenants are advised to recheck the measurements