



The Mead | | Soulbury | LU7 0EG
Asking Price £800,000

The Mead |
Soulbury | LU7 0EG
Asking Price £800,000

Fine Homes Property are excited to present this smart and spacious six bedroom family home, arranged over three floors in the sought after village of Soulbury. Surrounded by the glorious Bucks countryside to the rear. You have plenty of secure parking as well as the detached double garage. The accommodation comprises; entrance hall, large kitchen dining area, two living rooms, utility room, cloakroom, six double bedrooms and three bathrooms.

- A rarely available detached family home in the Bucks village of Soulbury.
- Peaceful cul-de-sac location.
- Modern and sociable living space downstairs perfect for entertaining.
- Short drive to Leighton Buzzard train station with direct links to London Euston.
- Beautiful garden backing onto open fields.
- Six double bedrooms!
- Private driveway & detached double garage.
- High specification kitchen and three bathrooms.
- Grammar school catchment area.
- Complete upper chain.



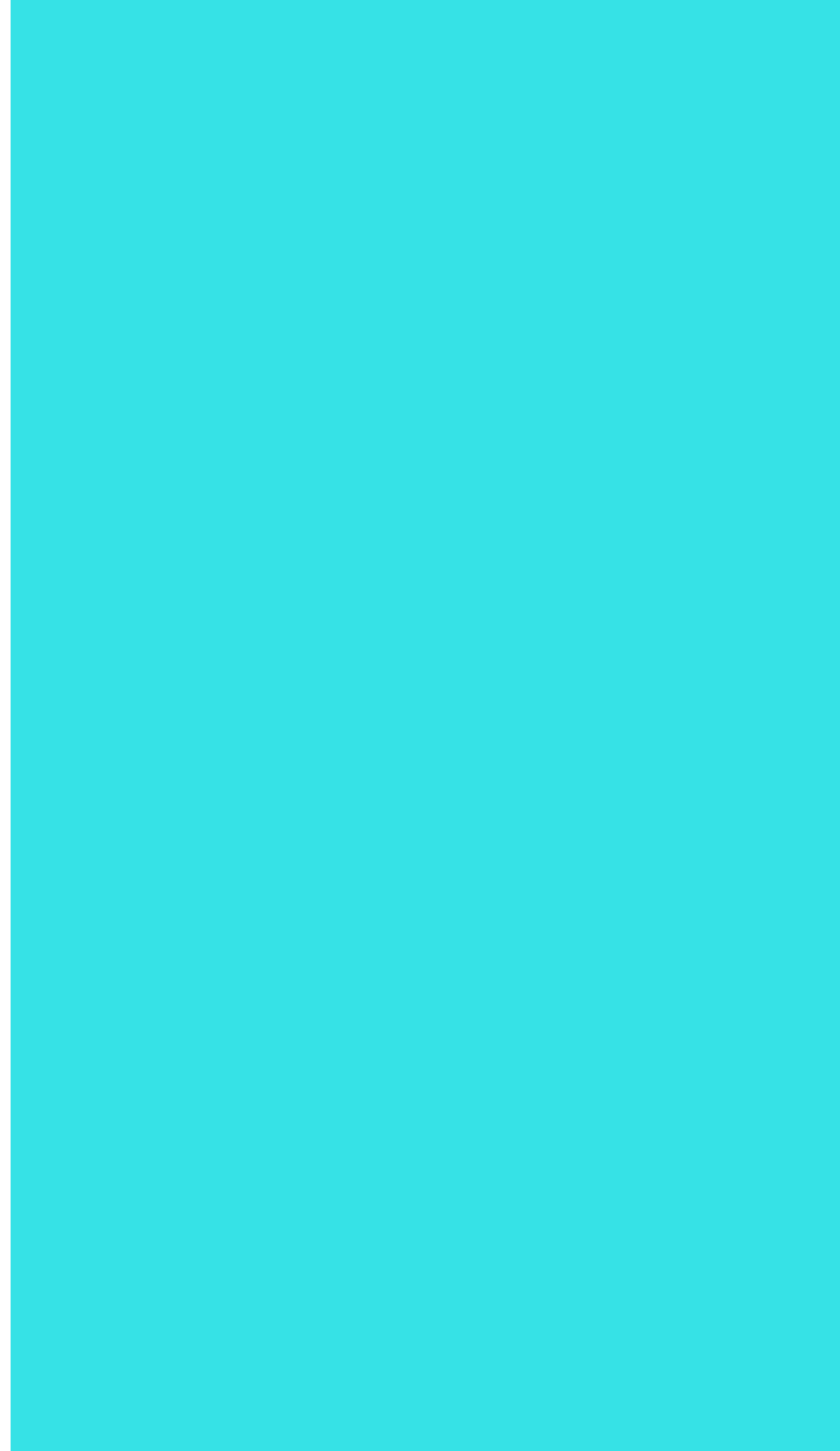



First Floor

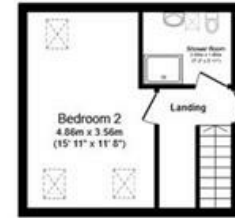

Second F

pprox

s only. It is not drawn to scale. Any measurements, floor ar
te. No details are guaranteed, they cannot be relied upon
en for any error, omission or misstatement. A party must r

Energy Efficiency Rating		Environmental Impact (CO ₂) Rating	
Current	Potential	Current	Potential
	86		
<small>Very energy efficient - lower running costs</small> <small>Not energy efficient - higher running costs</small>		<small>Very environmentally friendly - lower CO₂ emissions</small> <small>Not environmentally friendly - higher CO₂ emissions</small>	
<small>England & Wales</small>	<small>EU Directive 2002/91/EC</small>	<small>England & Wales</small>	<small>EU Directive 2002/91/EC</small>

Duck End
Great Brickhill
Buckinghamshire
MK17 9AP
01525 261100
enquiries@finehomesproperty.co.uk