



Maltings Close | Stewkley | Leighton Buzzard | LU7 0UN

Asking Price £895,000



Maltings Close | Stewkley  
Leighton Buzzard | LU7 0UN  
Asking Price £895,000

Fine Homes Property are excited to present this impressive detached family home with three reception rooms in the sought after village of Stewkley. Situated at the end of a cul-de-sac, your secluded south west facing garden backs on to fields with lovely views. The property is the ideal family home with masses of living space and excellent size bedrooms. There is a large driveway as well as double garage with room above which could be an office extra bedroom or a playroom.

- A spacious four bedroom detached family home.
- Excellent position at the end of the cul-de-sac.
- A Potten House built in 1998 - Energy efficient - EPC rated C.
- Four double bedrooms with en-suite to master bedroom.
- Parking for four cars and a double garage with room above for potential office of games room.
- Fantastic size garden backing onto fields.
- Impressive entrance hall and landing.
- Three reception rooms plus large kitchen breakfast room.
- Utility room and cloakroom.
- Excellent school catchments including the grammar schools.





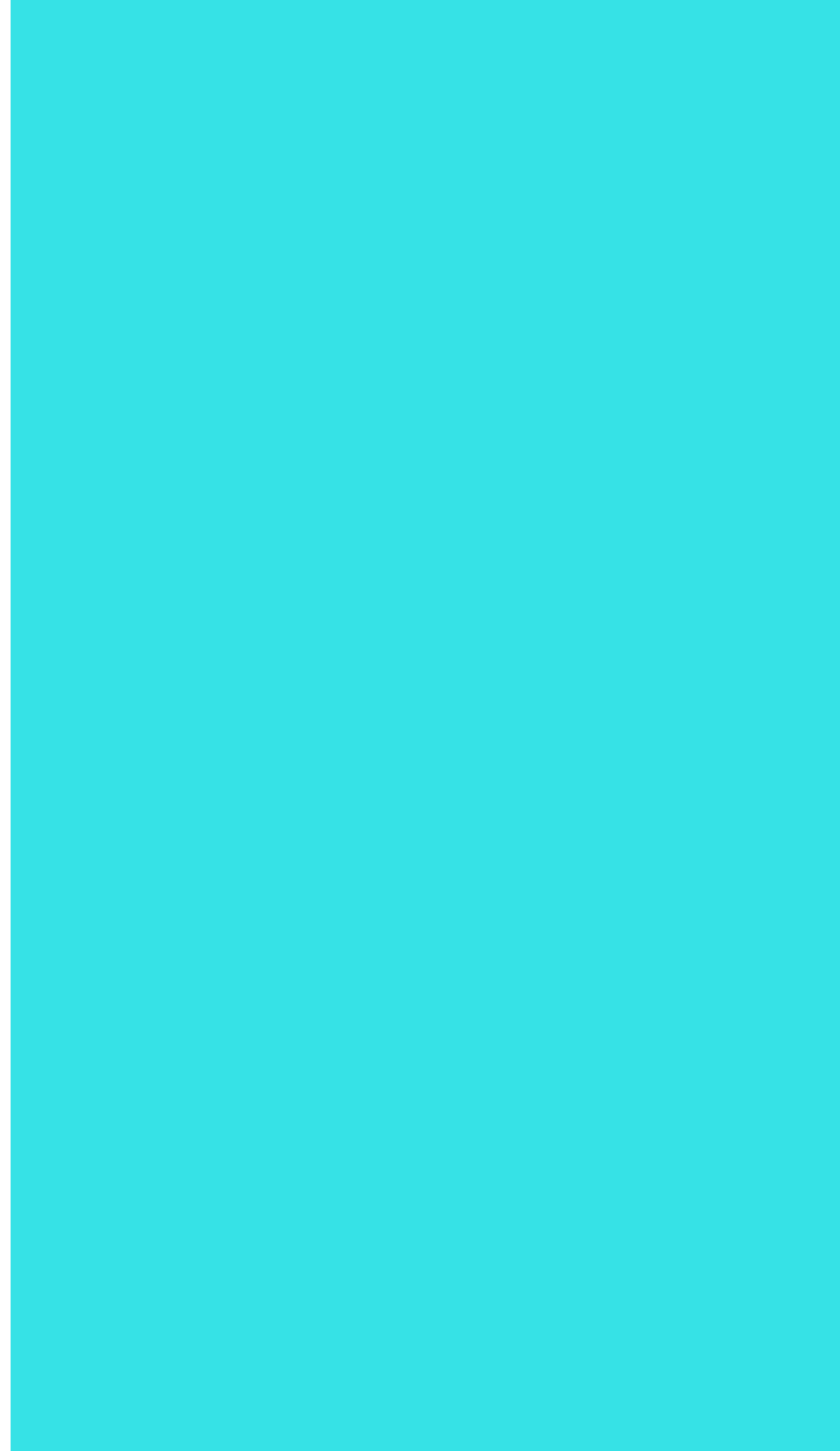

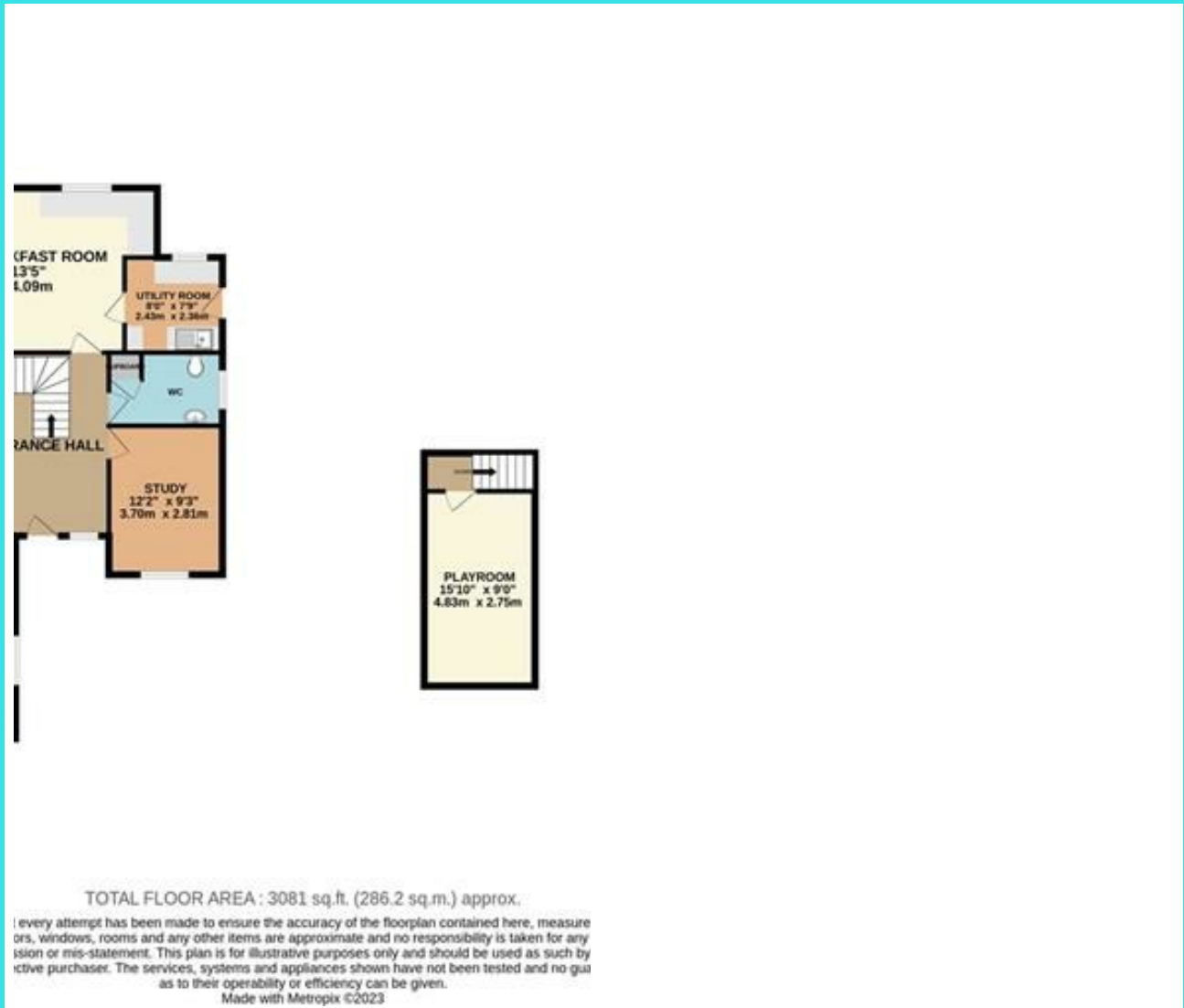
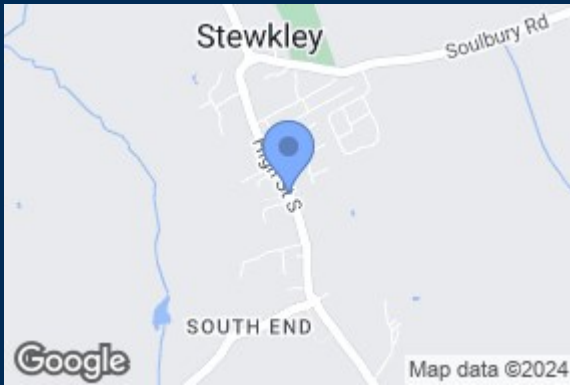

Energy Efficiency Rating		Current	Potential	Environmental Impact (CO <sub>2</sub> ) Rating		Current	Potential
Very energy efficient - lower running costs				Very environmentally friendly - lower CO <sub>2</sub> emissions			
(92-100) A				(92-100) A			
(81-91) B				(81-91) B			
(69-80) C				(69-80) C			
(55-68) D				(55-68) D			
(39-54) E				(39-54) E			
(21-38) F				(21-38) F			
(1-20) G				(1-20) G			
Not energy efficient - higher running costs				Not environmentally friendly - higher CO <sub>2</sub> emissions			
England & Wales		EU Directive 2002/91/EC		England & Wales		EU Directive 2002/91/EC	

Duck End  
Great Brickhill  
Buckinghamshire  
MK17 9AP  
01525 261100  
enquiries@finehomesproperty.co.uk