



2 Damery Court, Bramhall

£220,000 Leasehold

Two Double Bedrooms • Modern Kitchen and Bathroom • No onward Chain • Garage • Lease Hold • EPC Grade E



This generously proportioned two double bed roomed ground floor apartment offers a great investment opportunity and is available to move in from the end of September. The apartment is located in a convenient residential location and provides well planned accommodation.

Council Tax band: B

Tenure: Leasehold

EPC Energy Efficiency Rating: E

EPC Environmental Impact Rating: E



- Two Double Bedrooms
- Modern Kitchen and Bathroom
- No onward Chain
- Garage
- Lease Hold
- EPC Grade E



GROUND FLOOR
722 sq.ft. (67.1 sq.m.) approx.

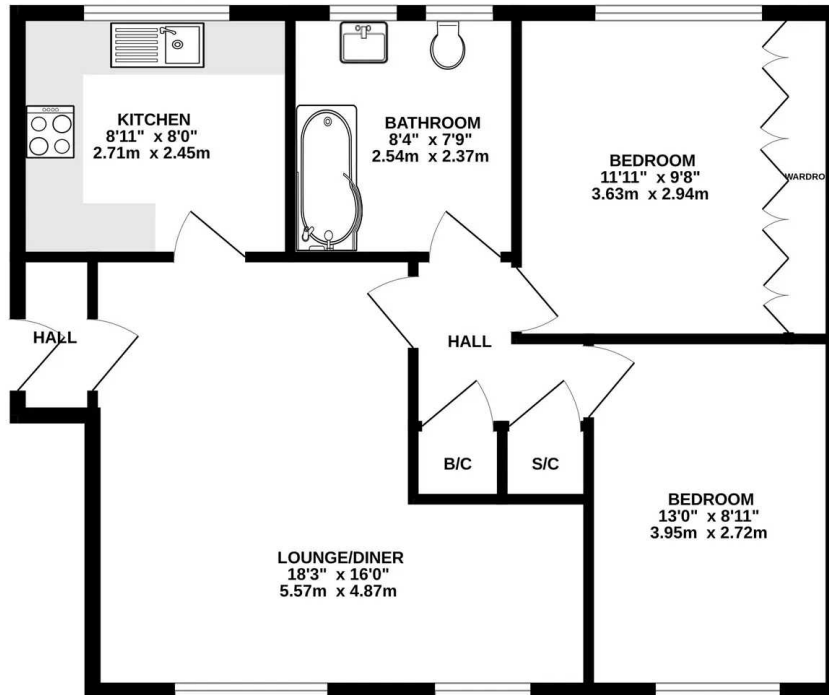

TOTAL FLOOR AREA : 722 sq.ft. (67.1 sq.m.) approx.
Whilst every attempt has been made to ensure the accuracy of the floorplan contained here, measurements of doors, windows, rooms and any other items are approximate and no responsibility is taken for any error, omission or mis-statement. This plan is for illustrative purposes only and should be used as such by any prospective purchaser. The services, systems and appliances shown have not been tested and no guarantee as to their operability or efficiency can be given.
Made with Metropix ©2024.

This generously proportioned two double bed roomed ground floor apartment offers a great investment opportunity and is available to move in from the end of September. The apartment is located in a convenient residential location and provides well planned accommodation.

This ground floor apartment is located in a quiet residential development within walking distance of local shops and amenities. Close to Bramhall Park and approximately a 15 minute walk to Bramhall train station. Generously proportioned and well planned throughout the accommodation offers two double bedrooms the master with fitted wardrobes, spacious living room and a modern kitchen and bathroom.

There is ample car parking within the development and the property has the advantage of having its own private garage. This apartment would make an ideal investment opportunity and therefore an early inspection is highly recommended.



