

86 Dolphin Quays

The Quay
Poole, Dorset
BH15 1HH



86 Dolphin Quays

The Quay
Poole, Dorset
BH15 1HH

Offers in excess of £950,000

Located in the prestigious Dolphin Quays development on Poole Quay, this three-bedroom triplex penthouse offers generous living space, luxury finishes and spectacular views across Poole Harbour and Brownsea Island.

Summary of Accommodation

Prestigious waterside development on Poole Quay

Breathtaking panoramic views across Poole Harbour and Brownsea Island

Marble-lined entrance foyer with concierge

Secure, on-site multi-storey car park with 2 spaces and bike storage

Access to a wide range of cafés, restaurants & boutique shops

Ferry connections to Brownsea Island and Sandbanks

Concierge and 24-Hour Security

3 Double Bedrooms, 2 with en-suites

4 good size balconies





This standout property benefits from extensive sun terraces, multiple balconies and bright, well-planned interiors across three floors.

The entrance level features a spacious hallway with a large cupboard. The principal bedroom is a generously sized double room with fitted wardrobes and patio doors opening onto a private sun terrace with panoramic harbour views. This bedroom also benefits from a stylish en-suite bathroom with an oversized bath.

Bedroom two is another large double room with fitted wardrobes and an en-suite bathroom featuring both a bath and separate shower. Sliding doors lead to a private balcony with beautiful views over the water.

Also on this level is bedroom three - a well-proportioned double with dual-aspect windows, along with a separate family bathroom finished with a modern white suite.



Upstairs, the main living area includes a recently fitted Miele kitchen with high-end integrated appliances, white Silestone worktops, inset spotlights and under-unit lighting. This leads into a spacious reception room with full-height glazing and direct access to the large, decked roof terrace - an ideal space for entertaining or relaxing while enjoying the exceptional views.

An oak staircase leads to the mezzanine level, which offers a second reception space or home office area and provides access to a further private balcony overlooking the harbour.

The property also has two secure parking spaces and access to a secure bike store.

This is a rare opportunity to own a spacious and beautifully finished penthouse in one of Poole's most desirable locations.

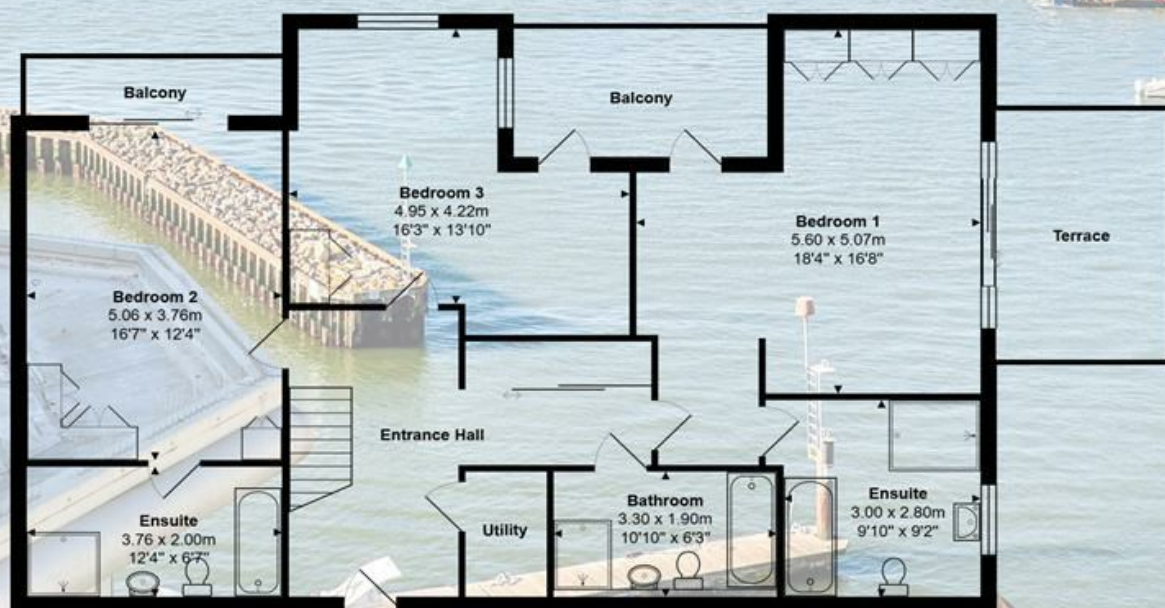
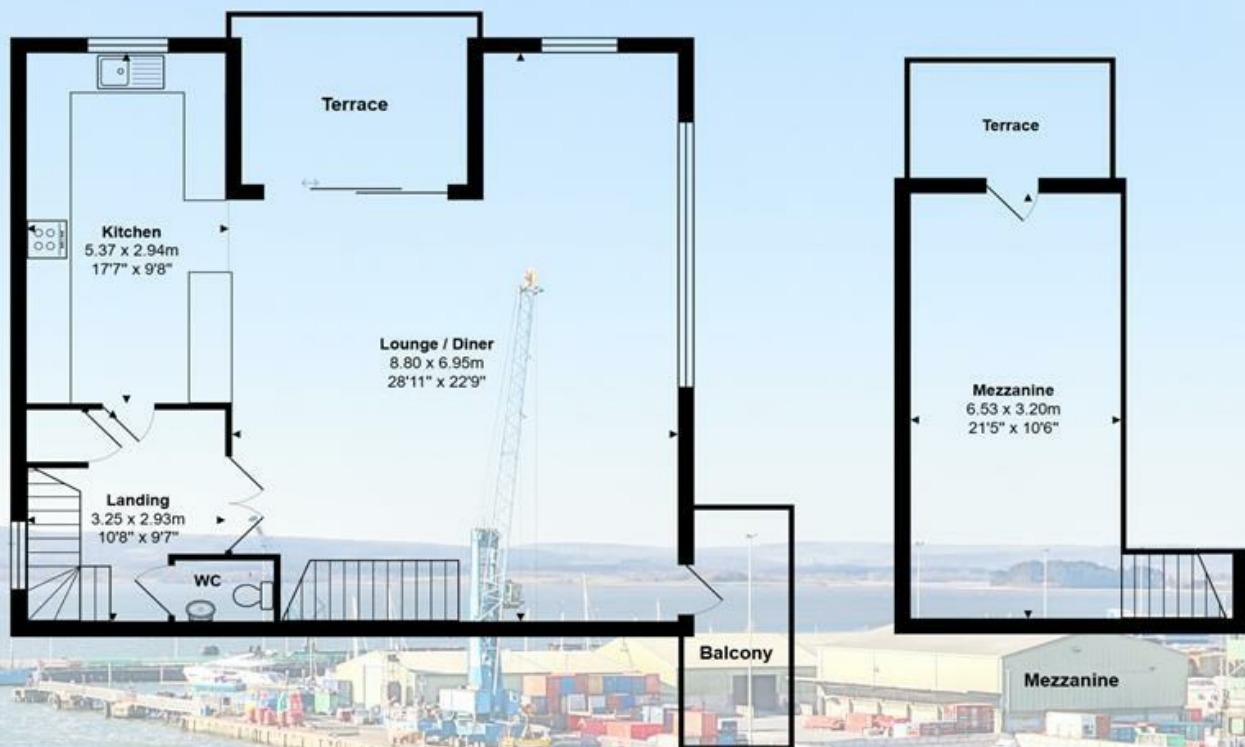

Total Area: 204.1 m² ... 2197 ft² (excluding balcony, terrace)

All measurements are approximate and for display purposes only

Lloyds Property Group

PROPERTY NAME

86 Dolphin Quays

LOCATION

BH15 1HH

TOTAL FLOOR AREA

2197.00 sq ft

COUNCIL TAX

Band E BCP (Poole)

VIEWING ARRANGEMENTS

Telephone: +44 (0) 1202 708044

Email: enquiries@lloydspropertygroup.com

Ref: 3609

Monday - Friday 09:00 - 18:00

Saturday 09:00 - 16:00

Sunday By appointment only

Illustration for identification purposes only, measurements are approximate, not to scale