

**7 Cliveden**  
36 The Avenue  
Branksome Park, Poole, Dorset  
BH13 6HL





# 7 Cliveden

36 The Avenue

Branksome Park, Poole, Dorset

BH13 6HL

£599,950

A spacious 4 bedroom townhouse set in landscaped grounds in the popular Branksome Park area of Poole, situated close to the day to day amenities of Canford Cliffs and Westbourne villages which include a great selection of bistros, gastro pubs, coffee shops and more.

## *Summary of Accommodation*

4 bedroom Mews townhouse

Private wrap around garden

2 allocated parking spaces

Additional visitor parking

Short distance to Canford Cliffs & Westbourne

Close to beach

Vacant possession







Embark on a new chapter of living in the sought after Clieveden development on The Avenue in Branksome Park. This spacious four bedroom townhouse is arranged over three floors and allows you to enjoy a spacious interior, three en-suite bathrooms, classic finishes and a private wrap around garden oasis in which to enjoy private entertainment or a quiet beverage.

Just minutes away you have the picturesque Branksome beach and the vibrant high streets of both Westbourne and Canford Cliffs which include a great selection of bistros, gastro pubs, coffee shops and more.

You will find plenty of beautiful walks across the many paths and Chines of Branksome Park on your walks down to the sea, as you explore the seven miles of award winning beaches along the coastline.



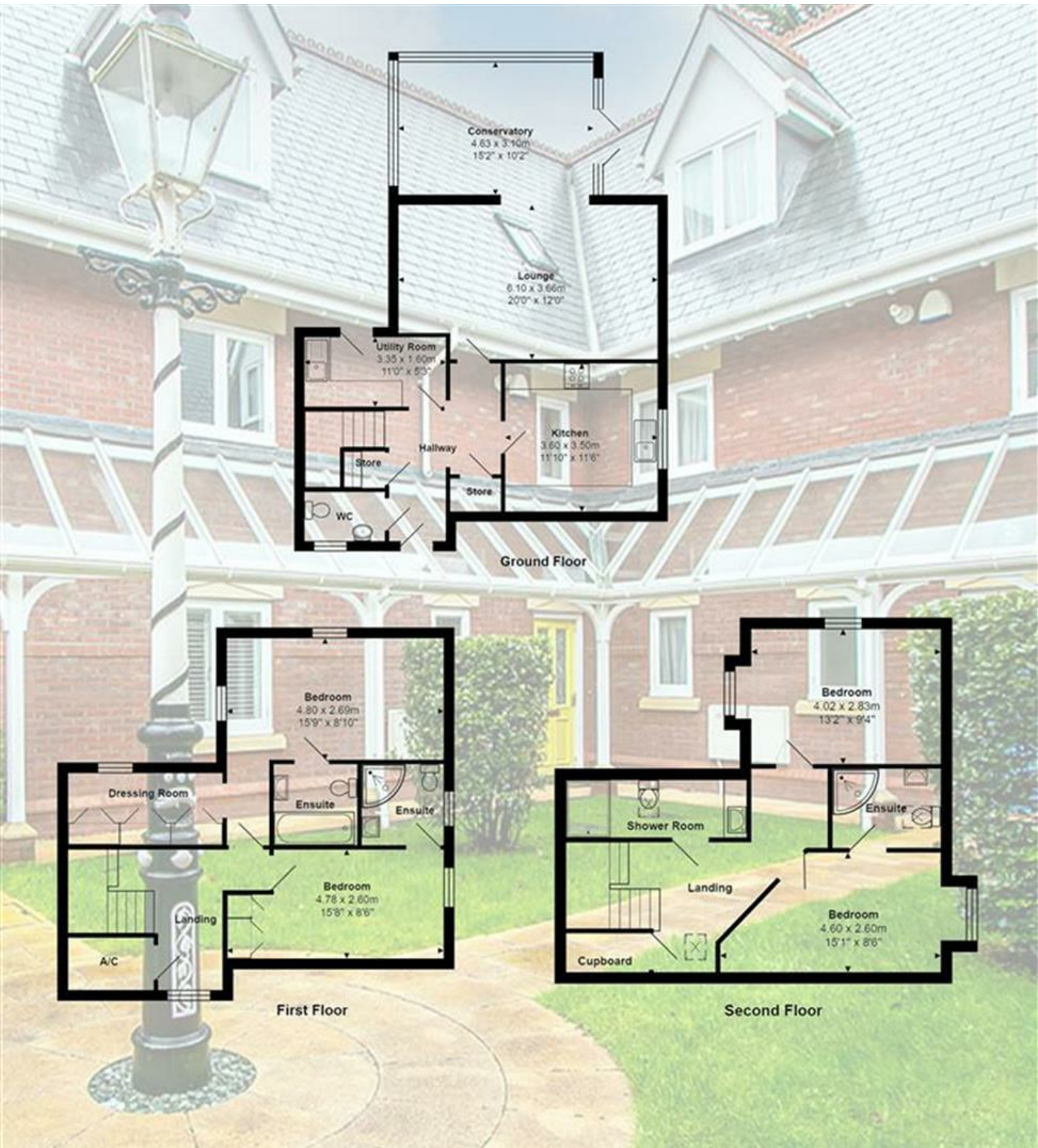

## Lloyds Property Group

PROPERTY NAME

7 Clieveden

LOCATION

BH13 6HL

TOTAL FLOOR AREA

1801.00 sq ft

COUNCIL TAX

Band F BCP (Poole)

VIEWING ARRANGEMENTS

Telephone: +44 (0) 1202 708044

Email: [enquiries@lloydspropertygroup.com](mailto:enquiries@lloydspropertygroup.com)

Ref: 3521 RE

Monday - Friday 09:00 - 18:00

Saturday 10:00 - 16:00

Sunday By appointment only

*Illustration for identification purposes only, measurements are approximate, not to scale*