

Flat 10 Carina Court

137-139 Banks Road
Sandbanks, Poole
Dorset BH13 7QQ



Flat 10 Carina Court

137-139 Banks Road
Sandbanks, Poole
Dorset BH13 7QQ

Price Guide £1,400,000

Situated on the world famous Sandbanks Peninsula this fully refurbished second floor apartment offers breathtaking water views and would make an ideal main of holiday home.

Summary of Accommodation

3 double bedrooms (all en-suite)

Kitchen/breakfast room

Large balcony with sea views

Private beach hut

Triple garage plus parking space

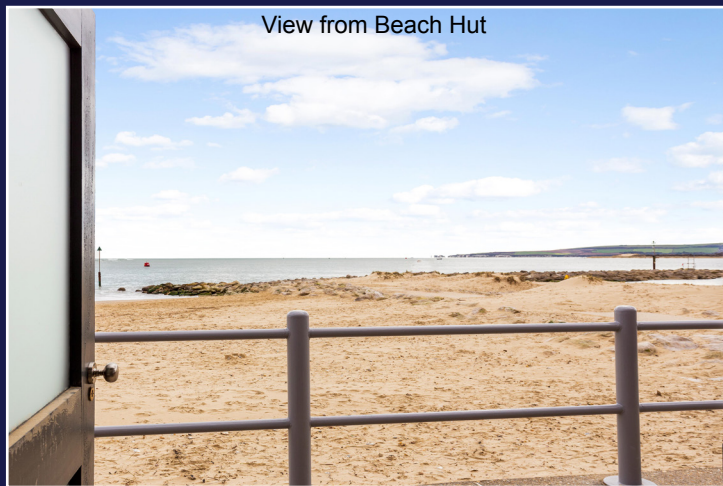



The well planned accommodation comprises three double bedrooms all with luxurious en-suites, with the main and second bedroom having fitted wardrobes. There is also a separate guest w/c.

The bright and spacious open plan living/dining room benefits from large windows capturing the beach backdrop. There is also a generous sized covered balcony accessed from the dining area via bi-folding doors.

The high end kitchen/breakfast room has a plethora of high quality integrated appliances, stone worksurface and feature window giving water views. There is ample storage, with a separate inner hallway with fitted units and an additional cloaks cupboard in the hallway.

In the development you will find an undercroft parking space located in front of the electrically operated garage door, beyond this is the triple length garage with electric car parking point.

Located to the rear of the development, adjoining the sand of the world famous Sandbanks beach is the private lockable beach hut, outside shower and terrace area.

With the interior having been tastefully designed by the current owner with hand picked furnishings, this apartment will make an ideal main or holiday home for those wishing to escape the city and reside by the sea.

Located within a short distance of Canford Cliffs village and Lilliput amities, the Sandbanks Peninsula offers an array of Blue Flag sandy beaches and stunning and picturesque views. towards Old Harry Rocks and the Purbecks.

Approximate Area = 136.0 sq m / 1464 sq ft
Including Limited Use Area (0.9 sq m / 9 sq ft)

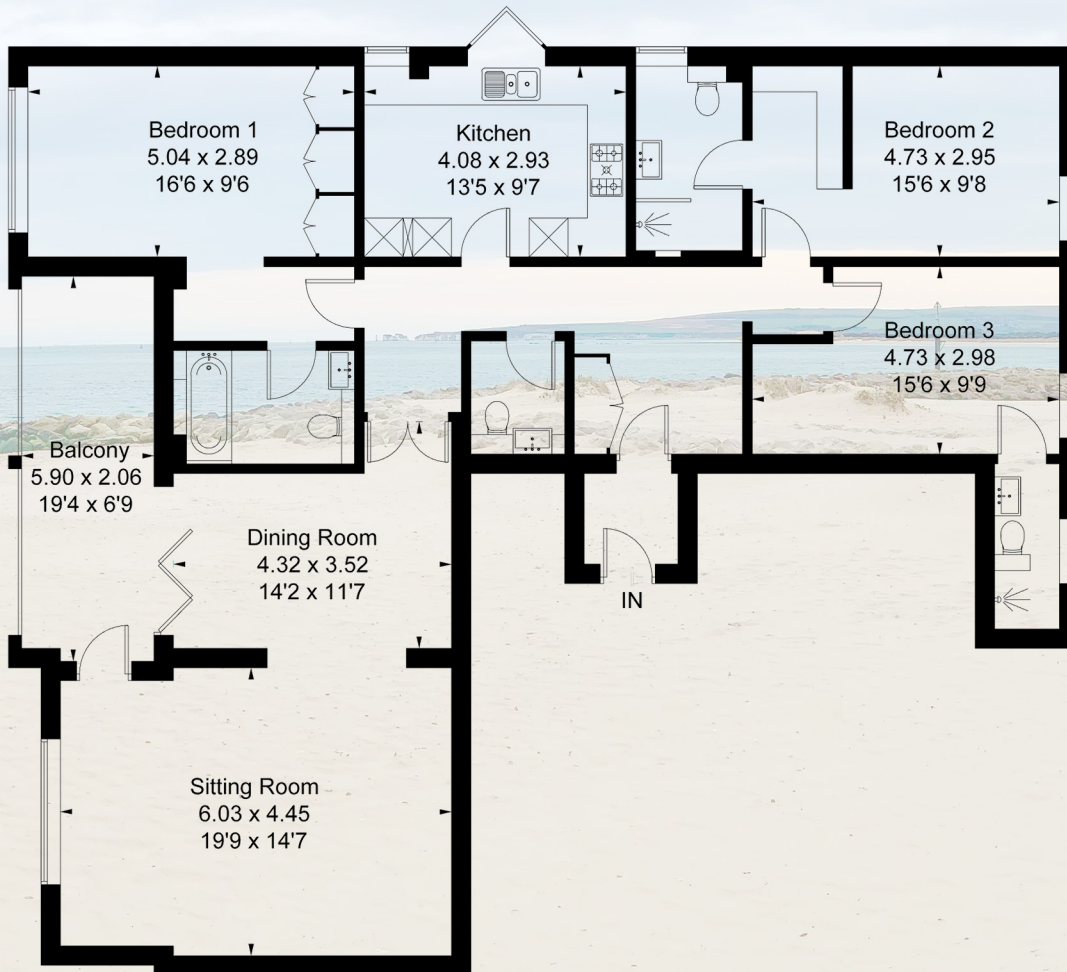

Ground Floor

Surveyed and drawn in accordance with the International Property Measurement Standards (IPMS 2: Residential)
fourwalls-group.com 313950

Lloyds Property Group

PROPERTY NAME

Flat 10 Carina Court

LOCATION

Sandbanks BH13 7QQ

APPROXIMATE MEASUREMENTS

Floor Area = 136.0 sq m / 1464 sq ft

Incl Limited Use Area (0.9 sq m / 9 sq ft)

VIEWING ARRANGEMENTS

Telephone: +44 (0)1202 708044

Email: enquiries@lloydspropertygroup.com

Council Tax Band = BCP (Poole) G

Maintenance = £2861 paid every 6 months

Illustration for identification purposes only, measurements are approximate, not to scale