



hizzy
property

www.hizzyproperty.co.uk



Shalem Newbourne Road, Waldringfield, IP12 4PS

Guide price £390,000

About the property

A three bedroom extended detached bungalow with a generous plot approaching 0.2 of an acre (subject to survey), a double garage, various outbuildings/workshop and plenty of parking to the side including space for a caravan/motor home. It's fair to say that the property would benefit from further improvement and therefore offers a good potential. The living space includes a entrance porch, dining room, living room with wood burner, conservatory, kitchen, utility, shower room and three bedrooms.

Outside

The gardens comprise of various lawned area's and a timber decking area to the rear. There is a large summer

house with covered area ideal for outside dining and a BBQ. At the opposite end of the garden is a compost/wood storage area and access to the garage and workshops.

Useful info

The property has mains electric with the heating being oil fired via radiators (not tested by the agents)..**The property has its own cesspit for drainage and the water is obtained via an underground well which serves three properties**. The property has a band D council tax rating with the local authority being East Suffolk Council, East Suffolk House Station Road Melton Woodbridge IP12 1RT. The What3words location is ///hacksaw.circling.require. Broadband Speed: Up to 72 mbps (Source Ofcom) and Mobile Network Coverage: EE, O2, Vodafone and Three outdoor coverage (Source Ofcom).





hizzy
property

- Extended Detached Bungalow
- Plenty of Parking to the side
- Scope for Further Improvement
- Total Plot Approaching 0.2 Acre (sts)
- Space for Caravan/Motor Home
- Three Reception Rooms
- Double Garage and Outbuildings
- Three Bedrooms
- Shower Room & Utility





hizzy
property

Ground Floor

Approx. 88.0 sq. metres (946.7 sq. feet)

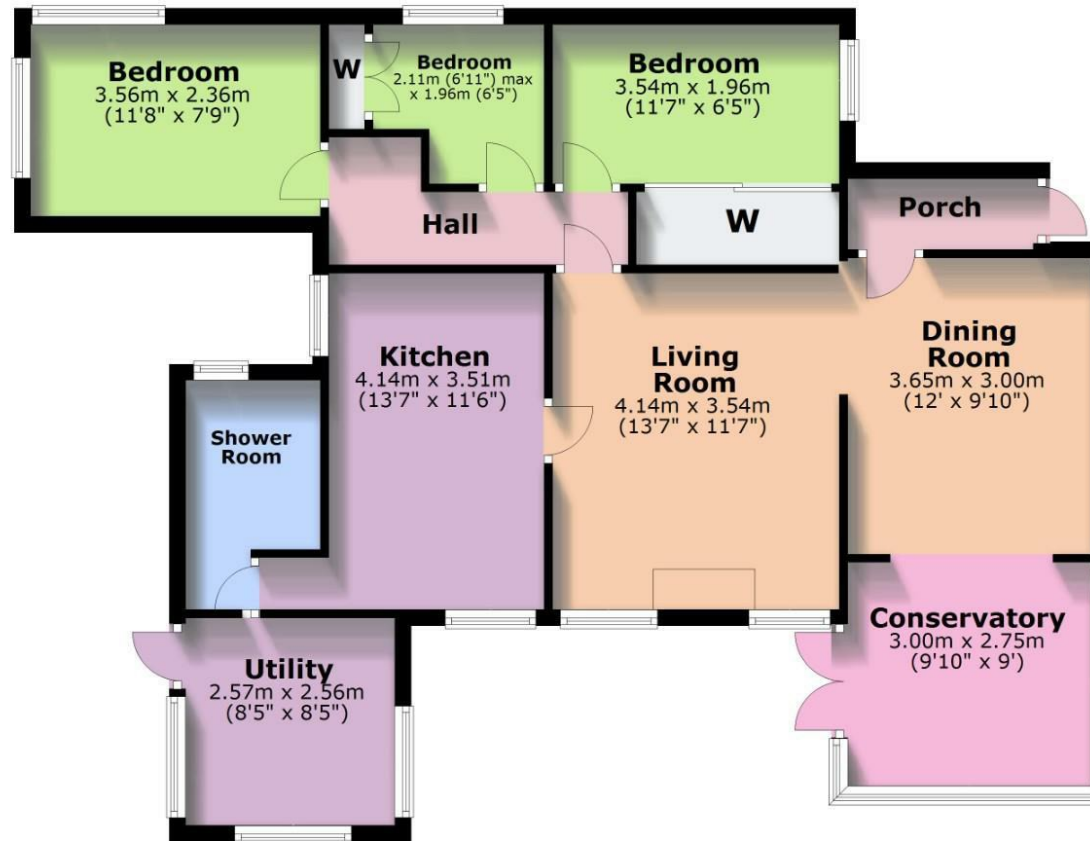

Total area: approx. 88.0 sq. metres (946.7 sq. feet)

The floor plan is intended as a guide only.
Plan produced using PlanUp.

EPC

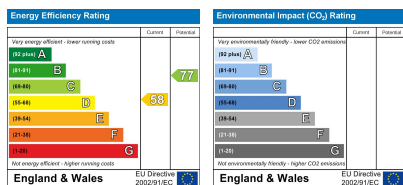

These particulars, whilst believed to be accurate are set out as a general outline only for guidance and do not constitute any part of an offer or contract. Intending purchasers should not rely on them as statements of representation of fact, but must satisfy themselves by inspection or otherwise as to their accuracy. No person in this firm's employment has the authority to make or give any representation or warranty in respect of the property.



hizzy
property

01473 875101
hello@hizzyproperty.co.uk