



12 Pennsylvania Road, Torquay - TQ1 1NX

Guide Price £199,950





12 Pennsylvania Road

Torquay, Torquay

Calling all first time buyers/investors, is this well presented and good sized three bedroom terraced house, with generous sized rooms, low maintenance garden in a popular residential location...

Council Tax band: B

Tenure: Freehold

EPC Energy Efficiency Rating: C

EPC Environmental Impact Rating: G

- Located within a popular residential area
- 2 Spacious double bedrooms
- Front and rear courtyard style gardens
- Generous sized lounge / dining room
- Bright and modern bathroom
- Study Room
- On street parking
- Close To Torquay Town Centre
- EPC- D



12 Pennsylvania Road

Torquay, Torquay

Convenience defines the area with a variety of amenities nearby, including Brewery Park, Plainmoor Swimming Pool, and various schools. Nestled in Ellacombe, near Babbacombe, residents enjoy easy access to numerous shops and facilities in Torquay town centre, just a short stroll away. Whether rain or shine, Torquay's covered Fleet Walk and Union Square offer an array of high street and boutique shops. Union Street boasts a diverse selection of establishments, while the nearby harbour and promenade host an assortment of eateries and bars.

Absolute Sales & Lettings

Absolute Sales & Lettings Ltd, 13 Ilsham Road - TQ1 2JG

01803 214214

torquay@movewithabsolute.co.uk

movewithabsolute.co.uk/



ABS

Ground Floor

Approx. 43.0 sq. metres (462.4 sq. feet)

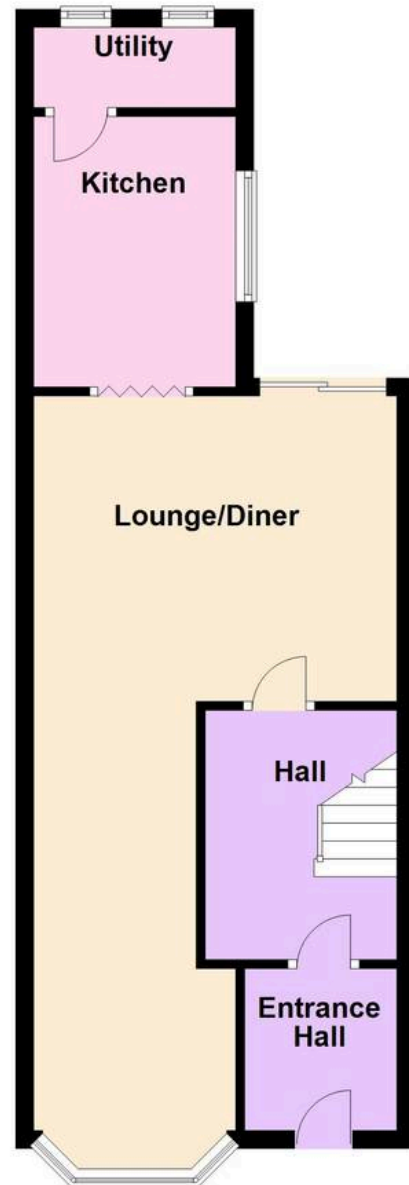

First Floor

Approx. 43.8 sq. metres (471.2 sq. feet)



Total area: approx. 86.7 sq. metres (933.6 sq. feet)

