

# Fletcher & Company

6 Yew Tree Avenue, Ockbrook, DE72 3TB

---

Offers Around £265,000

Freehold

---



- Detached Residence in Popular Location
- No Upward Chain
- Requires Modernisation
- Double Glazing & Gas Central Heating
- Entrance Hall
- Through Lounge/Diner & Fitted Kitchen
- Three First Floor Bedrooms, Shower Room & Separate WC
- Enclosed Rear Garden
- Detached Garage
- Driveway





## Summary

---

Three bedroom detached residence sold with the benefit of no upward chain in the popular village of Ockbrook.

This is an opportunity to acquire a realistically priced three bedroom detached residence located in a quiet cul-de-sac in Ockbrook. The property is sold with the benefit of double glazing and gas central heating featuring entrance hall, through lounge/dining room, fitted kitchen, three first floor bedrooms, shower room and separate WC.

The property is set back behind a well stocked fore-garden with adjacent driveway giving access to a detached single garage. To the rear of the property is an enclosed lawned garden with patio.

# F&C

### **The Location**

Ockbrook is a popular village east of Derby city centre, just off the A52, offering access to Derby and Nottingham. The village affords a sought-after primary school, a selection of pubs, café, cricket ground and pleasant walks in the surrounding open countryside. Easy access to neighbouring Borrowash offers a further range of amenities.

### **Accommodation**

#### **Ground Floor**

##### **Entrance Hall**

13'2" x 6'0" (4.02 x 1.84)

Double glazed entrance door provides access into the entrance hall with central heating radiator, staircase leading to the first floor and double glazed window to the side.

### Through Lounge/Dining Room

23'11" x 11'2" (7.31 x 3.42)

With a wall mounted gas fire, two central heating radiators, double glazed window to the front and sliding patio door opening onto the garden.



### **Fitted Kitchen**

10'5" x 8'2" (3.18 x 2.50)

With granite effect worktops, inset sink unit with tiled surrounds, fitted base cupboards and drawers with complementary wall mounted cupboards, inset four plate electric hob with built-in oven beneath, appliance spaces suitable for a fridge/freezer, washing machine and dishwasher, double glazed door and window to the rear.



### **First Floor**

#### **Landing**

A semi-galleried landing with access to loft space, double glazed window to the side and doors to three bedrooms, shower room and separate WC.

#### **Bedroom One**

12'9" x 10'2" (3.89 x 3.11)

With central heating radiator and double glazed window to the front with impressive open views.



#### **Bedroom Two**

10'11" x 10'0" (3.35 x 3.07)

With central heating radiator and double glazed window to the rear.



### **Bedroom Three**

9'2" x 7'1" (2.80 x 2.17)

With central heating radiator and double glazed window to the front, again with views.



### **Shower Room**

7'1" x 5'5" (2.17 x 1.66)

With double shower cubicle, vanity unit with wash handbasin and cupboards beneath, central heating radiator, airing cupboard and double glazed window to the rear.



### **Separate WC**

3'9" x 2'5" (1.15 x 0.75)

With low flush WC and double glazed window to the side.

## Outside

The property occupies an elevated position set back from Yew Tree Avenue behind a well stocked fore-garden with adjacent driveway providing off road parking and access to a detached single garage.

To the rear of the property is a lawn with patio area, greenhouse and herbaceous borders containing plants and shrubs.



Council Tax Band C - Erewash

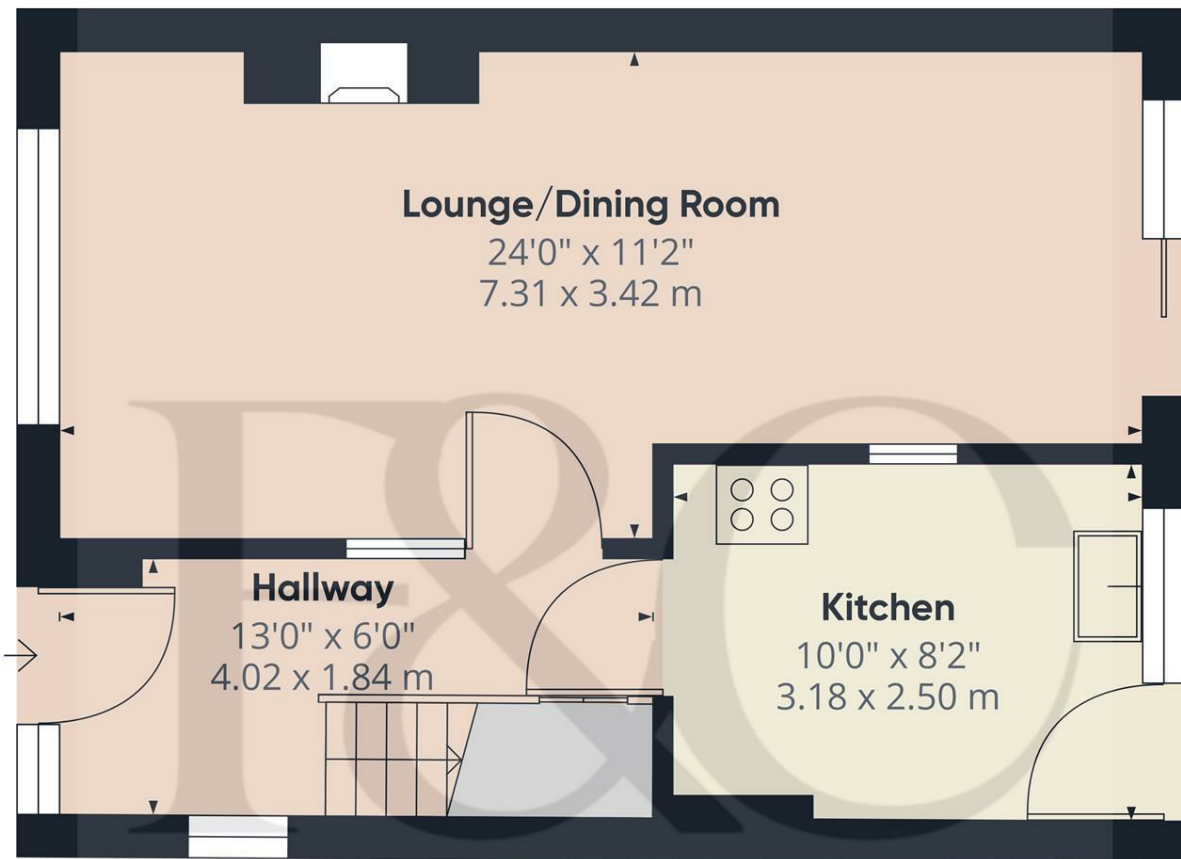

Floor 0

Approximate total area<sup>(1)</sup>  
414.41 ft<sup>2</sup>  
38.5 m<sup>2</sup>

(1) Excluding balconies and terraces

While every attempt has been made to ensure accuracy, all measurements are approximate, not to scale. This floor plan is for illustrative purposes only.

GIRAFFE360

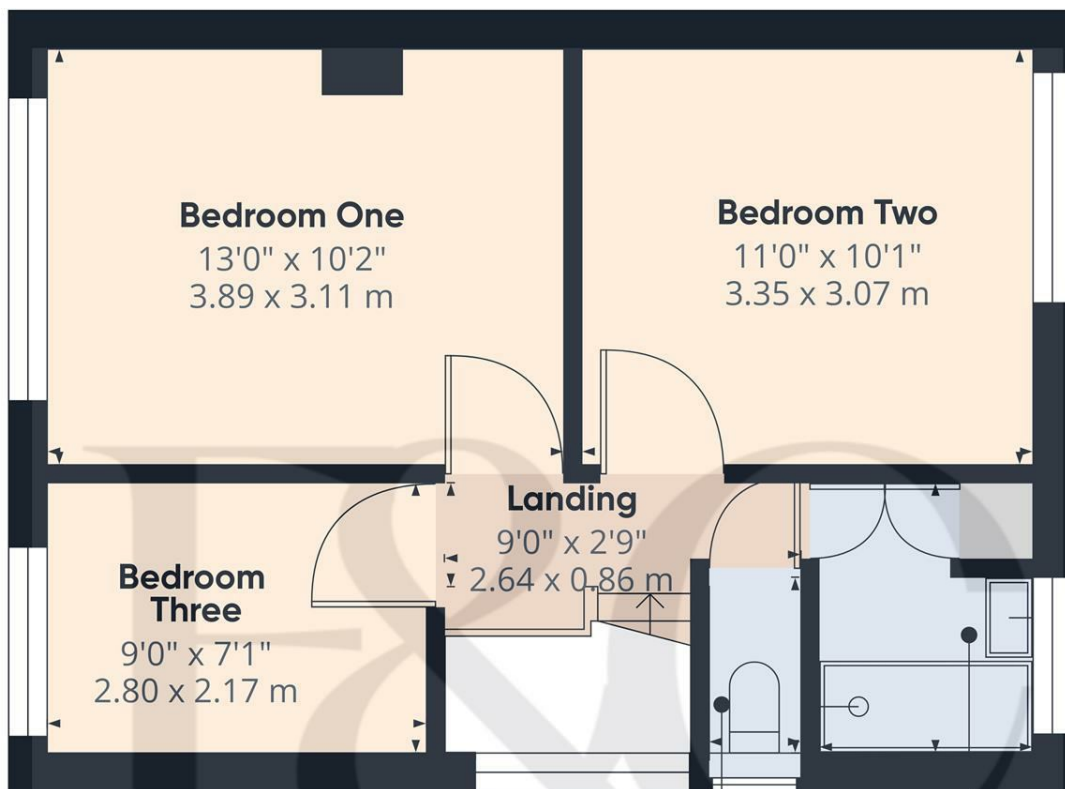

Floor 1

Approximate total area<sup>(1)</sup>  
388.15 ft<sup>2</sup>  
36.06 m<sup>2</sup>

(1) Excluding balconies and terraces

While every attempt has been made to ensure accuracy, all measurements are approximate, not to scale. This floor plan is for illustrative purposes only.

GIRAFFE360





Duffield Office

Duffield House  
Town Street  
Duffield  
Derbyshire  
DE56 4GD

01332 843390  
duffield@fletcherandcompany.co.uk

Derby Office

15 Melbourne Court  
Millennium Way  
Pride Park  
Derby  
DE24 8LZ

01332 300558  
derby@fletcherandcompany.co.uk

Willington Office

3 The Boardwalk  
Mercia Marina  
Findern Lane  
Willington  
Derbyshire  
DE65 6DW

01283 241500  
willington@fletcherandcompany.co.uk

6 Yew Tree Avenue  
Ockbrook  
DE72 3TB

Council Tax Band: C  
Tenure: Freehold



### Energy Efficiency Rating

	Current	Potential
Very energy efficient - lower running costs		
(92 plus) <b>A</b>		
(81-91) <b>B</b>		<b>82</b>
(69-80) <b>C</b>		
(55-68) <b>D</b>	<b>56</b>	
(39-54) <b>E</b>		
(21-38) <b>F</b>		
(1-20) <b>G</b>		
Not energy efficient - higher running costs		
<b>England &amp; Wales</b>	EU Directive 2002/91/EC	