



GILSON GRAY

LAW • PROPERTY • FINANCE

2 MUIRFIELD STATION,
Gullane, East Lothian, EH31 2HY



Situated in the heart of Gullane, this four-bedroom detached house promises a relaxed coastal lifestyle. It is just a short walk from amenities, the local school, and transport links, and it is within easy reach of spectacular beaches. The exclusive property further benefits from modern interiors, including a quality kitchen and three washrooms; plus, it has private parking for two cars and a family-friendly rear garden, which is fully enclosed and with a southeast-facing aspect.

Extras: Integrated kitchen appliances to be included in the sale. Please note, no warranties or guarantees shall be provided in relation to any of the services, moveables, and/or appliances included in the price, as these items are to be left in a sold as seen condition.

FEATURES

- A bright and spacious detached house
- Situated in highly sought-after Gullane
- Modern interior design throughout
- Bright hall with storage and a WC
- Living room with a log-burning stove
- Modern kitchen and dining room
- Utility room with garden access
- Three double bedrooms
- One versatile single bedroom
- Modern en-suite shower room
- Family bathroom with overhead shower
- Excellent built-in storage
- Landscaped front and rear gardens
- Private driveway and integrated garage
- EPC Rating: C
- Council Tax Band: F







"A BRIGHT AND SPACIOUS
FOUR-BEDROOM DETACHED
HOUSE IN THE HIGHLY
SOUGHT-AFTER COASTAL
TOWN OF GULLANE"





EPC RATING:



COUNCIL TAX BAND:



VIEWINGS: by appointment with Gilson Gray on 01620 893 481

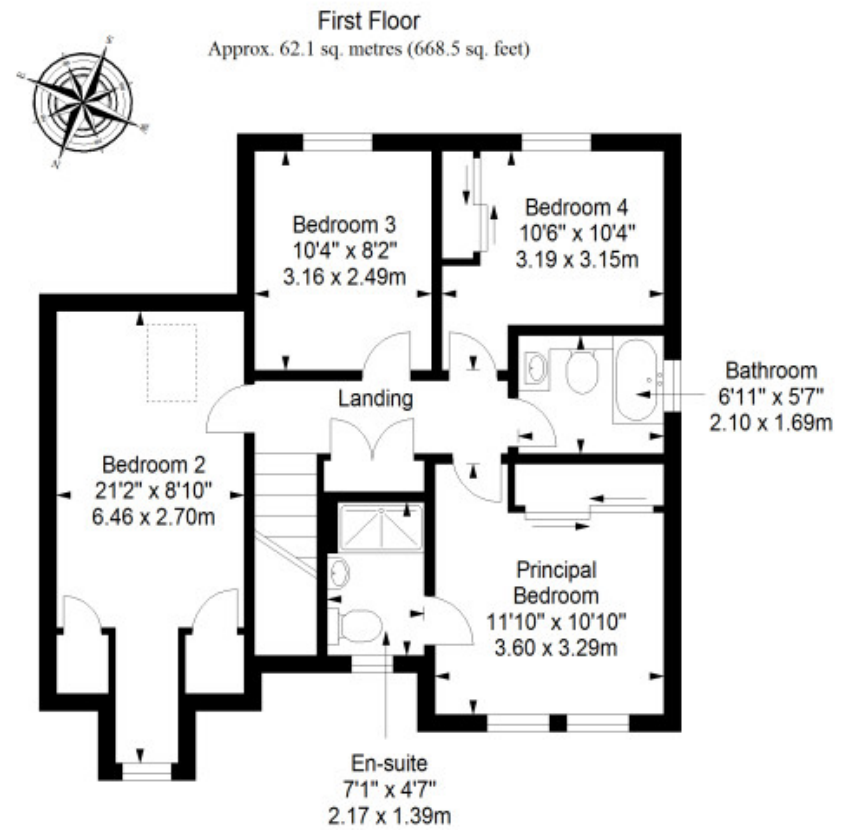
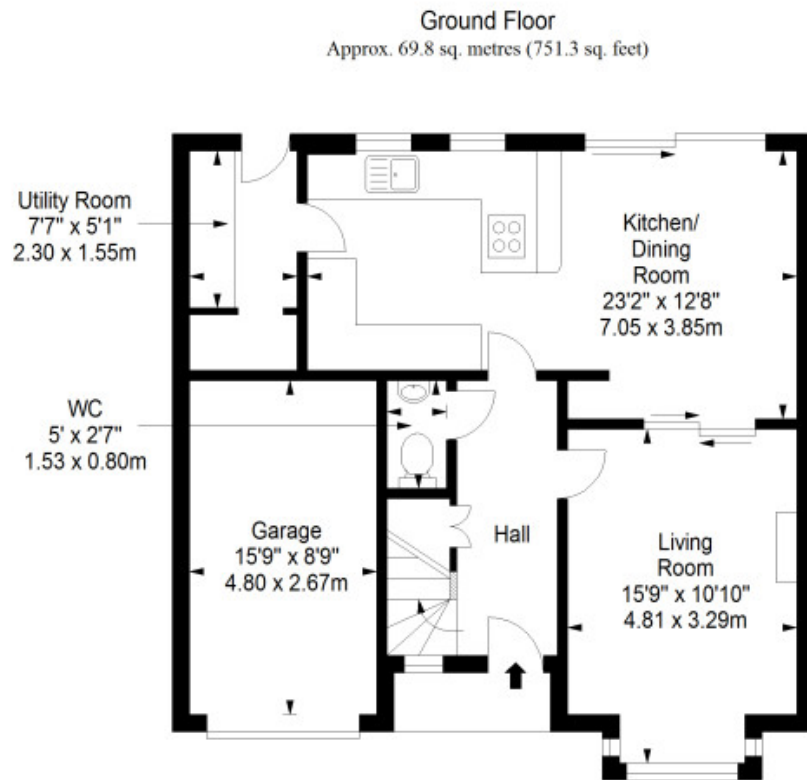

Total area: approx. 131.9 sq. metres (1419.8 sq. feet)



GILSONGRAY.CO.UK

EDINBURGH

29 Rutland Square
EH1 2BW
0131 516 5366



GLASGOW

160 West George Street
G2 2HQ
0141 530 2021



EAST LOTHIAN

33 Westgate
EH39 4AG
01620 893 481



DUNDEE

2 West Marketgait
DD1 1QN
01382 201 000



BORDERS

01890 880 008



@gilsongrayprop gilson gray property gilson gray property @gilsongrayprop

rightmove Zoopla.co.uk OnTheMarket

These particulars were prepared on the basis of our own knowledge of the local area and, in respect of the property itself, information supplied to us by our clients; all reasonable steps were taken at the time of preparing these particulars to ensure that all details contained in them were accurate. All statements contained in the particulars are for information only and all parties should not rely upon them as statements or representations of fact. In particular, (a) descriptions, measurements and dimensions, which may be quoted in these particulars are approximate only and (b) all references to conditions, planning permission, services, usage, constructions, fixtures and fittings and movable items contained in the property are for guidance only. Our clients may instruct us to set a closing date for offers at short notice and therefore if you wish to pursue interest in this property, you should immediately instruct your solicitor to note interest with us. Our clients reserve the right to conclude a bargain for the sale of the above subjects or any part thereof ahead of a notified closing date and will not be obliged to accept either the highest or indeed any offer for the above subjects or any part thereof. All measurements have been taken using a sonic tape and cannot be regarded as guaranteed given the limitations of the device. Services and/or appliances referred to in these particulars have not been tested and no warranty is given that they are in full working order.