



Asking Price £140,000
Aliwal Road, WHITTLESEY, Peterborough PE7 1UG



 2
Bedrooms

 1
Bathroom



Asking Price £140,000
Aliwal Road, WHITTLESEY, Peterborough PE7 1UG

TWO bedroom property as IDEAL starter home located in WHITTLESEY. The property comprises of: kitchen, lounge, double bedroom, single bedroom, bathroom. Outside enclosed courtyard garden with shed. The home has NO CHAIN and needs modernisation!

TWO bedroom property as IDEAL starter home located in WHITTLESEY. The property comprises of: kitchen, lounge, double bedroom, single bedroom, bathroom.

Outside enclosed courtyard garden with shed. The home has NO CHAIN and needs modernisation!

Lounge 11' 7" x 11' 2" (3.53m x 3.40m)

Double glazed uPVC window facing the front and a radiator.

Kitchen 10' 10" x 8' 10" (3.30m x 2.69m)

Double glazed uPVC window facing the rear, double glazed uPVC door to the rear, wall and base units with worktops and sink with mixer tap, part tiled walls. Space for appliances

First floor

Bedroom 13' 4" x 11' 8" (4.06m x 3.56m)

Double glazed uPVC window facing the front and a radiator.

Bedroom 7' 8" x 5' 1" (2.34m x 1.55m)

Double glazed uPVC window facing the rear and a radiator.

Bathroom

Heated towel rail, tiled splashbacks, close coupled WC, panelled bath with shower over bath and a pedestal sink.

Outside

Courtyard garden at the rear



Asking Price £140,000

Aliwal Road, WHITTLESEY, Peterborough PE7 1UG

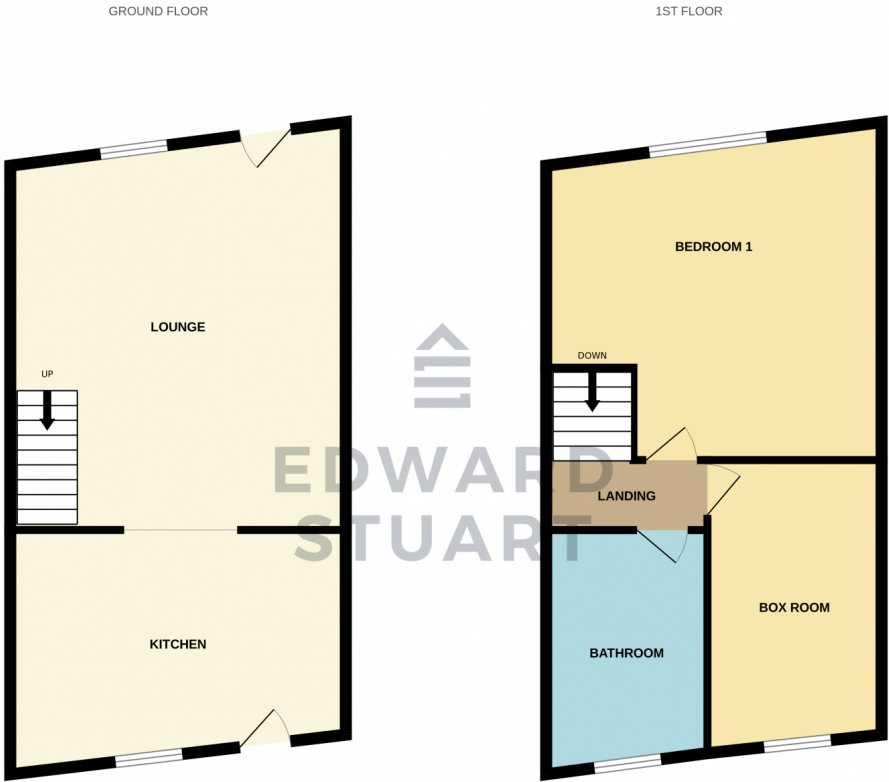

EDWARD
STUART

Whilst every attempt has been made to ensure the accuracy of the floorplan contained here, measurements of doors, windows, rooms and any other items are approximate and no responsibility is taken for any error, omission or mis-statement. This plan is for illustrative purposes only and should be used as such by any prospective purchaser. The services, systems and appliances shown have not been tested and no guarantee as to their operability or efficiency can be given.
Made with Metropix ©2023

Score	Energy rating	Current	Potential
92+	A		
81-91	B		87 B
69-80	C		
55-68	D	64 D	
39-54	E		
21-38	F		
1-20	G		

