



The Avenue, W13

LONG LET. This two bedroom apartment offers stylish accommodation which benefits from a modern interior and a great location close to local amenities.

- TWO DOUBLE BEDROOMS
- OPEN PLAN KITCHEN
- MODERN INTERIOR
- LARGE BALCONY
- CLOSE TO LOCAL TRANSPORT
- CLOSE TO LOCAL AMENITIES

£2,100

Dominion House

Approximate Gross Internal Area
710 sq ft - 66 sq m

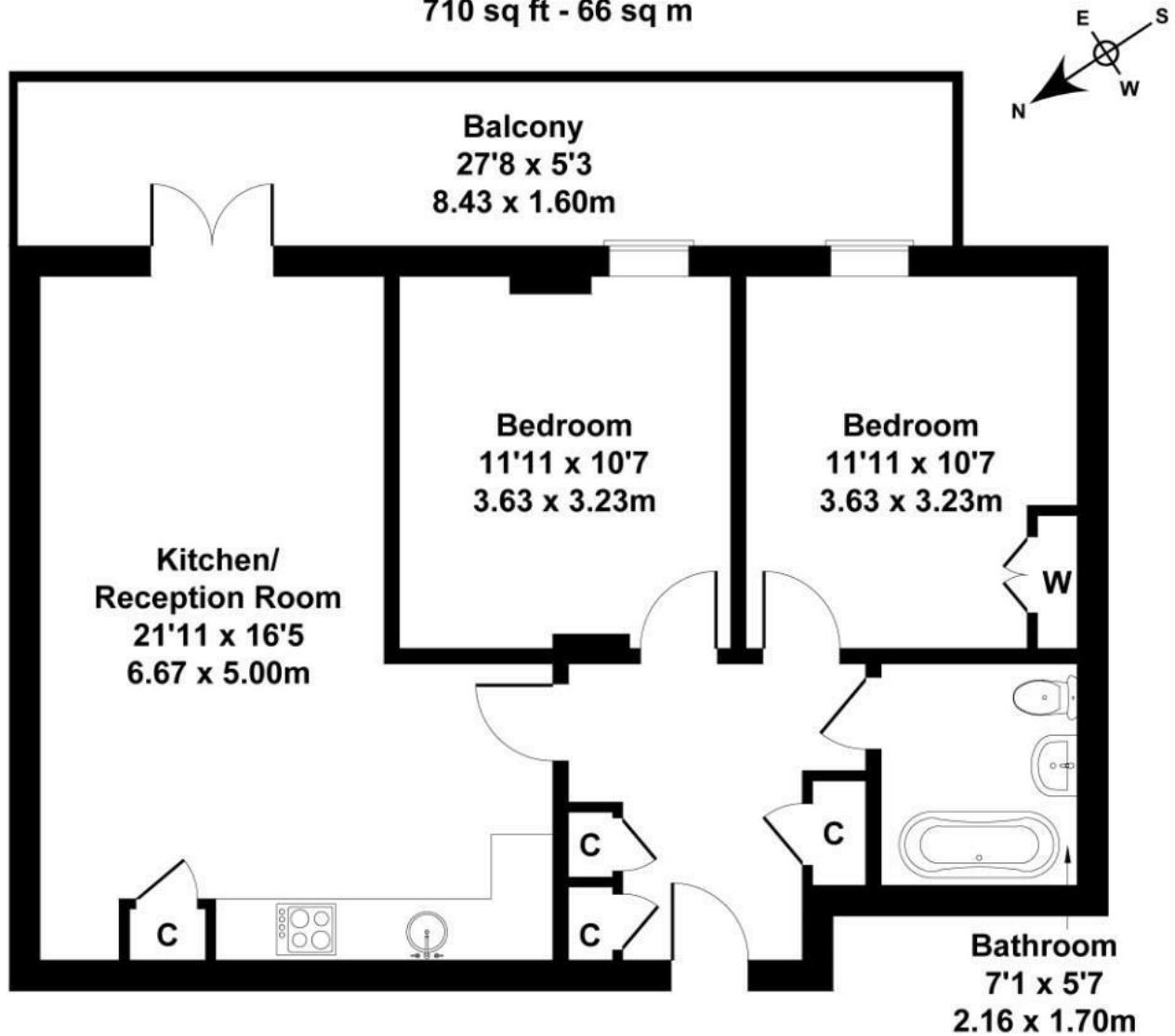

SECOND FLOOR

Not to Scale. Produced by The Plan Portal 2023
For Illustrative Purposes Only.

Energy Efficiency Rating		
	Current	Potential
Very energy efficient - lower running costs		
(92 plus) A		
(81-91) B		
(69-80) C	72	80
(55-68) D		
(39-54) E		
(21-38) F		
(1-20) G		
Not energy efficient - higher running costs		
England & Wales	EU Directive 2002/91/EC	