

Eagle Road, HA0

LONG LET Well located close to transport links and local amenities this stunning two bedroom apartment boasts a modern interior and a great location in the heart of Alperton.

- TWO DOUBLE BEDROOMS
- BRIGHT RECEPTION ROOM
- MODERN KITCHEN
- GOOD STORAGE
- PARKING
- GREAT LOCATION

£2,400 PCM

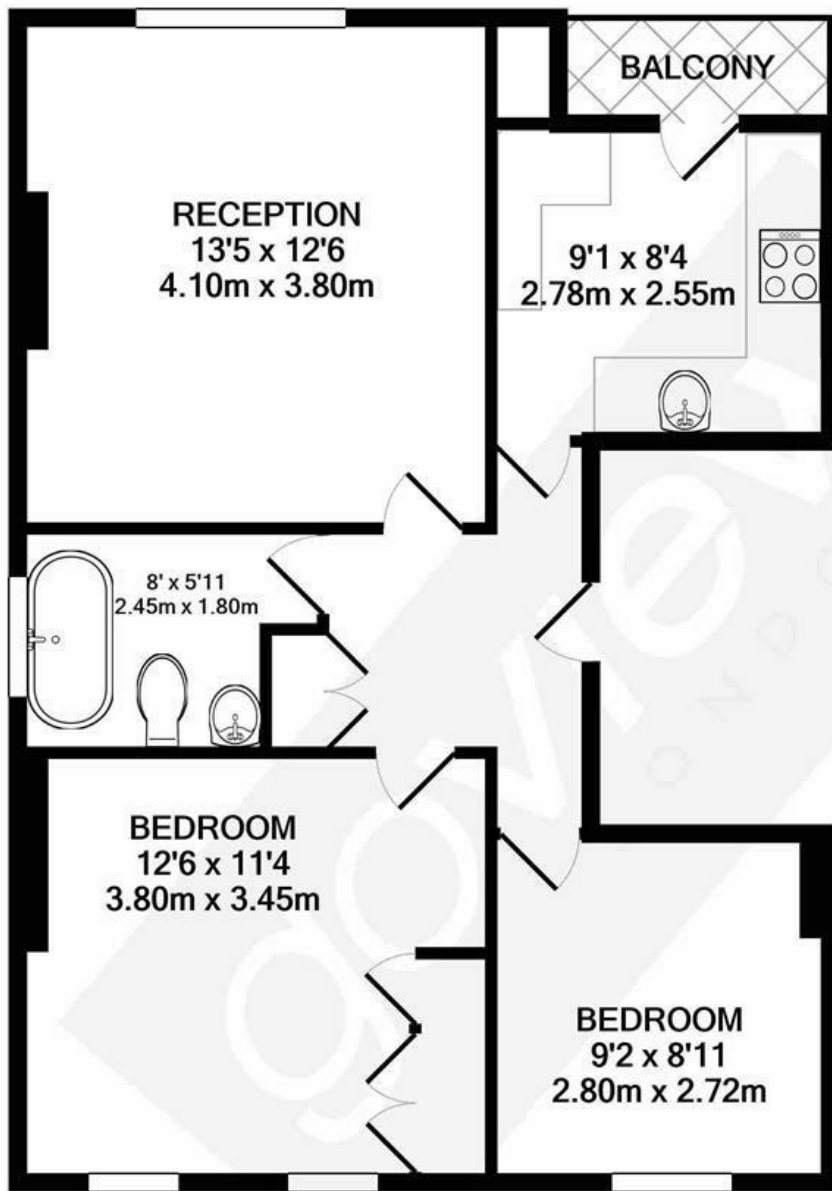

TOTAL APPROX. FLOOR AREA 561 SQ.FT. (52.2 SQ.M.)

Whilst every attempt has been made to ensure the accuracy of the floor plan contained here, measurements of doors, windows, rooms and any other items are approximate and no responsibility is taken for any error, omission, or mis-statement. This plan is for illustrative purposes only and should be used as such by any prospective purchaser. The services, systems and appliances shown have not been tested and no guarantee as to their operability or efficiency can be given

Made with Metropix ©2020

Energy Efficiency Rating		
	Current	Potential
<i>Very energy efficient - lower running costs</i>		
(92 plus) A		
(81-91) B		
(69-80) C		
(55-68) D		
(39-54) E		
(21-38) F		
(1-20) G		
<i>Not energy efficient - higher running costs</i>		
England & Wales	EU Directive 2002/91/EC	