



Pitshanger Lane, W5

LONG LET - Sharers accepted. Excellently located for amenities and transport links, this large three bedroom flat is set on the popular Pitshanger lane and offers generous living space and high-quality fixtures and fittings.

- GREAT FOR THREE SHARERS
- GREAT LOCATION
- CLOSE TO PITSHANGER PARK
- CLOSE TO LOCAL TRANSPORT
- SEPARATE KITCHEN
- CLOSE TO LOCAL AMENITIES

£2,495 PCM

Kenmure Mansions

Approximate Gross Internal Area
8*93 sq ft - 83 sq m

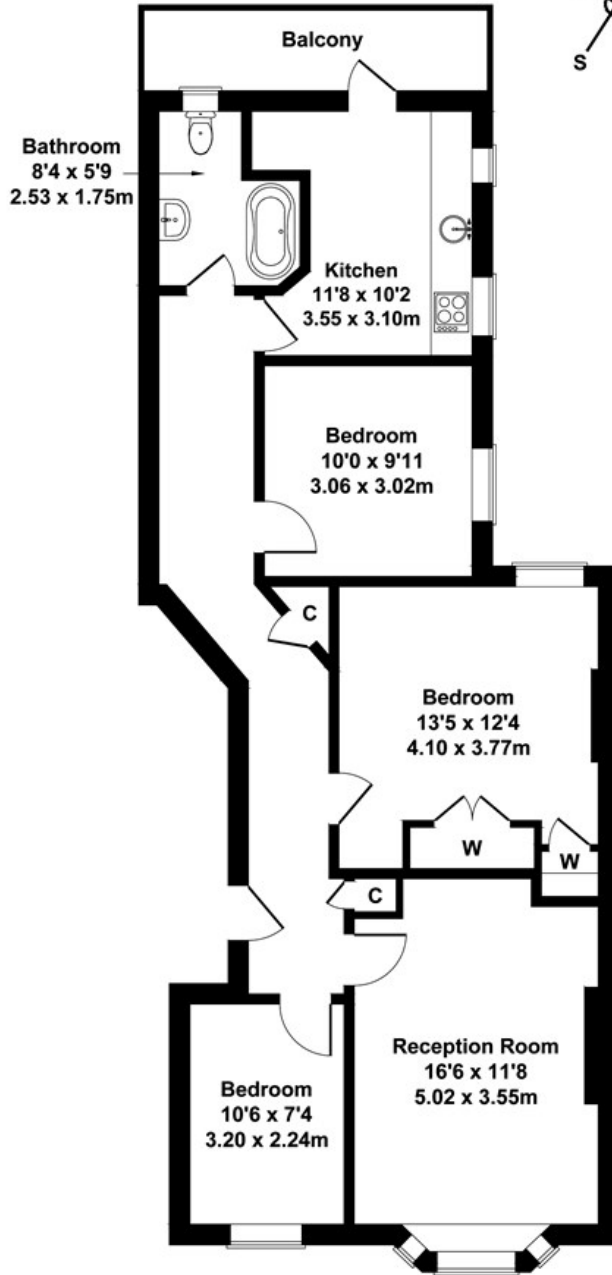
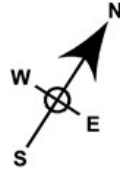

FIRST FLOOR

Not to Scale. Produced by The Plan Portal 2021
For Illustrative Purposes Only.

Energy Efficiency Rating		
	Current	Potential
<i>Very energy efficient - lower running costs</i>		
(92 plus) A		
(81-91) B		
(69-80) C		
(55-68) D		
(39-54) E		
(21-38) F		
(1-20) G		
<i>Not energy efficient - higher running costs</i>		
England & Wales	EU Directive 2002/91/EC	