

Maple View

Plot 6, Portfield View, Portfield, Haverfordwest SA61 1DY

- New Build Development
- Semi-Detached Three Bedroom House
- Driveway & Garage
- Edge of Town
- Turfed Garden with Planting Plan
- Three Storey
- Electric Heating / Solar Panels
- Available to Reserve Off-Plan
- Traditional Construction
- Optional Extras: Air Source Heat Pump & Solar Battery Storage

WE WOULD LIKE TO POINT OUT THAT OUR PHOTOGRAPHS ARE TAKEN WITH A DIGITAL CAMERA WITH A WIDE ANGLE LENS. These particulars have been prepared in all good faith to give a fair overall view of the property. If there is any point which is of specific importance to you, please check with us first, particularly if travelling some distance to view the property. We would like to point out that the following items are excluded from the sale of the property: Fitted carpets, curtains and blinds, curtain rods and poles, light fittings, sheds, greenhouses - unless specifically specified in the sales particulars. Nothing in these particulars shall be deemed to be a statement that the property is in good structural condition or otherwise. Services, appliances and equipment referred to in the sales details have not been tested, and no warranty can therefore be given. Purchasers should satisfy themselves on such matters prior to purchase. Any areas, measurements or distances are given as a guide only and are not precise. Room sizes should not be relied upon for carpets and furnishings.

www.mayfairoffice.co.uk tel: 020 7467 5330

COMPUTER-LINKED
OFFICES THROUGHOUT
WEST WALES



AND ASSOCIATED
MAYFAIR OFFICE IN
LONDON



Offers In Excess Of £240,000

12 Victoria Place, Haverfordwest, Pembrokeshire, SA61 2LP
Email: haverfordwest@westwalesproperties.co.uk
Telephone: 01437 762626



We Say...

The Portfield View Development is a residential cul-de-sac comprising 21 new build properties. The available plots offer a range of one, three, and four-bedroom detached and semi-detached properties, to be completed to a high specification.

Maple View, Plot 6, will be a three-bedroom semi-detached freehold house measuring approx 83.5 sqm, set over three floors, and is to be of standard construction. This forward-thinking property will be installed with efficient electric heating and solar panels with an optional backup battery providing reduced energy costs. The property will benefit from off-road parking for 2 cars and a garage, as well as a turfed garden.

Optional Air Source Heat Pump and optional Solar Panel Battery Storage unit.

The developer will offer the opportunity to reserve the property off-plan with a holding deposit and will offer the potential to upgrade the quality of materials and finishing if desired.

PLEASE NOTE THAT THE IMAGES PROVIDED ARE CGI AND ARE FOR ILLUSTRATIVE PURPOSES ONLY.

The market town of Haverfordwest has numerous facilities and amenities on offer, which include a good range of shops, retail parks, primary and secondary schools, sixth form college, hospital, mainline train station, leisure center/swimming pool, cinema, restaurants, pubs, etc.

The beautiful Pembrokeshire coast is only 6 miles to the southwest, at the long sandy beach of Broad Haven, and the famous surfing beach of Newgale 7.5 miles to the northwest. The famous Pembrokeshire Coast Path gives miles of wonderful walks on which to enjoy the stunning coastline, wildflowers, and bird life. See our website www.westwalesproperties.co.uk for our own TV Channel with Location Films of the area.

3 BED SEMI-DETACHED - 3 STOREY HOUSE

Client	Water Docks
Phase	Phase 1
Project	1st Floor
Architect	1st Floor
Drawn	1st Floor
Check	1st Floor
Date	1st Floor
Drawn	1st Floor
Check	1st Floor
Date	1st Floor
Drawn	1st Floor
Check	1st Floor
Date	1st Floor

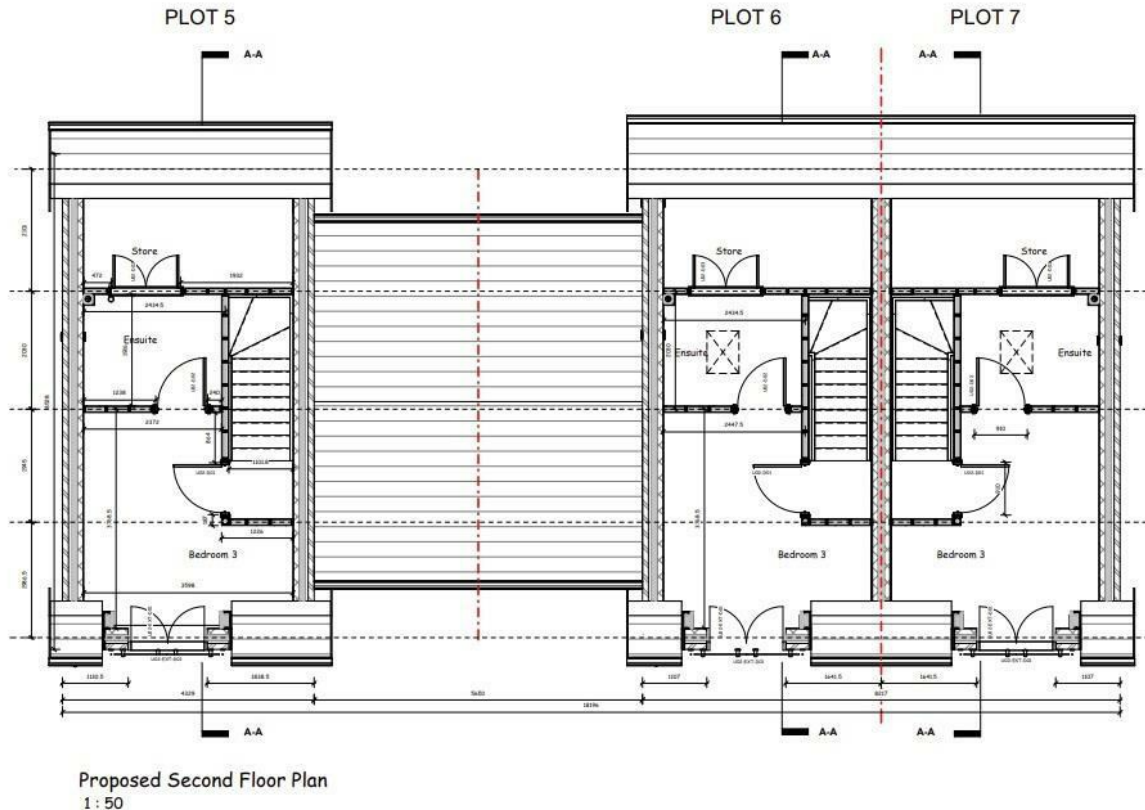

DIRECTIONS

From our Haverfordwest office, continue up High Street and at the traffic lights turn right onto the Portfield Road, go over the mini roundabout and continue along until you see the development on the left-hand side before the fork in the road. What3Words reference: flows.booth.points

GENERAL INFORMATION

VIEWING: By appointment only via the Agents.
TENURE: We are advised Freehold.
SERVICES: We have not checked or tested any of the services or appliances at the property.
HEATING: Electric heating and solar panels with optional backup battery
TAX: Band N/A

FACEBOOK & TWITTER
Be sure to follow us on Twitter: @ WWPProps
<https://www.facebook.com/westwalesproperties/>

AERIAL VIEW

