



3 Merino Gardens
, LONDON E1W 2DP

£4,500 Per Month

Local Authority **Tower Hamlets**
Council Tax Band **F**
EPC Rating

Approximate Gross Internal Area 848 sq ft - 79 sq m

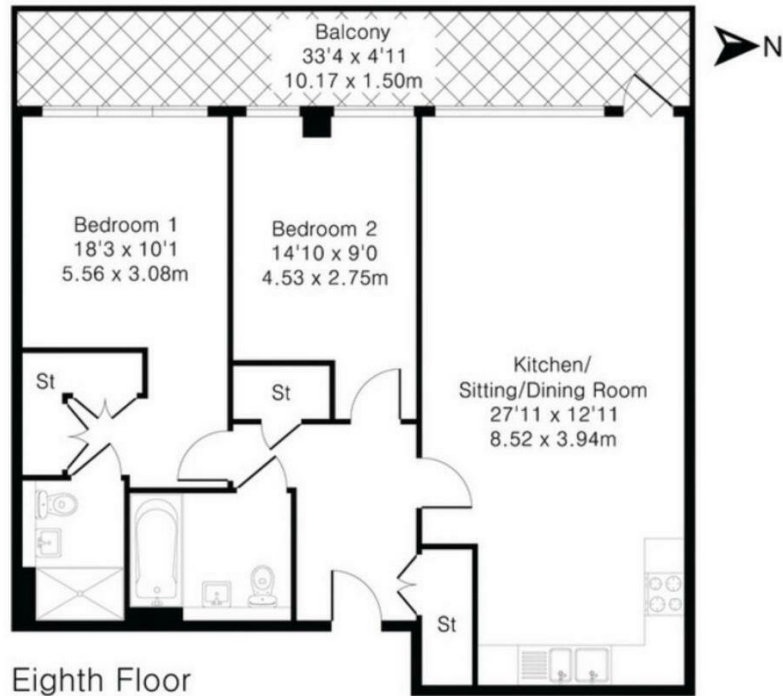

Eighth Floor

London Office Office
Spaces Victoria, 25 Wilton Road, Pimlico,
London, SW1V 1LW

Contact
0207 515 8885
XL@londonvictoriagroups.co.uk
www.londonvictoriagroups.co.uk

Agents Note: Whilst every care has been taken to prepare these particulars, they are for guidance purposes only. All measurements are approximate and for general guidance purposes only and whilst every care has been taken to ensure accuracy, they should not be relied upon and potential buyers/tenants are advised to recheck the measurements.

