



BYWATER HERRING

SALES & LETTINGS

- A TRADITION OF TRUST -



Lovell Court, Irthlingborough
Offers In The Region Of £125,000



Floor Plan

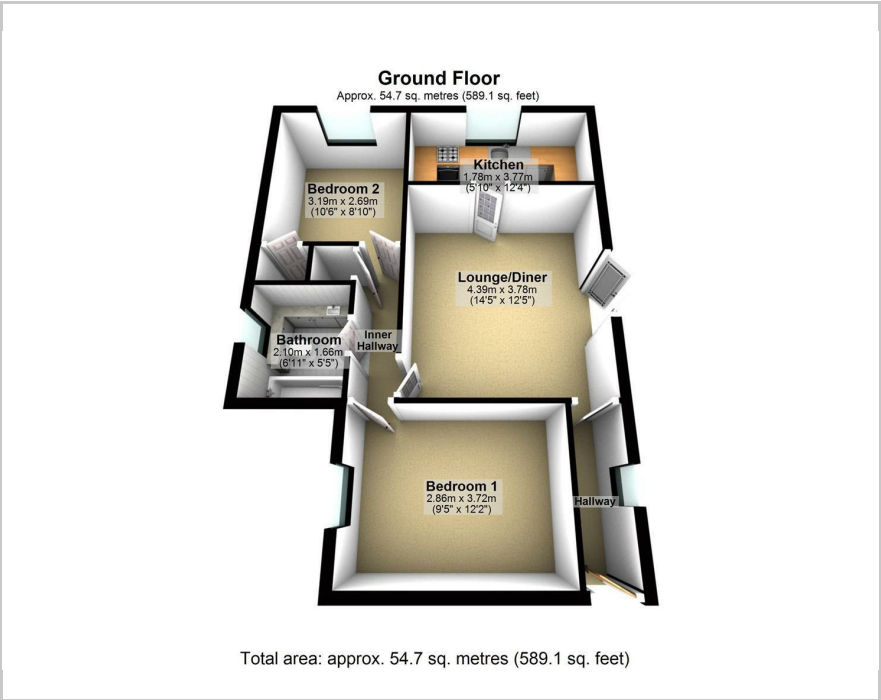

Area Map

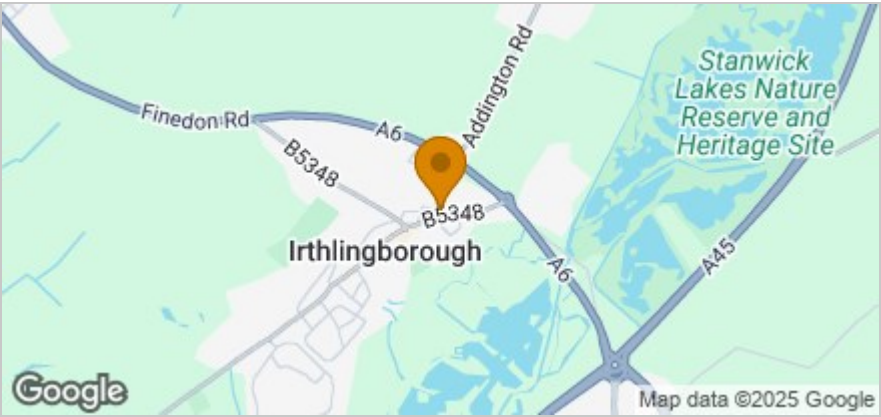

Accommodation

- Modern Ground Floor Flat
- Two Double Bedrooms
- Stylish Tiled Bathroom
- Electric Heating
- French Doors To Communal Garden
- Council Tax Band A
- One Allocated Parking Space
- Close To Major Roads
- Short Walk To The High Street
- Lovingly Cared For And Ready To Move Into

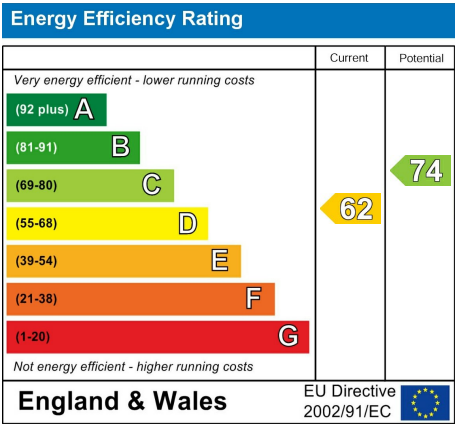

These particulars, whilst believed to be accurate are set out as a general outline only for guidance and do not constitute any part of an offer or contract. Intending purchasers should not rely on them as statements of representation of fact, but must satisfy themselves by inspection or otherwise as to their accuracy. No person in this firm's employment has the authority to make or give any representation or warranty in respect of the property.