



**BYWATER HERRING**

SALES & LETTINGS

- A TRADITION OF TRUST -



Oxford Street, Finedon

Offers Over £220,000





Floor Plan

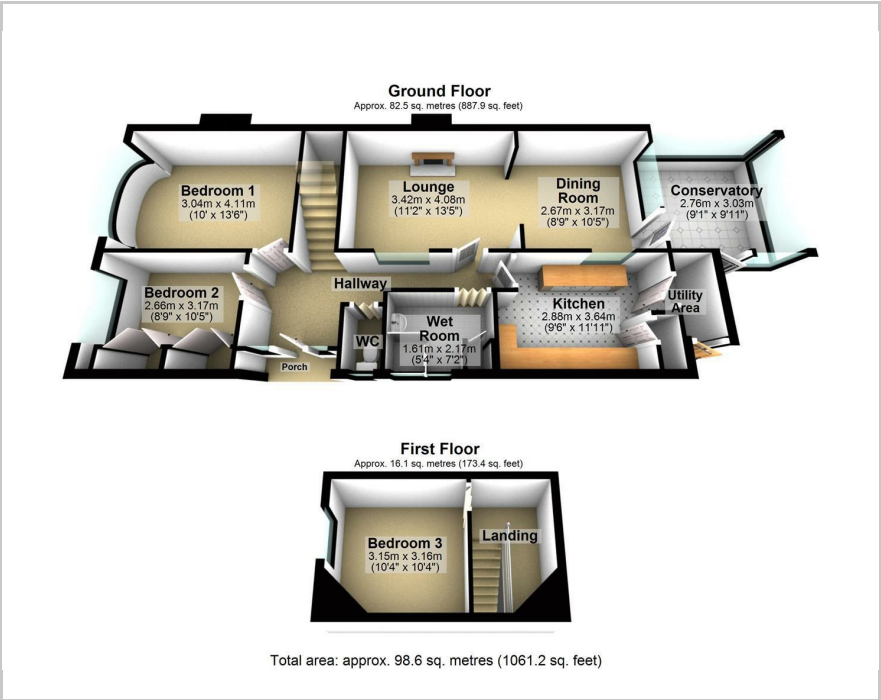

Area Map



Accommodation

- Semi-Detached Dormer Bungalow
- No Upward Chain
- Potential For Upgrade
- Corner Plot
- Bay-Fronted Window
- Off-Road Parking
- Three Bedrooms - Two Doubles
- Great Location for Town or Country Life
- Council Tax Band B
- Great Community Spirit

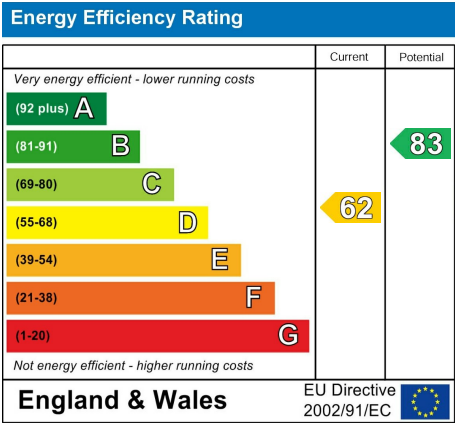
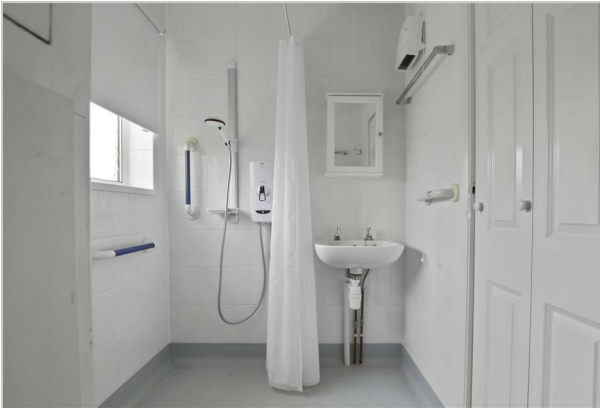

These particulars, whilst believed to be accurate are set out as a general outline only for guidance and do not constitute any part of an offer or contract. Intending purchasers should not rely on them as statements of representation of fact, but must satisfy themselves by inspection or otherwise as to their accuracy. No person in this firms employment has the authority to make or give any representation or warranty in respect of the property.