



312 Catalina House, Canter Way, London, E1 8QE

**£699,995**





## 312 Catalina House, Canter Way, London, E1 8QE

**£699,995**

Goodman's Fields development Leasehold spacious 1 bedroom flat, located on 3rd floor with 2 Balconies.

Approx. 559.94 sq ft (52.02 sq m) with walking distance from Aldgate station

Apartment comes with two balconies, comfort cooling and wood flooring, double bedroom with fitted wardrobes and kitchen with Siemens appliances.

Development offers on site leisure facilities include gym, swimming pool and private cinema room, 24 hour concierge etc.

Goodman's Fields is ideally situated only few minutes by walk from Aldgate underground station, in the heart of zone 1 with connections via the District, Circle, Metropolitan and Hammersmith & City Lines.

EPC: B



## Description



## Situation

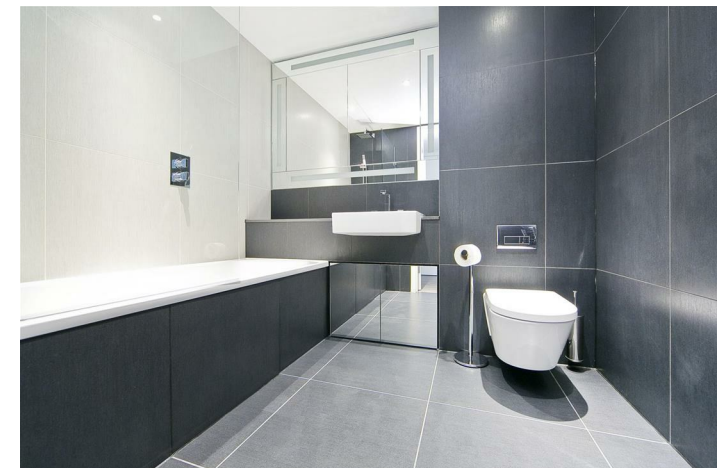
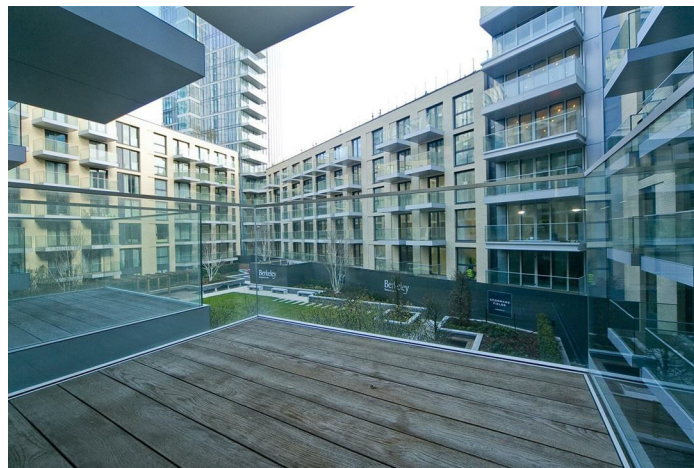

null

Council Tax Band:

Available:



## Floor Plans

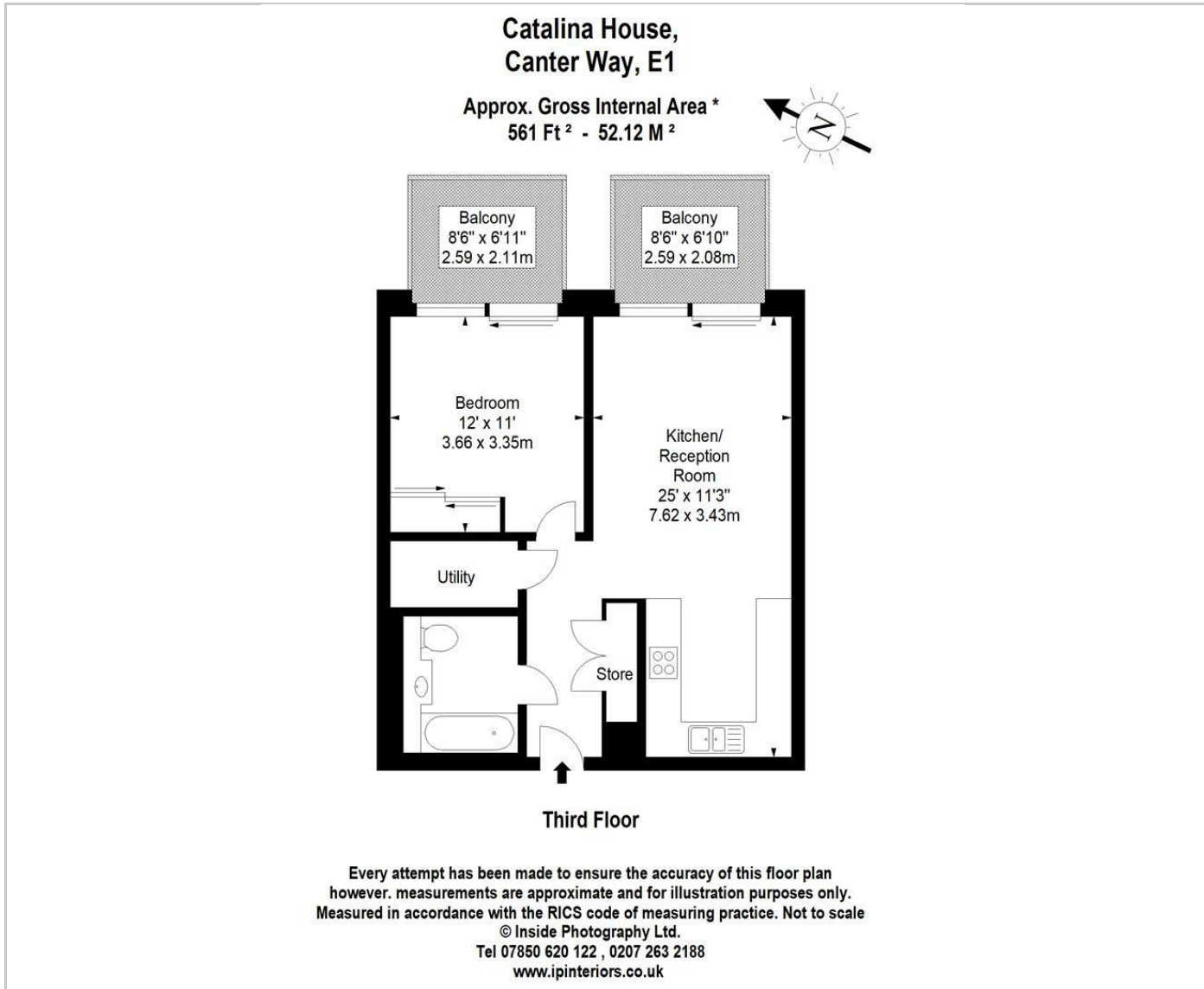

## Area Map

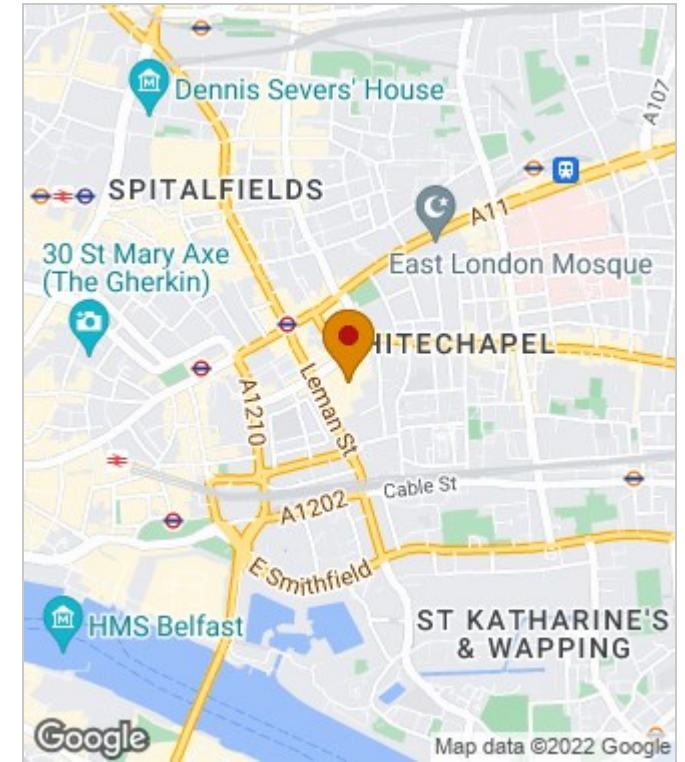

## Energy Performance Graph

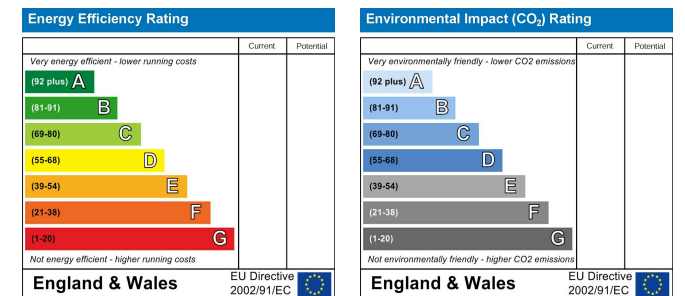

These particulars, whilst believed to be accurate are set out as a general outline only for guidance and do not constitute any part of an offer or contract. Intending purchasers should not rely on them as statements of representation of fact, but must satisfy themselves by inspection or otherwise as to their accuracy. No person in this firm's employment has the authority to make or give any representation or warranty in respect of the property.