



53, Discovery House Juniper Drive, London, SW18 1XY

£553 Per Week



53 Discovery House Juniper Drive, London, SW18 1XY

£553 Per Week

Lessel Residential Lettings present a one bedroom brand new fully furnished, luxury apartment in Discovery House; the last residential block available at Battersea Reach.

These contemporary homes have everything you need for a modern urban lifestyle with open plan living areas, floor to ceiling windows and large outside balconies overlooking an attractively designed courtyard.

The stylish kitchen comes with quality fixtures, fittings and ample storage space, the wood effect laminate flooring showcases a luxurious modern apartment for the working professional.

Battersea Reach is an established waterfront community where residents can enjoy convenient living in picturesque surroundings. An award winning development of 1,350 new homes within a vibrant neighbourhood with a 300 metre river walk and an array of on-site amenities including a Gymnasium, a Professional Business Suite and 24-hour Concierge.

Extensive gardens and further, new river walkways make the most of this appealing location, as do the cafes and restaurants that provide the perfect venues in which to relax and socialise by the water's edge.

There are easy transport links into Waterloo via Vauxhall train station and from Wandsworth Town station.

video upon request

Description

Situation



Furnished

Council Tax Band:

Available: 30th September 2025

Floor Plans

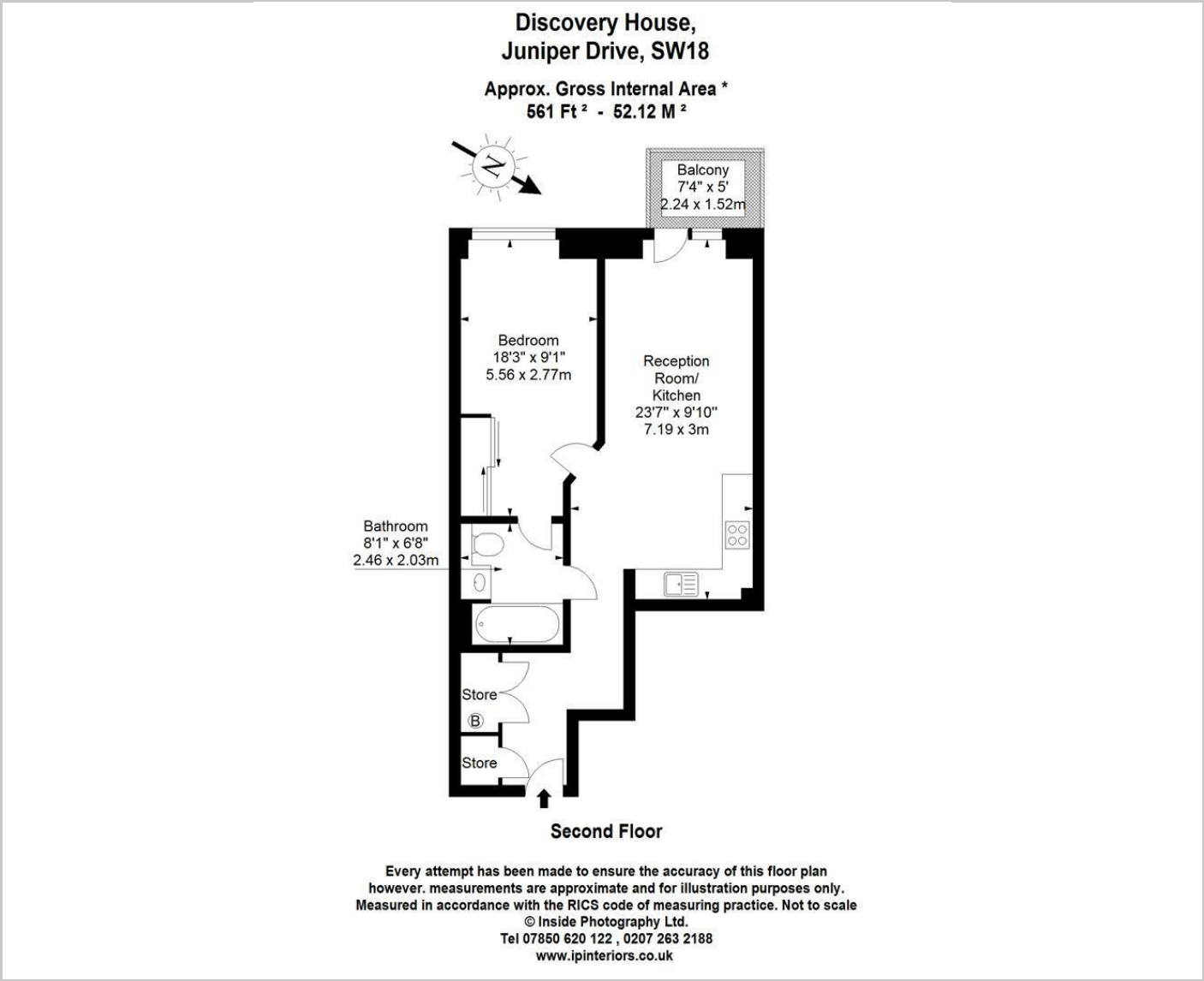

Area Map

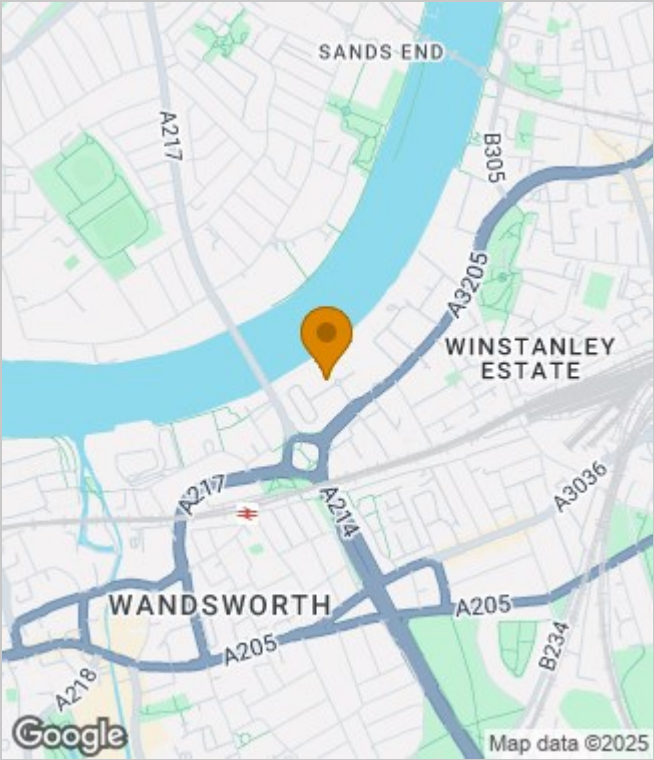

Energy Performance Graph

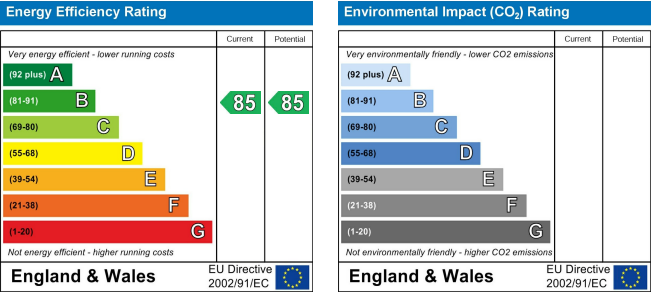

These particulars, whilst believed to be accurate are set out as a general outline only for guidance and do not constitute any part of an offer or contract. Intending purchasers should not rely on them as statements of representation of fact, but must satisfy themselves by inspection or otherwise as to their accuracy. No person in this firms employment has the authority to make or give any representation or warranty in respect of the property.