



B3.04.08 Joseph Ave, London, W36NL

£650,000





## B3.04.08 Joseph Ave, London, W36NL

**£650,000**

This is a beautifully designed 2-bedroom apartment at The Aster building, offering breathtaking views from its desirable south and east-facing position. The apartment boasts natural light streaming through its expansive windows, enhancing the warm and inviting atmosphere of the open-plan living spaces.

It's an off-plan unit, with completion expected in Q1 2026.

Located in the heart of Acton, West London, a vibrant area undergoing significant regeneration, this property is just a short walk from the Elizabeth Lind at Acton Main Lin Station. It offers unrivaled connectivity, with central London reachable in under 10 minutes.

The thoughtfully designed interiors feature timber-effect flooring throughout the living areas, complemented by luxurious soft carpets in the bedrooms. The kitchen is equipped with its sleek marble-effect composite worktops and integrated high-quality appliances, perfect for any culinary enthusiast.

Both bedrooms are generously sized. The master bedroom has built-in wardrobes providing ample storage space. The second bedroom offers flexibility, whether for guests, a home office, or a personal sanctuary. The bathrooms are finished with stylish herringbone tiles, adding a sophisticated touch.

## Description

## Situation

null

Council Tax Band:

Available:



Floor Plans

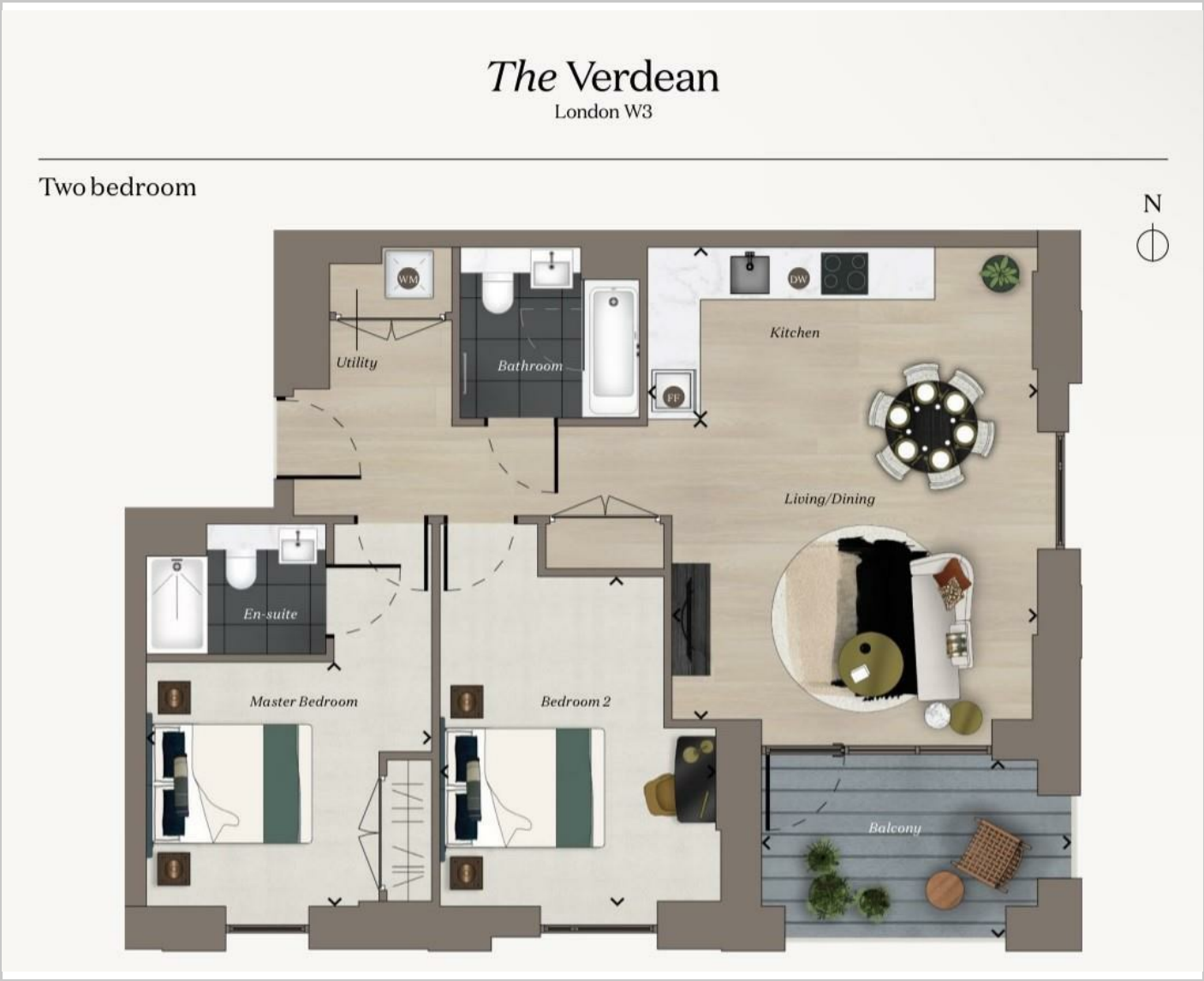

Area Map



Energy Performance Graph

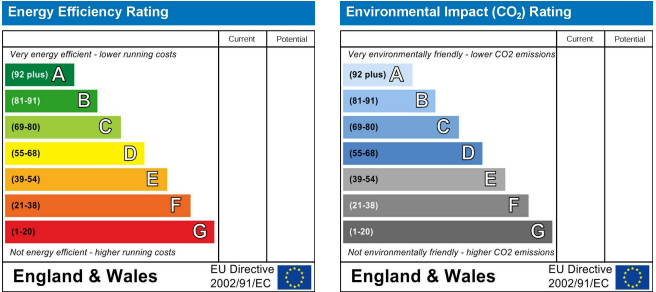

These particulars, whilst believed to be accurate are set out as a general outline only for guidance and do not constitute any part of an offer or contract. Intending purchasers should not rely on them as statements of representation of fact, but must satisfy themselves by inspection or otherwise as to their accuracy. No person in this firms employment has the authority to make or give any representation or warranty in respect of the property.