

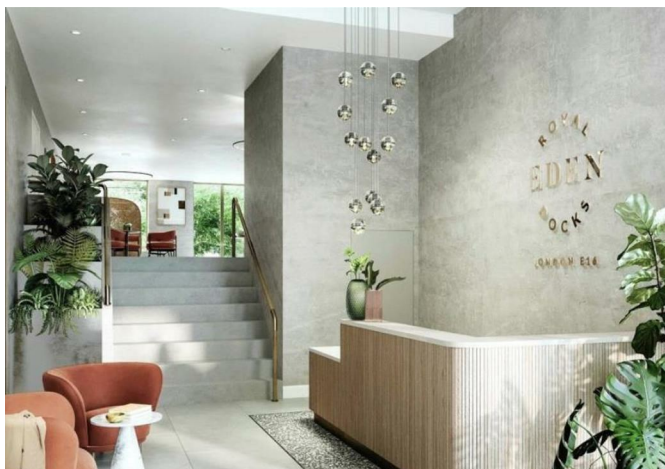

Apartment 1104, Galleria House 12B Western Gateway, London, E16 1DA

£630,000



## Apartment 1104, Galleria House 12B Western Gateway, London, E16 1DA

**£630,000**

\* Contract Reassignment, estimated completion date 2025 Q1Q2

Mount Anvil, a developer based in London, and ExCeL London are launching Royal Eden Docks, E16, a new community with 796 studio, one-bedroom, two-bedroom, and three-bedroom homes. Planned by worldwide famous modelers, SOM, these homes have been planned in view of prosperity.

This unit is situated on the 11th floor, this modern property boasts stunning views of the city skyline from its 88.2 sqft private balcony, perfect for enjoying your morning coffee or hosting evening gatherings.

As you step inside, you are greeted by a spacious apartment featuring 1 reception room, 2 bedrooms, and 2 bathrooms, providing ample space for comfortable living. The property offers a contemporary design with high-quality finishes throughout, creating a luxurious and inviting atmosphere.

One of the highlights of this apartment is its proximity to the Elizabeth Line, ensuring convenient access to transportation for your daily commute or weekend adventures. Additionally, residents can enjoy the tranquility of 5,000 sq m of landscaped green space, providing a peaceful retreat in the heart of the bustling city.

Description

Situation

null  
Council Tax Band:  
Available:



## Floor Plans



## Area Map

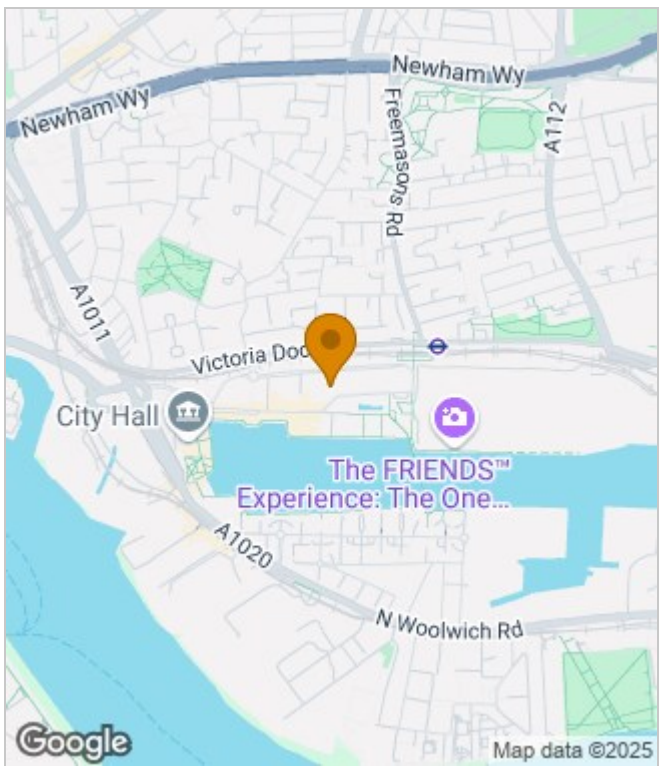

## Energy Performance Graph

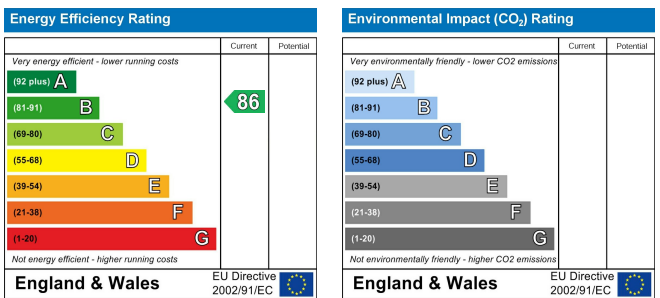

These particulars, whilst believed to be accurate are set out as a general outline only for guidance and do not constitute any part of an offer or contract. Intending purchasers should not rely on them as statements of representation of fact, but must satisfy themselves by inspection or otherwise as to their accuracy. No person in this firm's employment has the authority to make or give any representation or warranty in respect of the property.

3 Shortlands, Hammersmith, London, W6 8DA  
Tel: 020 8124 1073 Email: [management@lessel.co.uk](mailto:management@lessel.co.uk) <https://www.lessel.co.uk>